

KURRAJONG ESTATE - STAGE 6 LOT 601

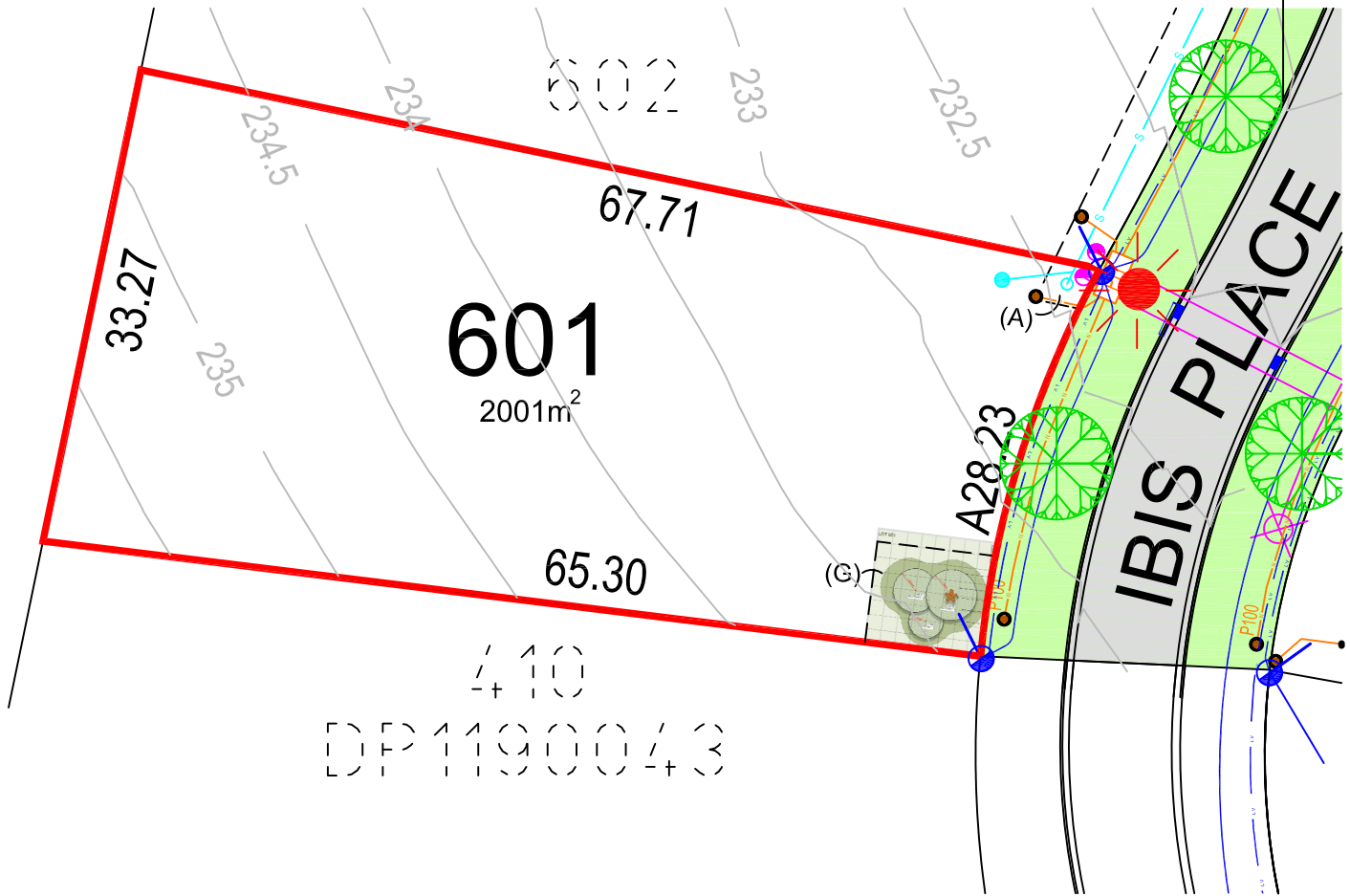

(A) EASEMENT TO DRAIN SEWAGE 3 WIDE, 4 WIDE AND VARIABLE WIDTH
(G) LANDSCAPING AND MAINTENANCE 7 WIDE & VARIABLE WIDTH

NOTE: ANTICIPATED LOT CLASSIFICATION IS E

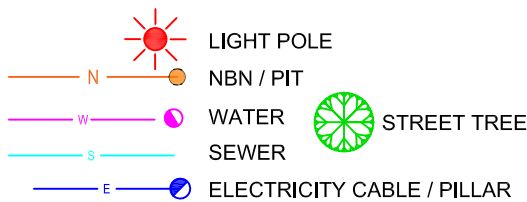

STAGE
6

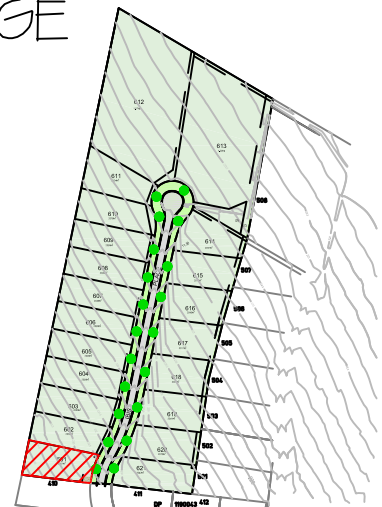

DISCLAIMER/NOTES:

1. Contours are based on finished design levels and are subject to construction and Council certification and therefore should not be considered as final or as-built.
2. Location of utility services including but not limited to power, water, sewer and communications are subject to construction and Supply Authority certification and therefore should not be considered as final or as-built.
3. Survey information such as boundary dimensions and areas, easements etc are subject to final survey. Purchasers should refer to the Deposited Plan and 88B Instrument contained in the Contract for Sale of Land for further detailed information.
4. Geotechnical classification are provided for convenience. Purchasers should refer to referenced detail specialists reports.
5. This Preliminary Site Analysis Plan has been collated from various sources of design information and is provided for convenience to assist Purchasers in obtaining quotations/tenders for dwelling construction.
6. This document does not form part of the Contract of Sale of the Land.

MM HYNDES BAILEY & Co.
REGISTERED SURVEYORS - TOWN PLANNING - CIVIL DESIGN
Surveying the Hunter since 1920



**KURRAJONG
FIELDS**
• SCONE •

KURRAJONG ESTATE - STAGE 6 LOT 602

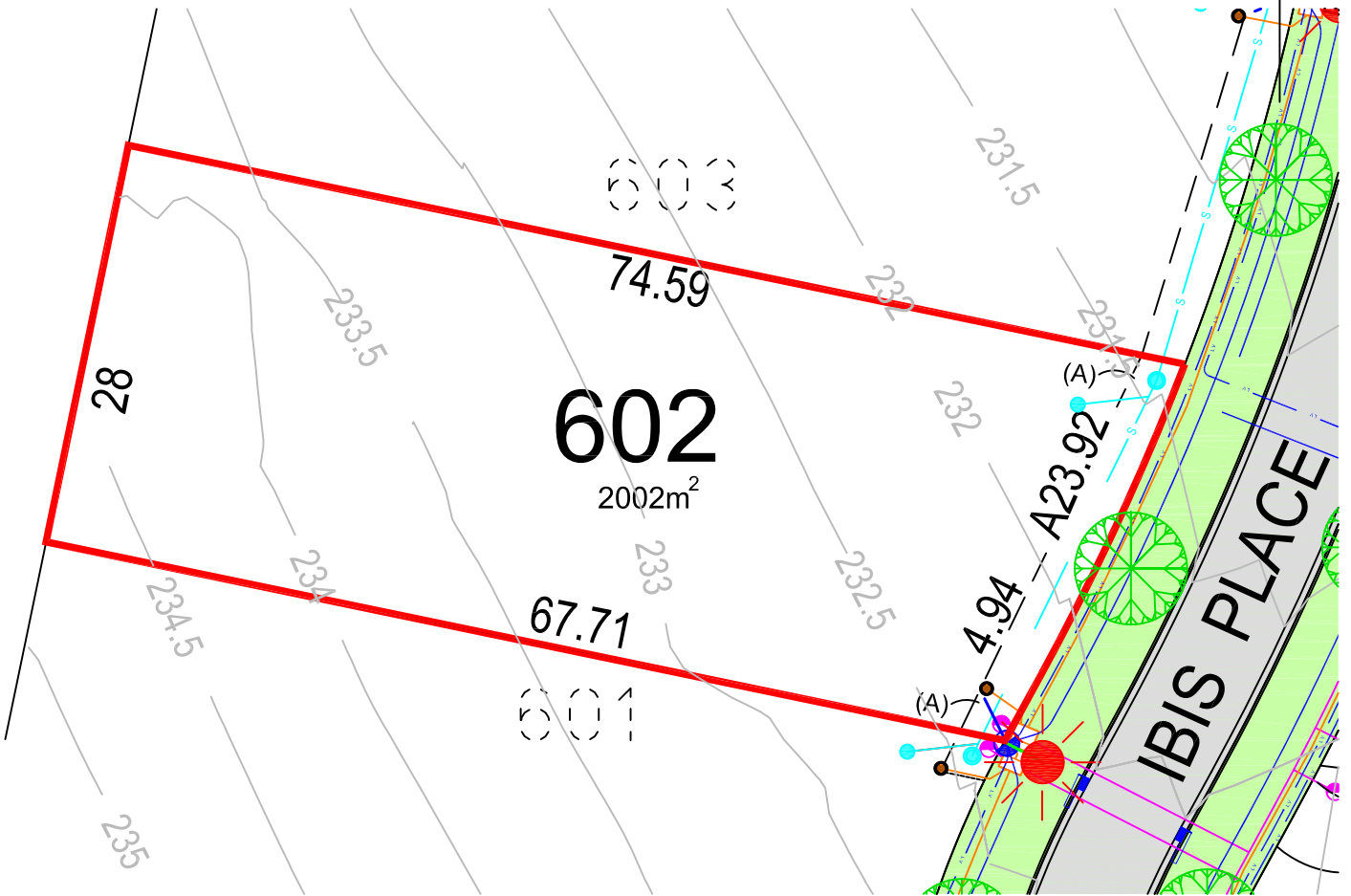

(A) EASEMENT TO DRAIN SEWAGE 3 WIDE, 4 WIDE AND VARIABLE WIDTH

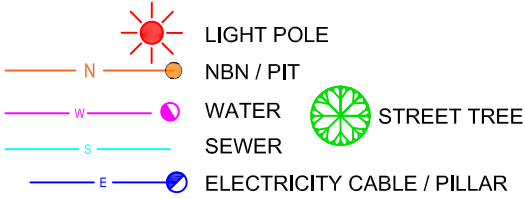

NOTE: ANTICIPATED LOT CLASSIFICATION IS E

DISCLAIMER/NOTES:

1. Contours are based on finished design levels and are subject to construction and Council certification and therefore should not be considered as final or as-built.
2. Location of utility services including but not limited to power, water, sewer and communications are subject to construction and Supply Authority certification and therefore should not be considered as final or as-built.
3. Survey information such as boundary dimensions and areas, easements etc are subject to final survey. Purchasers should refer to the Deposited Plan and 88B Instrument contained in the Contract for Sale of Land for further detailed information.
4. Geotechnical classification are provided for convenience. Purchasers should refer to referenced detail specialists reports.
5. This Preliminary Site Analysis Plan has been collated from various sources of design information and is provided for convenience to assist Purchasers in obtaining quotations/tenders for dwelling construction.
6. This document does not form part of the Contract of Sale of the Land.

STAGE
6

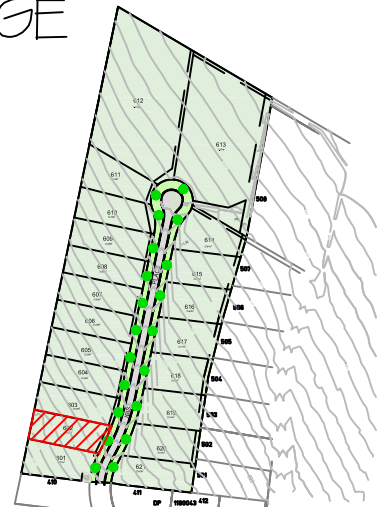

MM HYNDES BAILEY & Co.
REGISTERED SURVEYORS - TOWN PLANNING - CIVIL DESIGN
Surveying the Hunter since 1920



**KURRAJONG
FIELDS**
• S C O N F •

KURRAJONG ESTATE - STAGE 6 LOT 603

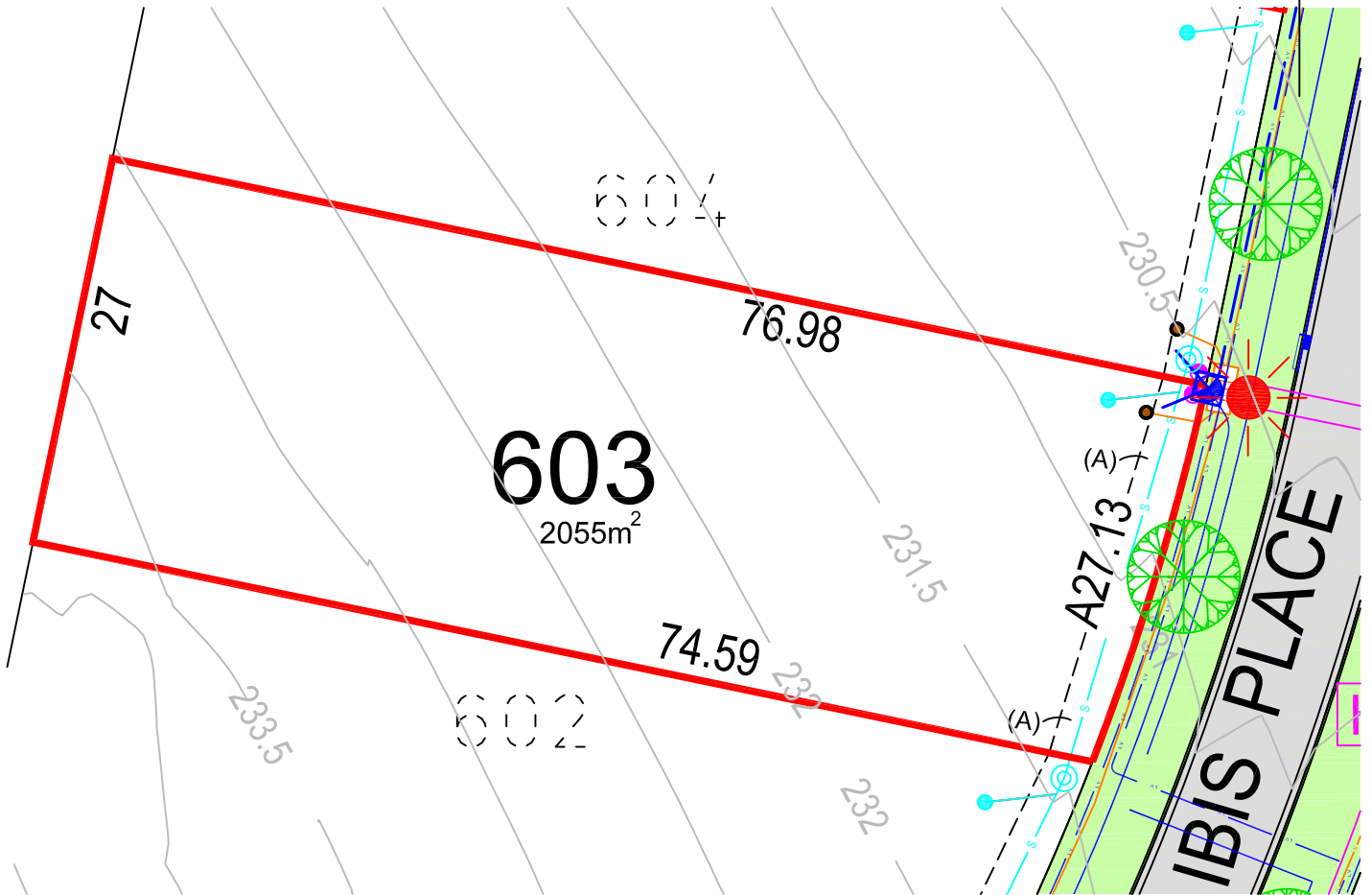

(A) EASEMENT TO DRAIN SEWAGE 3 WIDE, 4 WIDE AND VARIABLE WIDTH

	LIGHT POLE
	NBN / PIT
	WATER
	SEWER
	ELECTRICITY CABLE / PILLAR
	STREET TREE

NOTE: ANTICIPATED LOT CLASSIFICATION IS E

DISCLAIMER/NOTES:

1. Contours are based on finished design levels and are subject to construction and Council certification and therefore should not be considered as final or as-built.
2. Location of utility services including but not limited to power, water, sewer and communications are subject to construction and Supply Authority certification and therefore should not be considered as final or as-built.
3. Survey information such as boundary dimensions and areas, easements etc are subject to final survey. Purchasers should refer to the Deposited Plan and 88B Instrument contained in the Contract for Sale of Land for further detailed information.
4. Geotechnical classification are provided for convenience. Purchasers should refer to referenced detail specialists reports.
5. This Preliminary Site Analysis Plan has been collated from various sources of design information and is provided for convenience to assist Purchasers in obtaining quotations/tenders for dwelling construction.
6. This document does not form part of the Contract of Sale of the Land.

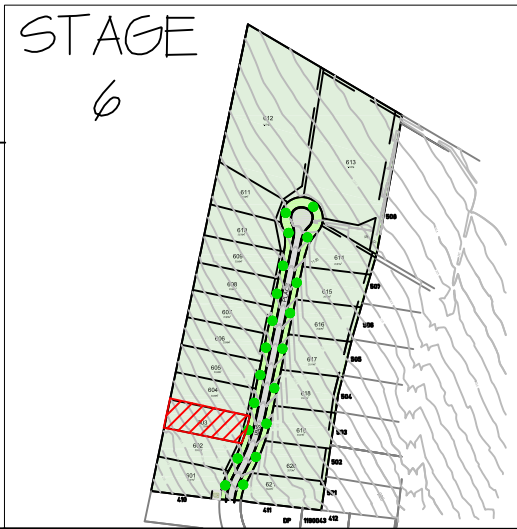

MM HYNDES BAILEY & Co.
REGISTERED SURVEYORS - TOWN PLANNING - CIVIL DESIGN
Surveying the Hunter since 1920



**KURRAJONG
FIELDS**
• SCONE •

KURRAJONG ESTATE - STAGE 6 LOT 604

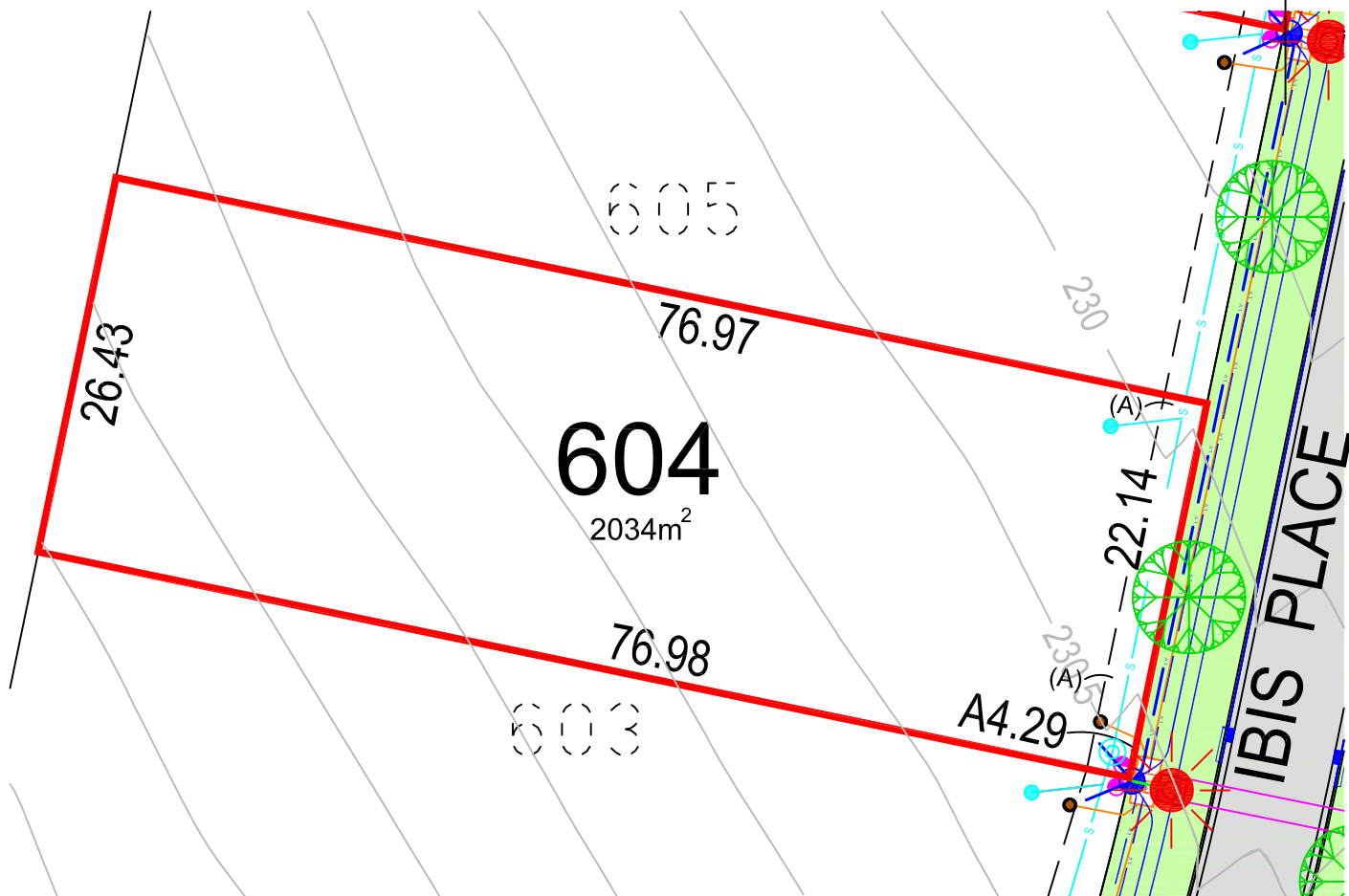

(A) EASEMENT TO DRAIN SEWAGE 3 WIDE, 4 WIDE AND VARIABLE WIDTH

NOTE: ANTICIPATED LOT CLASSIFICATION IS E

	LIGHT POLE
	NBN / PIT
	WATER
	SEWER
	ELECTRICITY CABLE / PILLAR
	STREET TREE

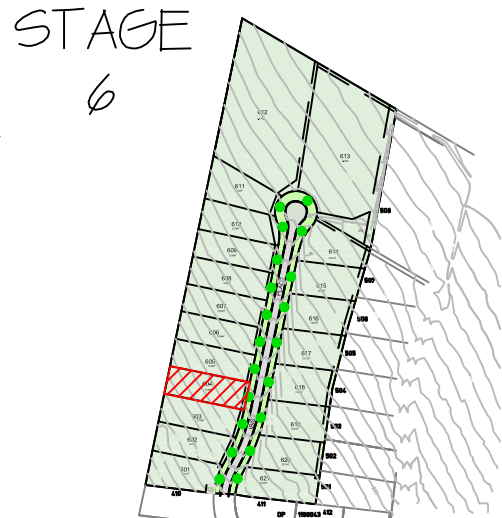

DISCLAIMER/NOTES:

1. Contours are based on finished design levels and are subject to construction and Council certification and therefore should not be considered as final or as-built.
2. Location of utility services including but not limited to power, water, sewer and communications are subject to construction and Supply Authority certification and therefore should not be considered as final or as-built.
3. Survey information such as boundary dimensions and areas, easements etc are subject to final survey. Purchasers should refer to the Deposited Plan and 88B Instrument contained in the Contract for Sale of Land for further detailed information.
4. Geotechnical classification are provided for convenience. Purchasers should refer to referenced detail specialists reports.
5. This Preliminary Site Analysis Plan has been collated from various sources of design information and is provided for convenience to assist Purchasers in obtaining quotations/tenders for dwelling construction.
6. This document does not form part of the Contract of Sale of the Land.

MM HYNDES BAILEY & Co.
REGISTERED SURVEYORS - TOWN PLANNING - CIVIL DESIGN
Surveying the Hunter since 1920



**KURRAJONG
FIELDS**
• SCONE •

KURRAJONG ESTATE - STAGE 6

LOT 605

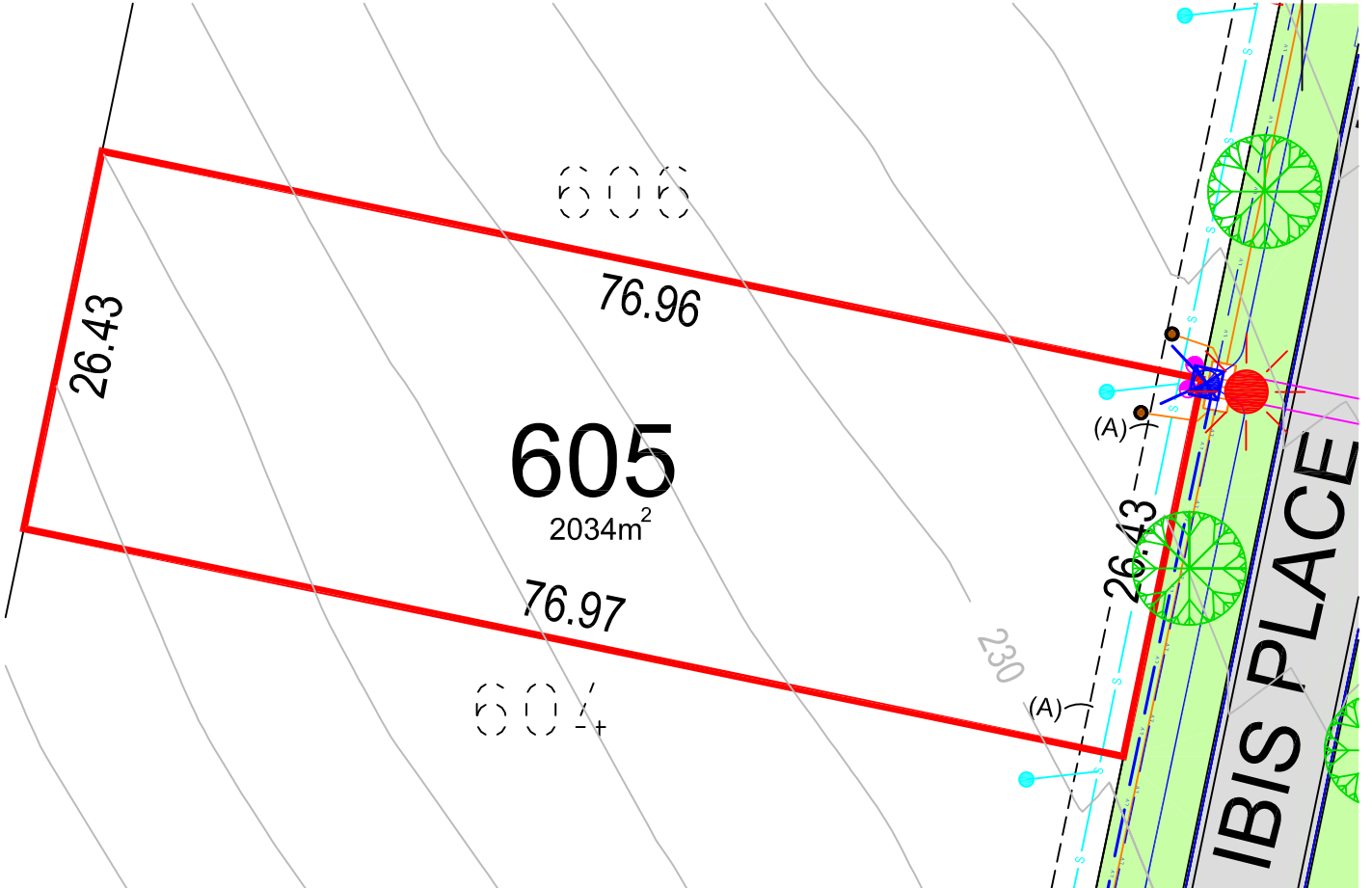

(A) EASEMENT TO DRAIN SEWAGE 3 WIDE, 4 WIDE AND VARIABLE WIDTH

NOTE: ANTICIPATED LOT CLASSIFICATION IS E

	LIGHT POLE
	NBN / PIT
	WATER
	SEWER
	ELECTRICITY CABLE / PILLAR
	STREET TREE

STAGE
6

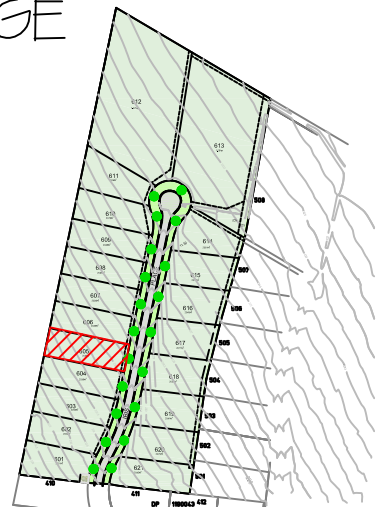

DISCLAIMER/NOTES:

1. Contours are based on finished design levels and are subject to construction and Council certification and therefore should not be considered as final or as-built.
2. Location of utility services including but not limited to power, water, sewer and communications are subject to construction and Supply Authority certification and therefore should not be considered as final or as-built.
3. Survey information such as boundary dimensions and areas, easements etc are subject to final survey. Purchasers should refer to the Deposited Plan and 88B Instrument contained in the Contract for Sale of Land for further detailed information.
4. Geotechnical classification are provided for convenience. Purchasers should refer to referenced detail specialists reports.
5. This Preliminary Site Analysis Plan has been collated from various sources of design information and is provided for convenience to assist Purchasers in obtaining quotations/tenders for dwelling construction.
6. This document does not form part of the Contract of Sale of the Land.

MM HYNDES BAILEY & Co.
 REGISTERED SURVEYORS - TOWN PLANNING - CIVIL DESIGN
Surveying the Hunter since 1920



**KURRAJONG
 FIELDS**
 • S C O N F •

KURRAJONG ESTATE - STAGE 6

LOT 606

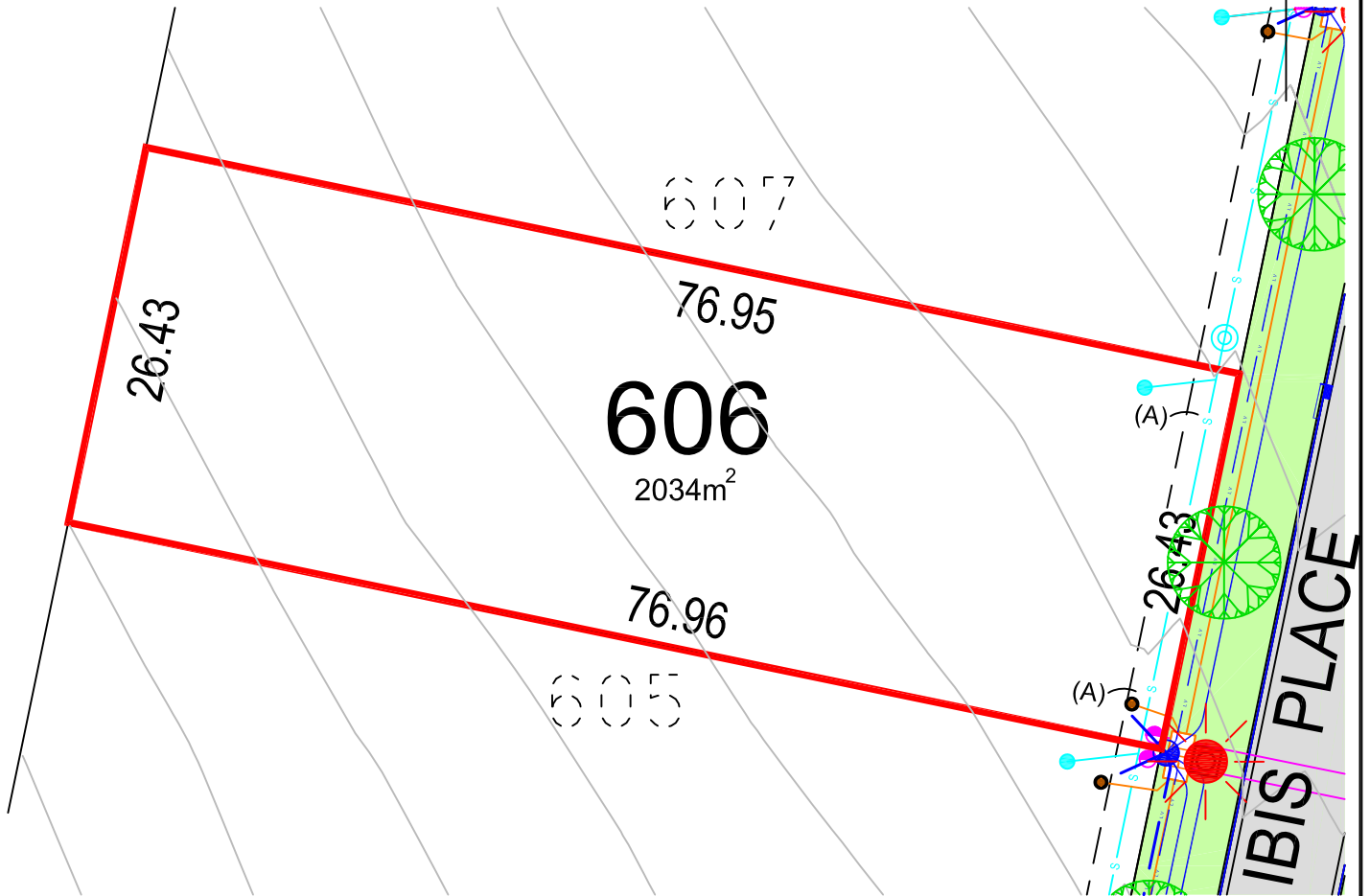

(A) EASEMENT TO DRAIN SEWAGE 3 WIDE, 4 WIDE AND VARIABLE WIDTH

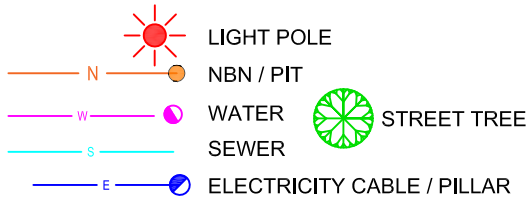

NOTE: ANTICIPATED LOT CLASSIFICATION IS E

DISCLAIMER/NOTES:

1. Contours are based on finished design levels and are subject to construction and Council certification and therefore should not be considered as final or as-built.
2. Location of utility services including but not limited to power, water, sewer and communications are subject to construction and Supply Authority certification and therefore should not be considered as final or as-built.
3. Survey information such as boundary dimensions and areas, easements etc are subject to final survey. Purchasers should refer to the Deposited Plan and 88B Instrument contained in the Contract for Sale of Land for further detailed information.
4. Geotechnical classification are provided for convenience. Purchasers should refer to referenced detail specialists reports.
5. This Preliminary Site Analysis Plan has been collated from various sources of design information and is provided for convenience to assist Purchasers in obtaining quotations/tenders for dwelling construction.
6. This document does not form part of the Contract of Sale of the Land.

STAGE
6

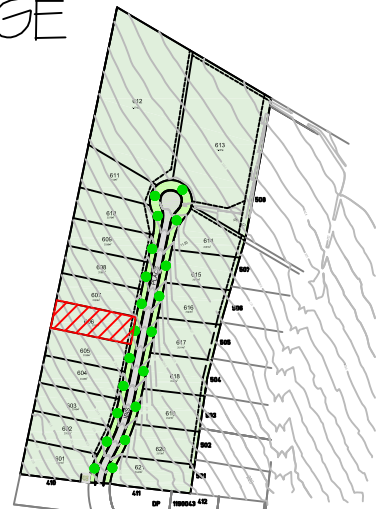

MM HYNDES BAILEY & Co.
REGISTERED SURVEYORS - TOWN PLANNING - CIVIL DESIGN
Surveying the Hunter since 1920



**KURRAJONG
FIELDS**
• S C O N F •

KURRAJONG ESTATE - STAGE 6 LOT 607

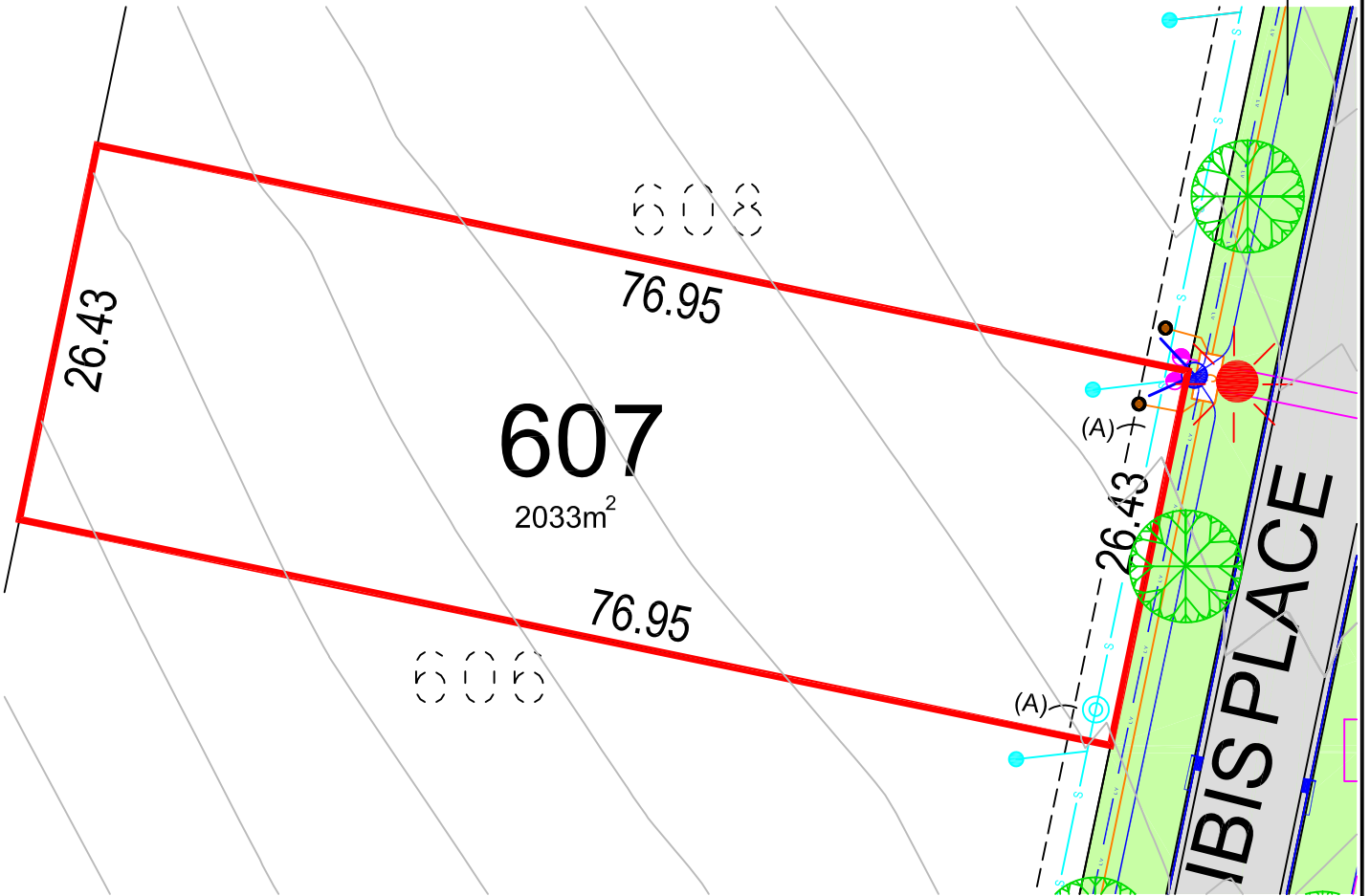

(A) EASEMENT TO DRAIN SEWAGE 3 WIDE, 4 WIDE AND VARIABLE WIDTH

NOTE: ANTICIPATED LOT CLASSIFICATION IS E

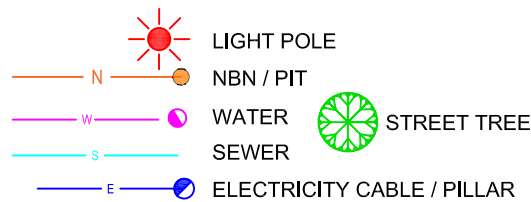

STAGE
6

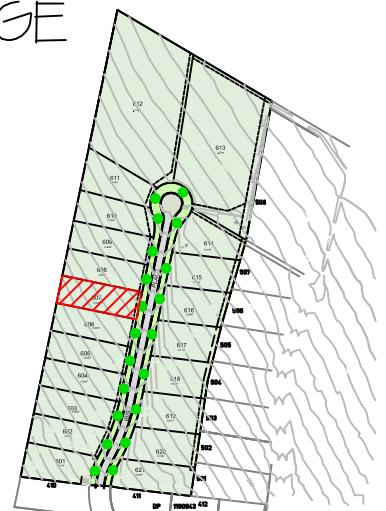

DISCLAIMER/NOTES:

1. Contours are based on finished design levels and are subject to construction and Council certification and therefore should not be considered as final or as-built.
2. Location of utility services including but not limited to power, water, sewer and communications are subject to construction and Supply Authority certification and therefore should not be considered as final or as-built.
3. Survey information such as boundary dimensions and areas, easements etc are subject to final survey. Purchasers should refer to the Deposited Plan and 88B Instrument contained in the Contract for Sale of Land for further detailed information.
4. Geotechnical classification are provided for convenience. Purchasers should refer to referenced detail specialists reports.
5. This Preliminary Site Analysis Plan has been collated from various sources of design information and is provided for convenience to assist Purchasers in obtaining quotations/tenders for dwelling construction.
6. This document does not form part of the Contract of Sale of the Land.

MM HYNDES BAILEY & Co.
REGISTERED SURVEYORS - TOWN PLANNING - CIVIL DESIGN
Surveying the Hunter since 1920



**KURRAJONG
FIELDS**
• S C O N F •

KURRAJONG ESTATE - STAGE 6 LOT 608

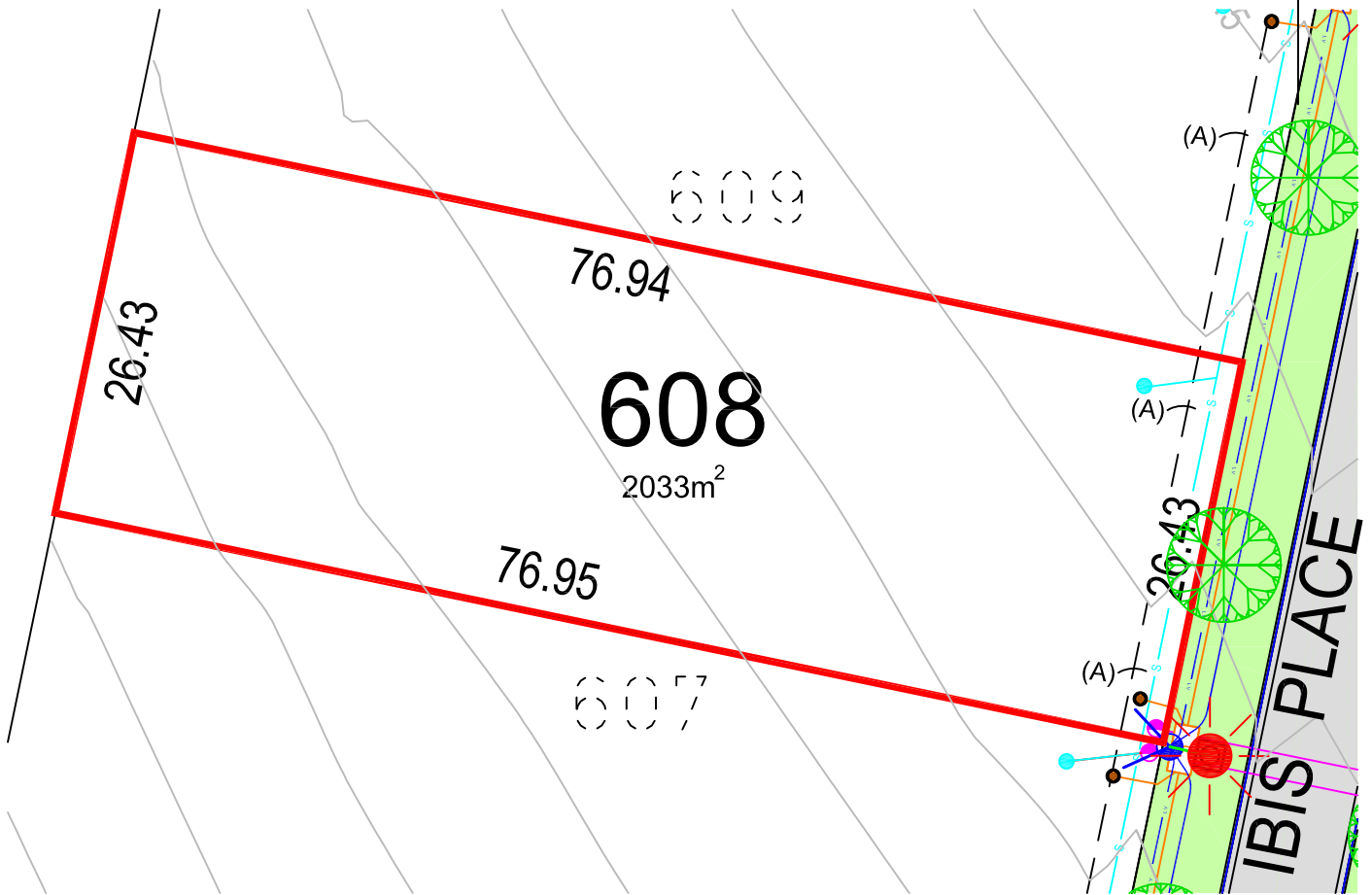

(A) EASEMENT TO DRAIN SEWAGE 3 WIDE, 4 WIDE AND VARIABLE WIDTH

NOTE: ANTICIPATED LOT CLASSIFICATION IS E

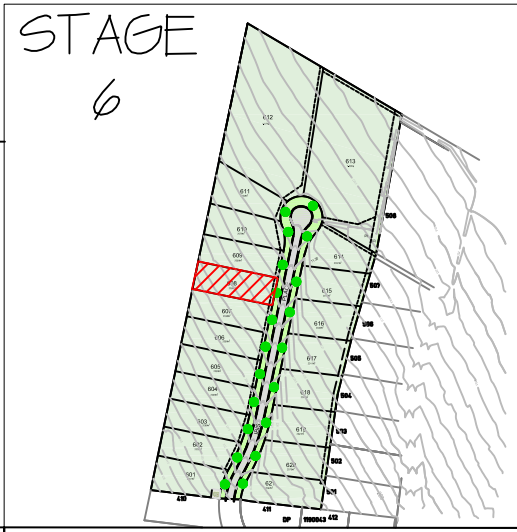
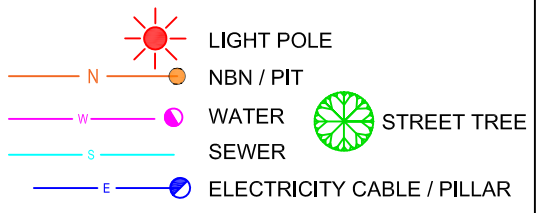

DISCLAIMER/NOTES:

1. Contours are based on finished design levels and are subject to construction and Council certification and therefore should not be considered as final or as-built.
2. Location of utility services including but not limited to power, water, sewer and communications are subject to construction and Supply Authority certification and therefore should not be considered as final or as-built.
3. Survey information such as boundary dimensions and areas, easements etc are subject to final survey. Purchasers should refer to the Deposited Plan and 88B Instrument contained in the Contract for Sale of Land for further detailed information.
4. Geotechnical classification are provided for convenience. Purchasers should refer to referenced detail specialists reports.
5. This Preliminary Site Analysis Plan has been collated from various sources of design information and is provided for convenience to assist Purchasers in obtaining quotations/tenders for dwelling construction.
6. This document does not form part of the Contract of Sale of the Land.

MM HYNDES BAILEY & Co.
REGISTERED SURVEYORS - TOWN PLANNING - CIVIL DESIGN
Surveying the Hunter since 1920



**KURRAJONG
FIELDS**
• SCONE •

KURRAJONG ESTATE - STAGE 6 LOT 609

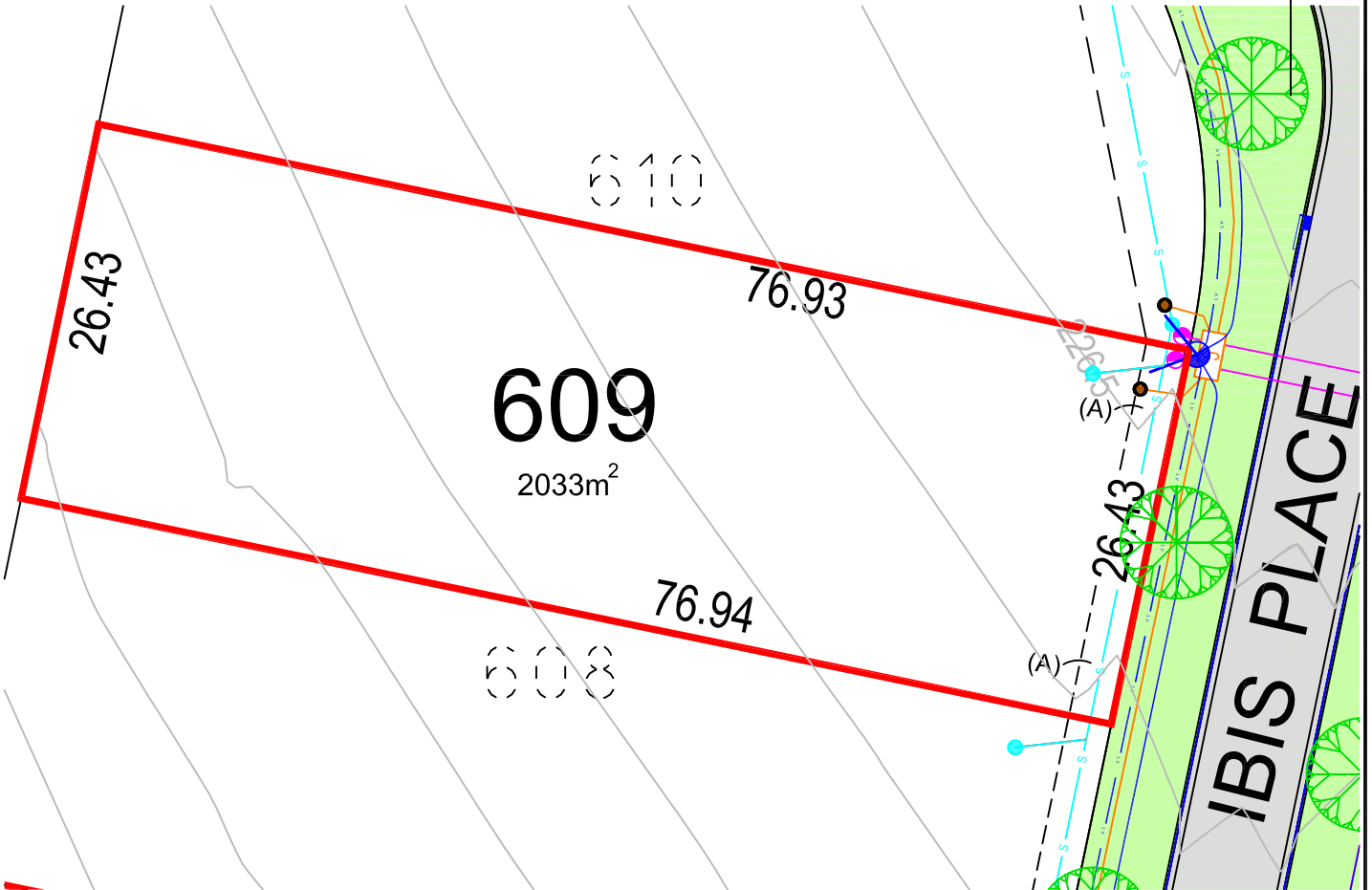

(A) EASEMENT TO DRAIN SEWAGE 3 WIDE, 4 WIDE AND VARIABLE WIDTH

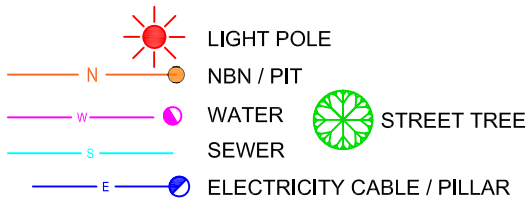

NOTE: ANTICIPATED LOT CLASSIFICATION IS E

DISCLAIMER/NOTES:

1. Contours are based on finished design levels and are subject to construction and Council certification and therefore should not be considered as final or as-built.
2. Location of utility services including but not limited to power, water, sewer and communications are subject to construction and Supply Authority certification and therefore should not be considered as final or as-built.
3. Survey information such as boundary dimensions and areas, easements etc are subject to final survey. Purchasers should refer to the Deposited Plan and 88B Instrument contained in the Contract for Sale of Land for further detailed information.
4. Geotechnical classification are provided for convenience. Purchasers should refer to referenced detail specialists reports.
5. This Preliminary Site Analysis Plan has been collated from various sources of design information and is provided for convenience to assist Purchasers in obtaining quotations/tenders for dwelling construction.
6. This document does not form part of the Contract of Sale of the Land.

STAGE
6

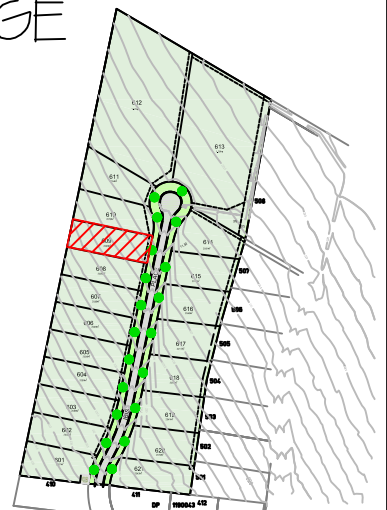

MM HYNDES BAILEY & Co.
REGISTERED SURVEYORS - TOWN PLANNING - CIVIL DESIGN
Surveying the Hunter since 1920



**KURRAJONG
FIELDS**
• S C O N F •

KURRAJONG ESTATE - STAGE 6 LOT 610

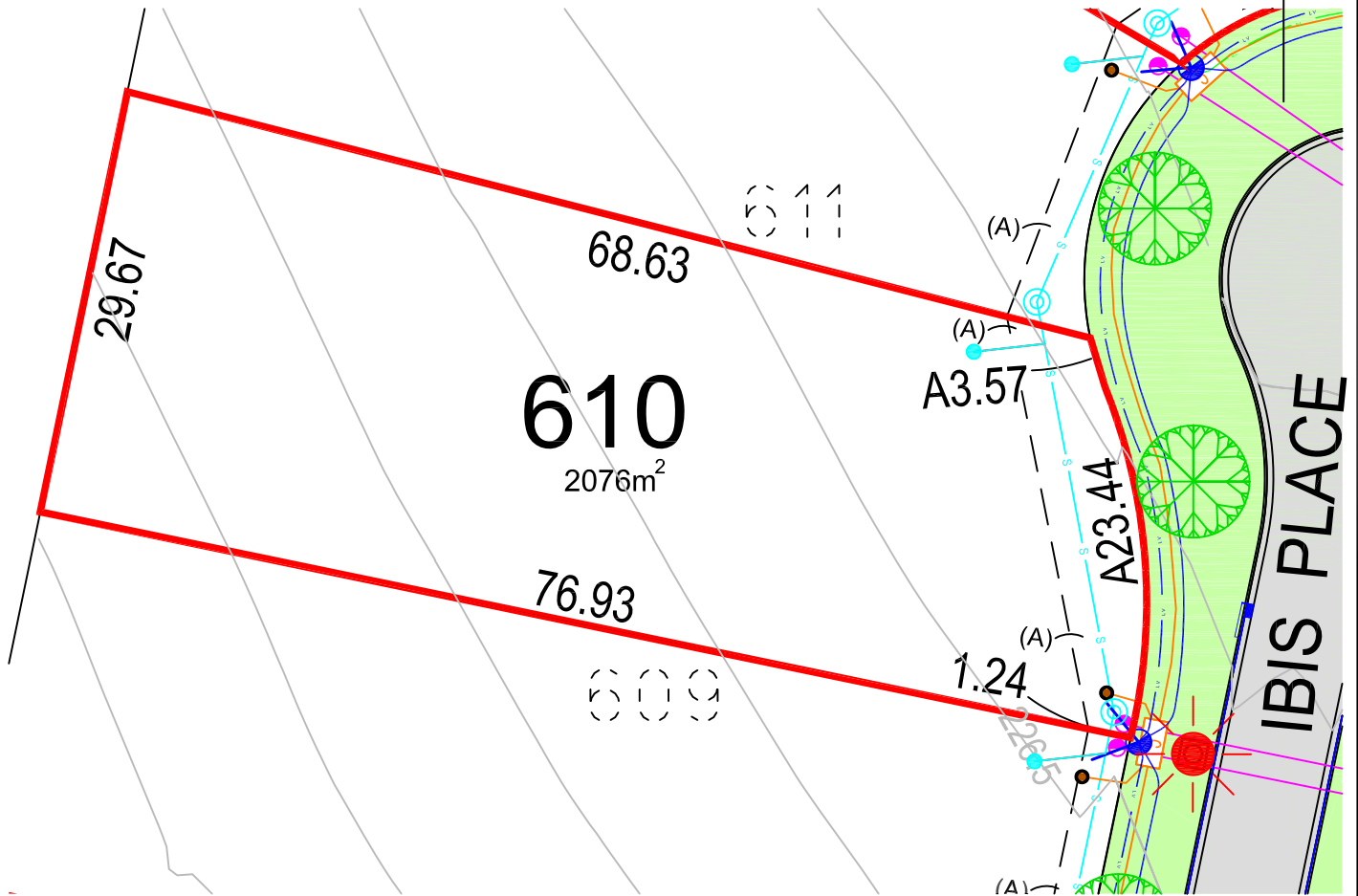

(A) EASEMENT TO DRAIN SEWAGE 3 WIDE, 4 WIDE AND VARIABLE WIDTH

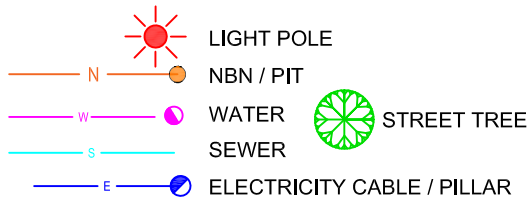

NOTE: ANTICIPATED LOT CLASSIFICATION IS E

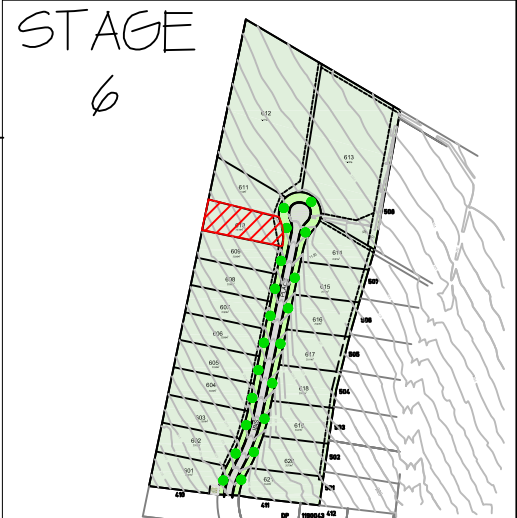

DISCLAIMER/NOTES:

1. Contours are based on finished design levels and are subject to construction and Council certification and therefore should not be considered as final or as-built.
2. Location of utility services including but not limited to power, water, sewer and communications are subject to construction and Supply Authority certification and therefore should not be considered as final or as-built.
3. Survey information such as boundary dimensions and areas, easements etc are subject to final survey. Purchasers should refer to the Deposited Plan and 88B Instrument contained in the Contract for Sale of Land for further detailed information.
4. Geotechnical classification are provided for convenience. Purchasers should refer to referenced detail specialists reports.
5. This Preliminary Site Analysis Plan has been collated from various sources of design information and is provided for convenience to assist Purchasers in obtaining quotations/tenders for dwelling construction.
6. This document does not form part of the Contract of Sale of the Land.

MM HYNDES BAILEY & Co.
REGISTERED SURVEYORS - TOWN PLANNING - CIVIL DESIGN
Surveying the Hunter since 1920



**KURRAJONG
FIELDS**
• SCONE •

KURRAJONG ESTATE - STAGE 6 LOT 611

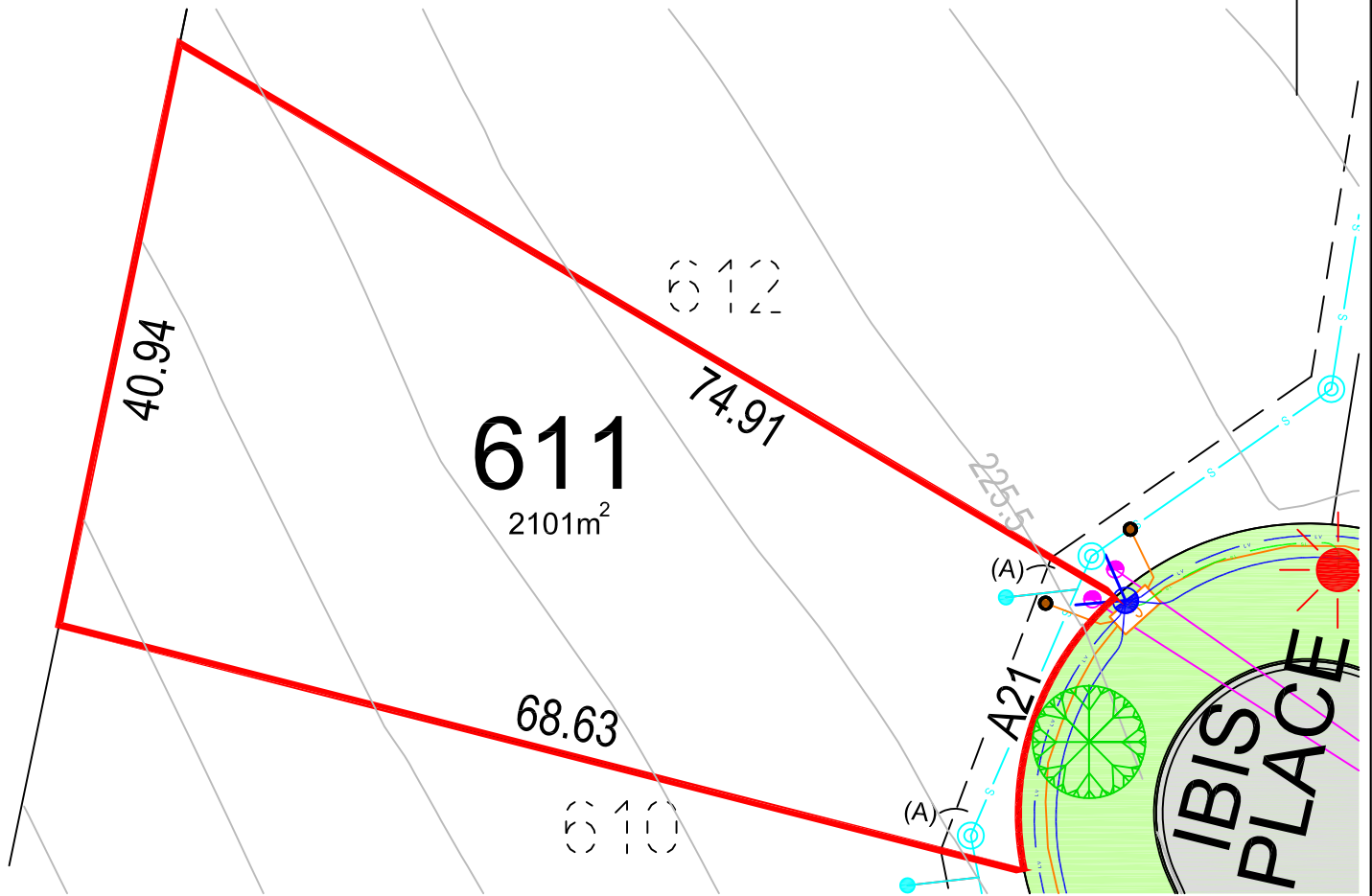

(A) EASEMENT TO DRAIN SEWAGE 3 WIDE, 4 WIDE AND VARIABLE WIDTH

NOTE: ANTICIPATED LOT CLASSIFICATION IS E

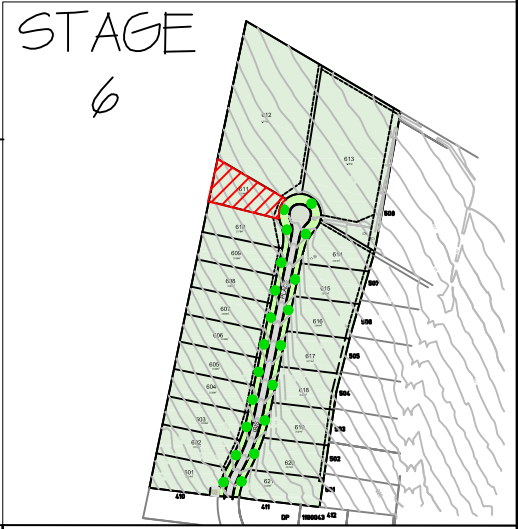
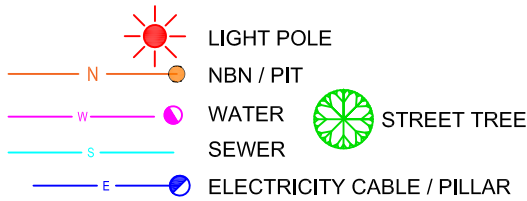

DISCLAIMER/NOTES:

1. Contours are based on finished design levels and are subject to construction and Council certification and therefore should not be considered as final or as-built.
2. Location of utility services including but not limited to power, water, sewer and communications are subject to construction and Supply Authority certification and therefore should not be considered as final or as-built.
3. Survey information such as boundary dimensions and areas, easements etc are subject to final survey. Purchasers should refer to the Deposited Plan and 88B Instrument contained in the Contract for Sale of Land for further detailed information.
4. Geotechnical classification are provided for convenience. Purchasers should refer to referenced detail specialists reports.
5. This Preliminary Site Analysis Plan has been collated from various sources of design information and is provided for convenience to assist Purchasers in obtaining quotations/tenders for dwelling construction.
6. This document does not form part of the Contract of Sale of the Land.

MM HYNDES BAILEY & Co.
REGISTERED SURVEYORS - TOWN PLANNING - CIVIL DESIGN
Surveying the Hunter since 1920



**KURRAJONG
FIELDS**
• S C O N F •

KURRAJONG ESTATE STAGE 6

LOT 6/2

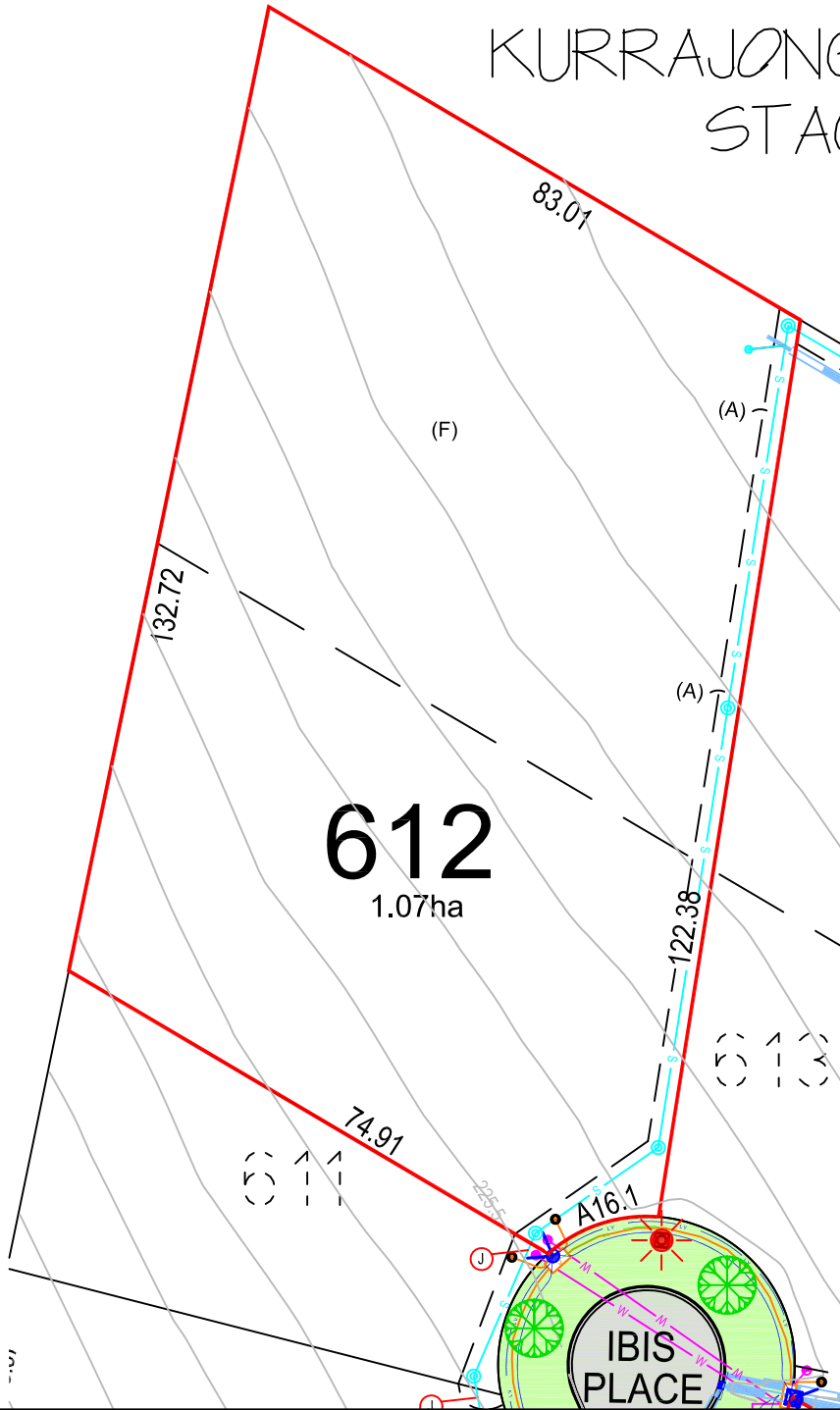
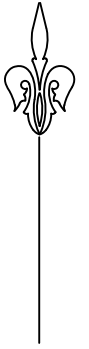

(A) EASEMENT TO DRAIN SEWAGE 3 WIDE, 4 WIDE AND VARIABLE WIDTH

(F) RESTRICTION ON THE USE OF LAND

NOTE: ANTICIPATED LOT CLASSIFICATION IS E

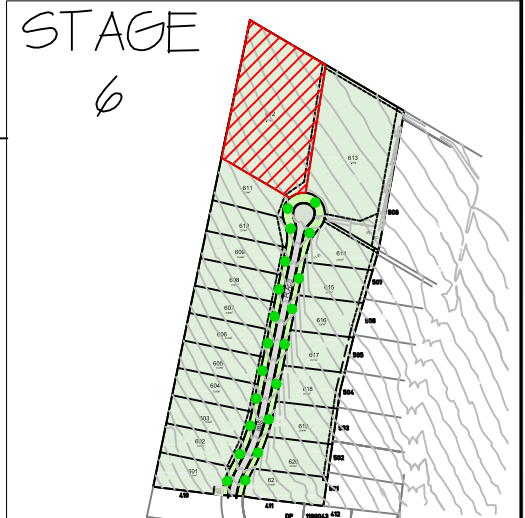
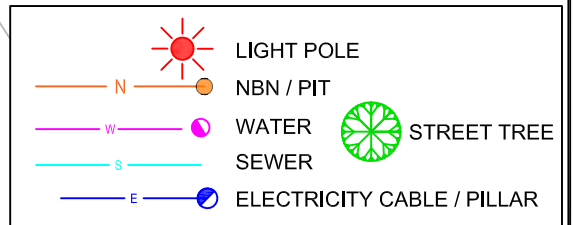

DISCLAIMER/NOTES:

1. Contours are based on finished design levels and are subject to construction and Council certification and therefore should not be considered as final or as-built.
2. Location of utility services including but not limited to power, water, sewer and communications are subject to construction and Supply Authority certification and therefore should not be considered as final or as-built.
3. Survey information such as boundary dimensions and areas, easements etc are subject to final survey. Purchasers should refer to the Deposited Plan and 88B Instrument contained in the Contract for Sale of Land for further detailed information.
4. Geotechnical classification are provided for convenience. Purchasers should refer to referenced detail specialists reports.
5. This Preliminary Site Analysis Plan has been collated from various sources of design information and is provided for convenience to assist Purchasers in obtaining quotations/tenders for dwelling construction.
6. This document does not form part of the Contract of Sale of the Land.

MM HYNDES BAILEY & Co.
REGISTERED SURVEYORS - TOWN PLANNING - CIVIL DESIGN
Surveying the Hunter since 1920



**KURRAJONG
FIELDS**
• S C O N F •

KURRAJONG ESTATE - STAGE 6 LOT 6/3

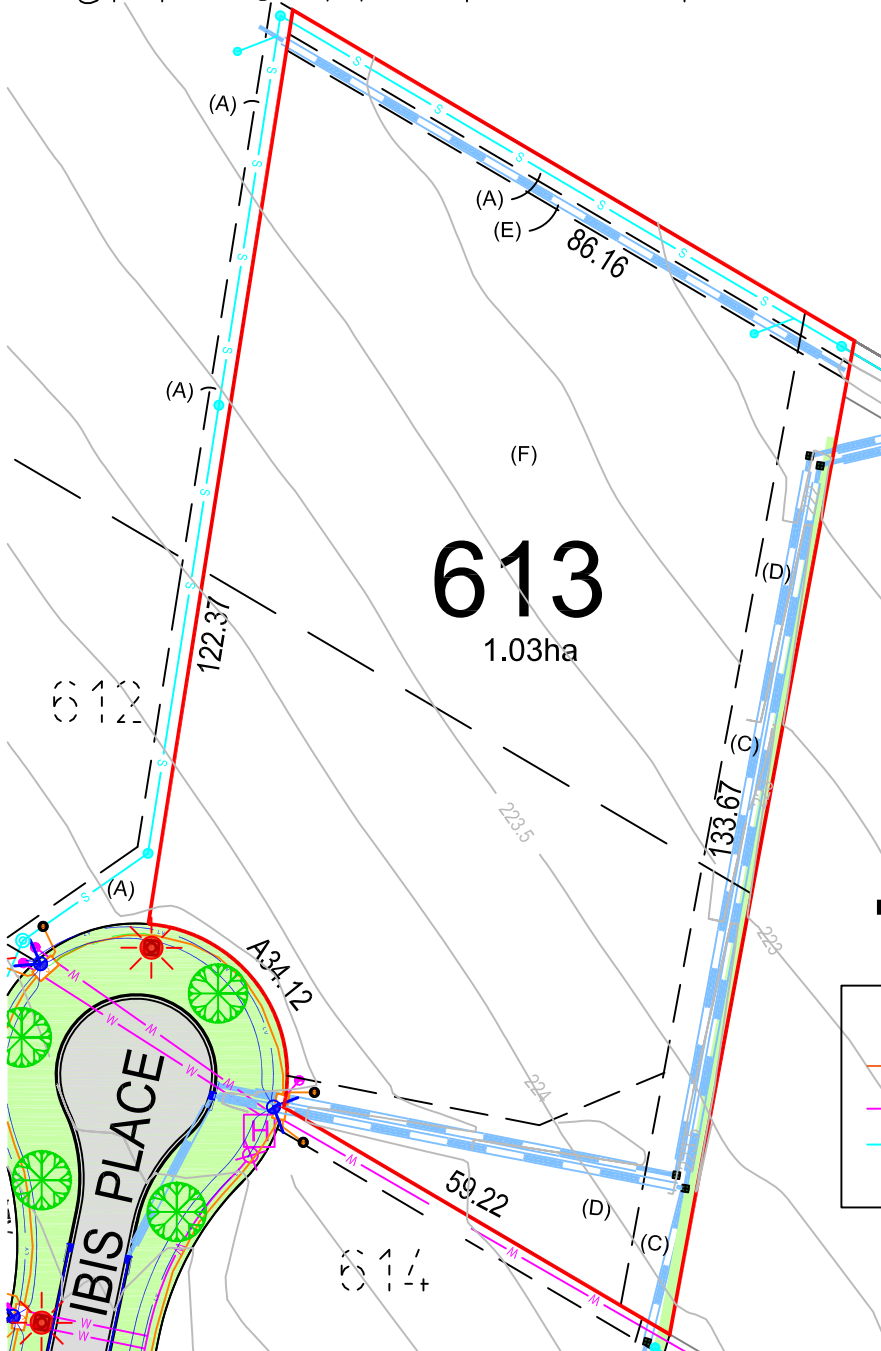
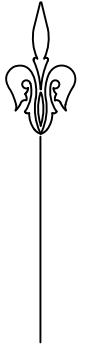

- (A) EASEMENT TO DRAIN SEWAGE 3 WIDE, 4 WIDE AND VARIABLE WIDTH
- (C) EASEMENT TO DRAIN WATER 4 WIDE AND 7 WIDE
- (D) EASEMENT TO DRAIN WATER 7 WIDE AND VARIABLE WIDTH
- (E) EASEMENT TO DRAIN WATER 5 WIDE
- (F) RESTRICTION ON THE USE OF LAND

NOTE: ANTICIPATED LOT CLASSIFICATION IS E

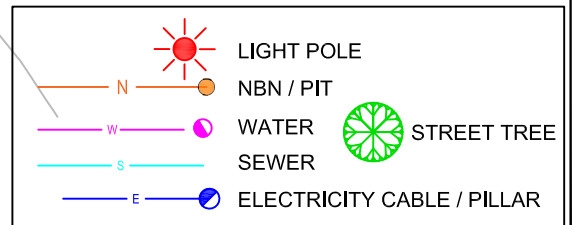

DISCLAIMER/NOTES:

1. Contours are based on finished design levels and are subject to construction and Council certification and therefore should not be considered as final or as-built.
2. Location of utility services including but not limited to power, water, sewer and communications are subject to construction and Supply Authority certification and therefore should not be considered as final or as-built.
3. Survey information such as boundary dimensions and areas, easements etc are subject to final survey. Purchasers should refer to the Deposited Plan and 88B Instrument contained in the Contract for Sale of Land for further detailed information.
4. Geotechnical classification are provided for convenience. Purchasers should refer to referenced detail specialists reports.
5. This Preliminary Site Analysis Plan has been collated from various sources of design information and is provided for convenience to assist Purchasers in obtaining quotations/tenders for dwelling construction.
6. This document does not form part of the Contract of Sale of the Land.

STAGE
6

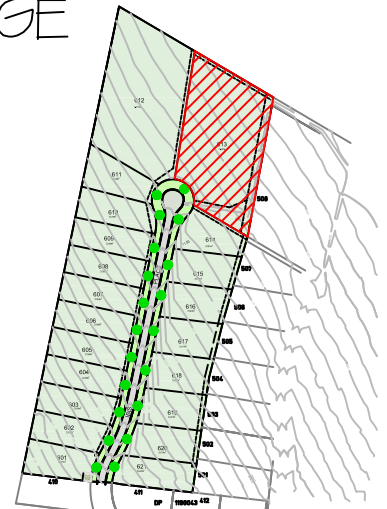

MM HYNDES BAILEY & Co.
REGISTERED SURVEYORS - TOWN PLANNING - CIVIL DESIGN
Surveying the Hunter since 1920



**KURRAJONG
FIELDS**
• S C O N E •

KURRAJONG ESTATE - STAGE 6

LOT 6/4

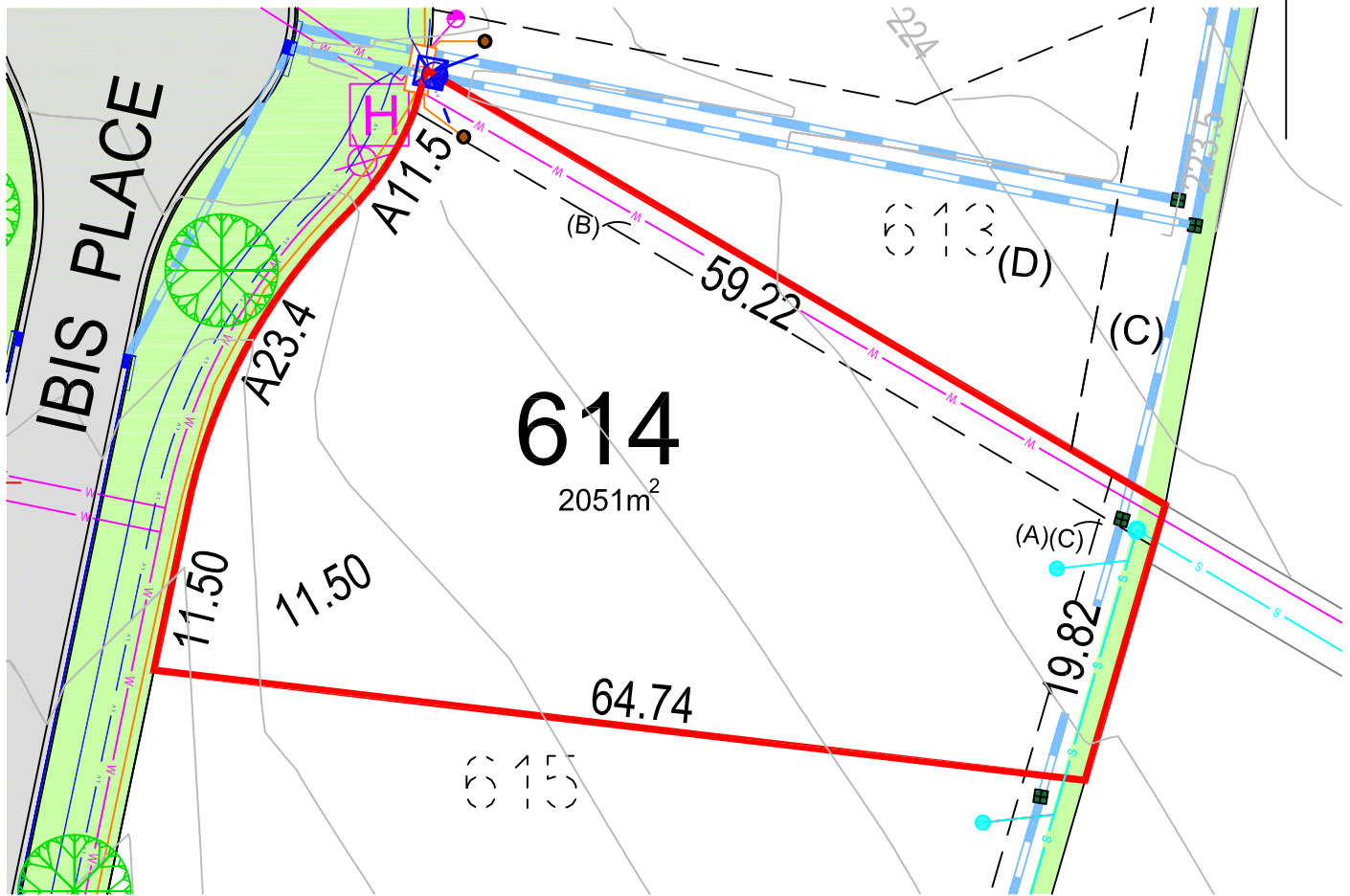

- (A) EASEMENT TO DRAIN SEWAGE 3 WIDE, 4 WIDE AND VARIABLE WIDTH
- (B) EASEMENT FOR WATER SUPPLY 3 WIDE
- (C) EASEMENT TO DRAIN WATER 4 WIDE AND 7 WIDE

NOTE: ANTICIPATED LOT CLASSIFICATION IS E

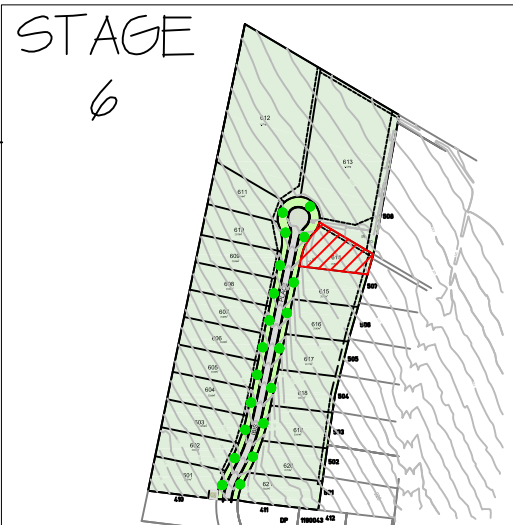
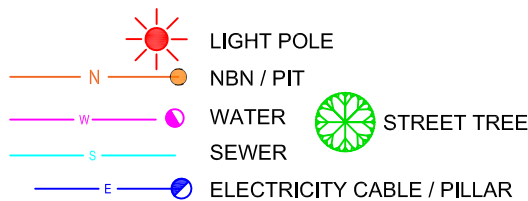

DISCLAIMER/NOTES:

1. Contours are based on finished design levels and are subject to construction and Council certification and therefore should not be considered as final or as-built.
2. Location of utility services including but not limited to power, water, sewer and communications are subject to construction and Supply Authority certification and therefore should not be considered as final or as-built.
3. Survey information such as boundary dimensions and areas, easements etc are subject to final survey. Purchasers should refer to the Deposited Plan and 88B Instrument contained in the Contract for Sale of Land for further detailed information.
4. Geotechnical classification are provided for convenience. Purchasers should refer to referenced detail specialists reports.
5. This Preliminary Site Analysis Plan has been collated from various sources of design information and is provided for convenience to assist Purchasers in obtaining quotations/tenders for dwelling construction.
6. This document does not form part of the Contract of Sale of the Land.

MM HYNDES BAILEY & Co.
 REGISTERED SURVEYORS - TOWN PLANNING - CIVIL DESIGN
Surveying the Hunter since 1920



**KURRAJONG
 FIELDS**
 * S C O N E *

KURRAJONG ESTATE - STAGE 6

LOT 6/5

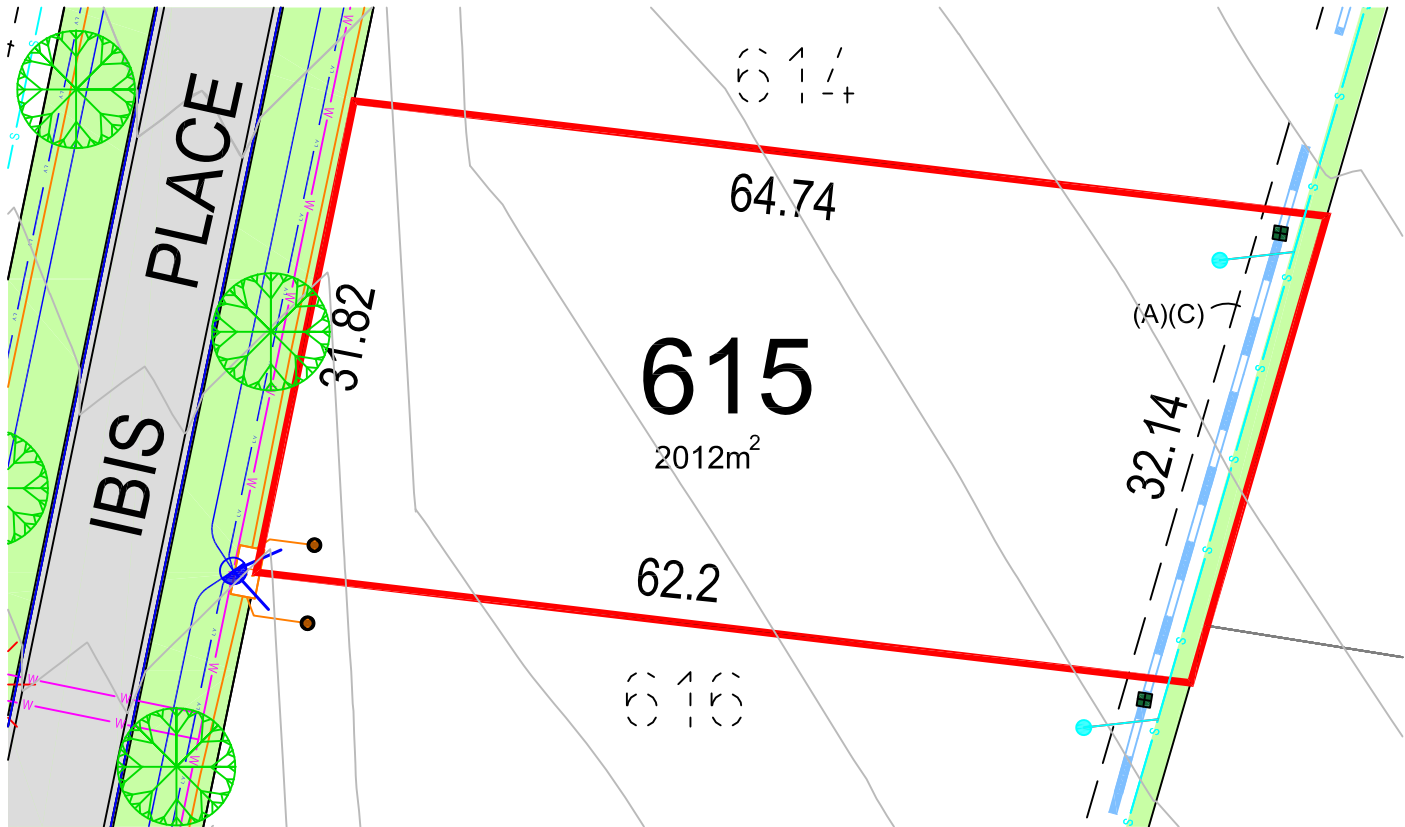

(A) EASEMENT TO DRAIN SEWAGE 3 WIDE, 4 WIDE AND VARIABLE WIDTH
 (C) EASEMENT TO DRAIN WATER 4 WIDE AND 7 WIDE

NOTE: ANTICIPATED LOT CLASSIFICATION IS E

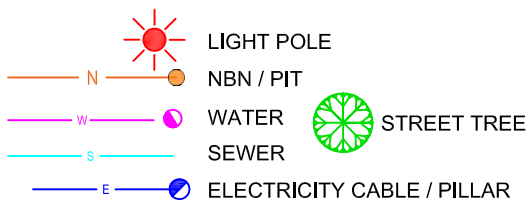

STAGE
6

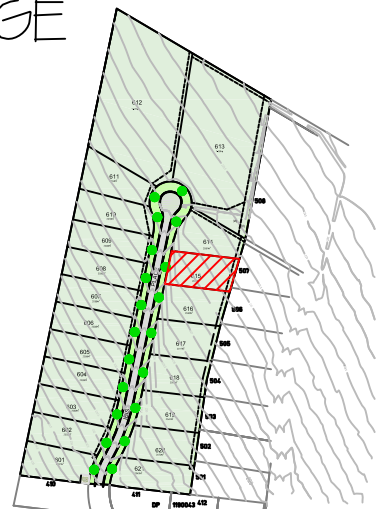

DISCLAIMER/NOTES:

1. Contours are based on finished design levels and are subject to construction and Council certification and therefore should not be considered as final or as-built.
2. Location of utility services including but not limited to power, water, sewer and communications are subject to construction and Supply Authority certification and therefore should not be considered as final or as-built.
3. Survey information such as boundary dimensions and areas, easements etc are subject to final survey. Purchasers should refer to the Deposited Plan and 88B Instrument contained in the Contract for Sale of Land for further detailed information.
4. Geotechnical classification are provided for convenience. Purchasers should refer to referenced detail specialists reports.
5. This Preliminary Site Analysis Plan has been collated from various sources of design information and is provided for convenience to assist Purchasers in obtaining quotations/tenders for dwelling construction.
6. This document does not form part of the Contract of Sale of the Land.

MM HYNDES BAILEY & Co.
 REGISTERED SURVEYORS - TOWN PLANNING - CIVIL DESIGN
Surveying the Hunter since 1920



**KURRAJONG
 FIELDS**
 • S C O N F •

KURRAJONG ESTATE - STAGE 6 LOT 6/6

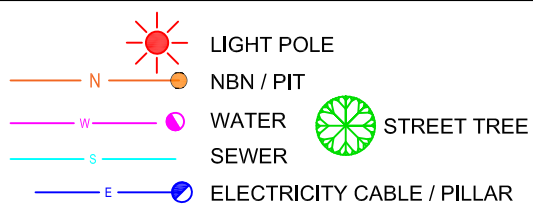
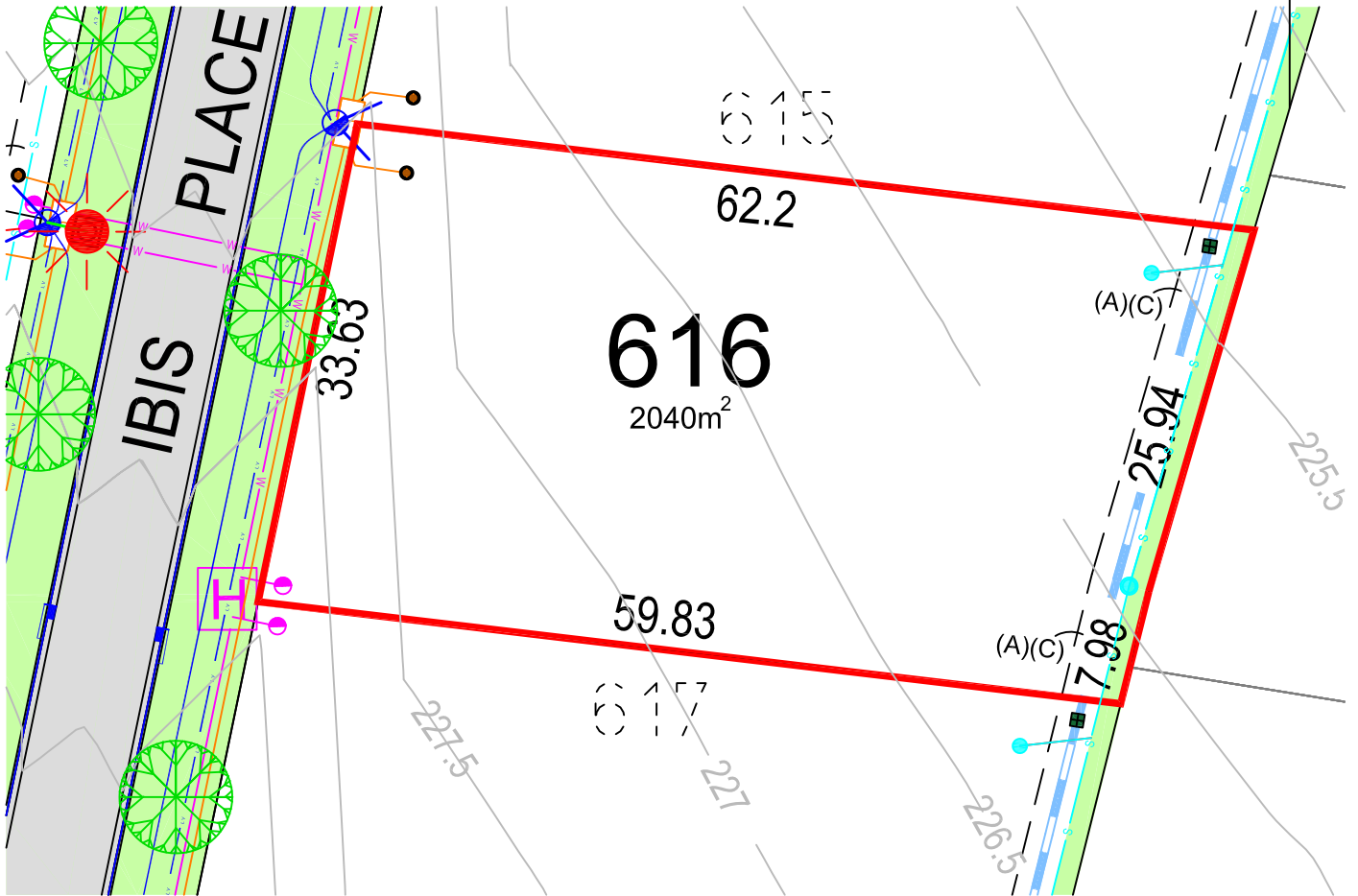

(A) EASEMENT TO DRAIN SEWAGE 3 WIDE, 4 WIDE AND VARIABLE WIDTH
(C) EASEMENT TO DRAIN WATER 4 WIDE AND 7 WIDE

NOTE: ANTICIPATED LOT CLASSIFICATION IS E

DISCLAIMER/NOTES:

1. Contours are based on finished design levels and are subject to construction and Council certification and therefore should not be considered as final or as-built.
2. Location of utility services including but not limited to power, water, sewer and communications are subject to construction and Supply Authority certification and therefore should not be considered as final or as-built.
3. Survey information such as boundary dimensions and areas, easements etc are subject to final survey. Purchasers should refer to the Deposited Plan and 88B Instrument contained in the Contract for Sale of Land for further detailed information.
4. Geotechnical classification are provided for convenience. Purchasers should refer to referenced detail specialists reports.
5. This Preliminary Site Analysis Plan has been collated from various sources of design information and is provided for convenience to assist Purchasers in obtaining quotations/tenders for dwelling construction.
6. This document does not form part of the Contract of Sale of the Land.

STAGE 6

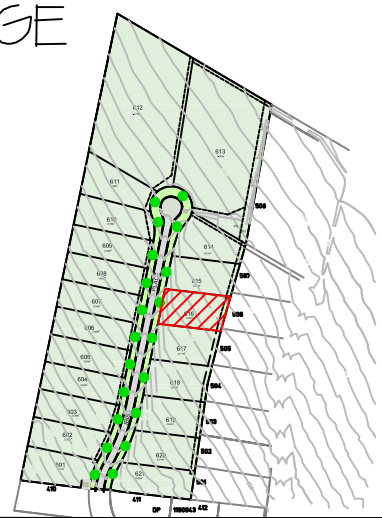

MM HYNDES BAILEY & Co.
REGISTERED SURVEYORS - TOWN PLANNING - CIVIL DESIGN
Surveying the Hunter since 1920



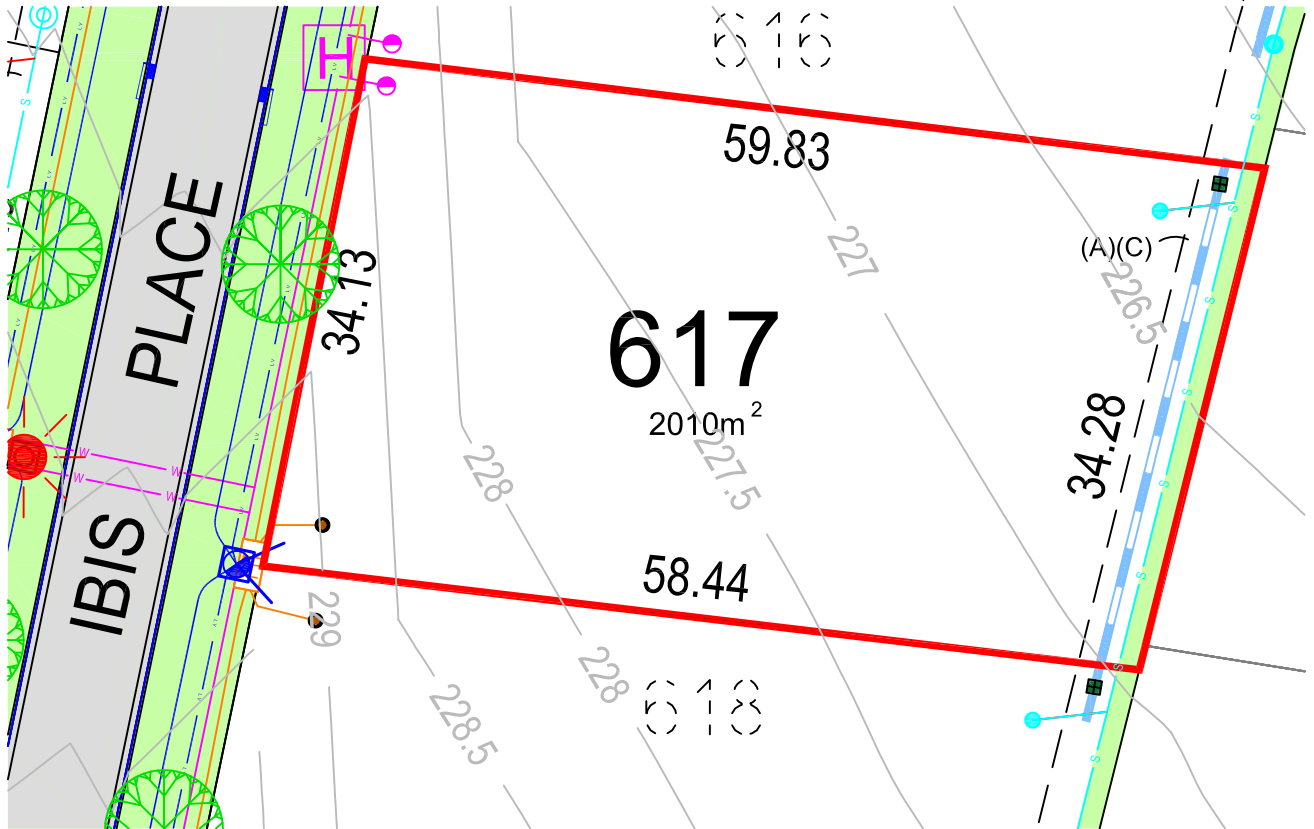

**KURRAJONG
FIELDS**
• S C O N F •

KURRAJONG ESTATE - STAGE 6 LOT 617

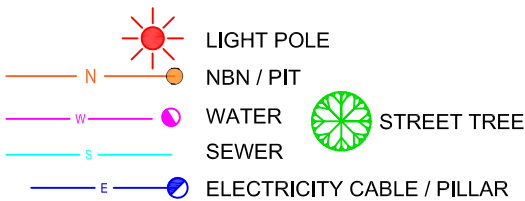

(A) EASEMENT TO DRAIN SEWAGE 3 WIDE, 4 WIDE AND VARIABLE WIDTH
(C) EASEMENT TO DRAIN WATER 4 WIDE AND 7 WIDE

NOTE: ANTICIPATED LOT CLASSIFICATION IS E



STAGE
6

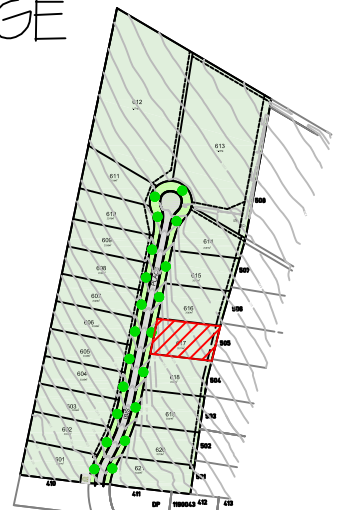

DISCLAIMER/NOTES:

1. Contours are based on finished design levels and are subject to construction and Council certification and therefore should not be considered as final or as-built.
2. Location of utility services including but not limited to power, water, sewer and communications are subject to construction and Supply Authority certification and therefore should not be considered as final or as-built.
3. Survey information such as boundary dimensions and areas, easements etc are subject to final survey. Purchasers should refer to the Deposited Plan and 88B Instrument contained in the Contract for Sale of Land for further detailed information.
4. Geotechnical classification are provided for convenience. Purchasers should refer to referenced detail specialists reports.
5. This Preliminary Site Analysis Plan has been collated from various sources of design information and is provided for convenience to assist Purchasers in obtaining quotations/tenders for dwelling construction.
6. This document does not form part of the Contract of Sale of the Land.

MM HYNDES BAILEY & Co.
REGISTERED SURVEYORS - TOWN PLANNING - CIVIL DESIGN
Surveying the Hunter since 1920



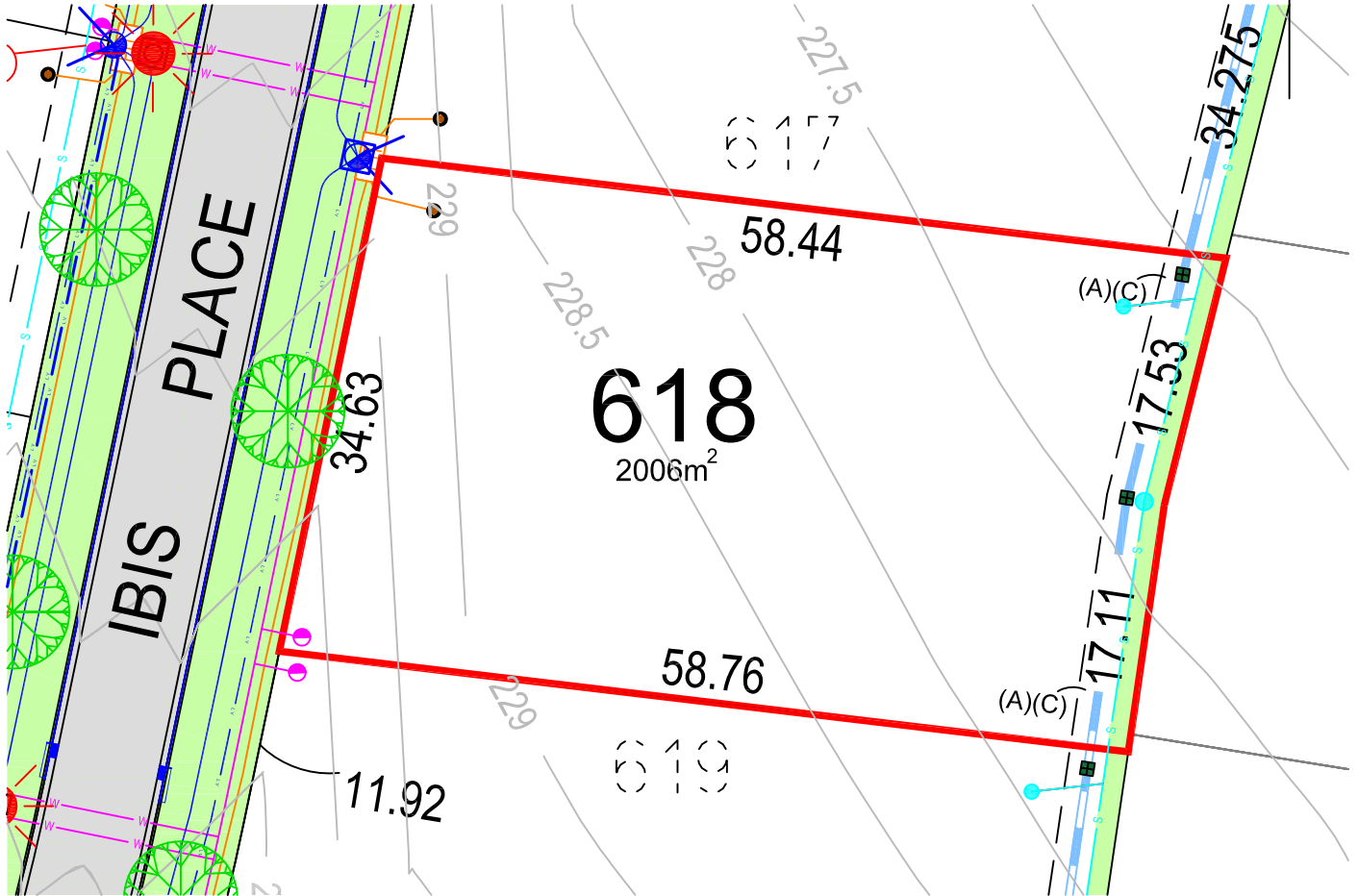

**KURRAJONG
FIELDS**
• S C O N F •

KURRAJONG ESTATE - STAGE 6 LOT 618

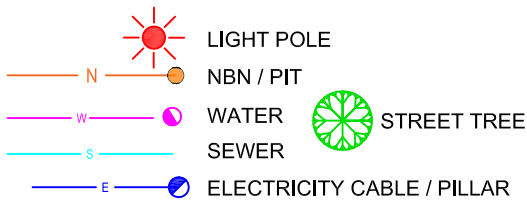

618
2006m²



(A) EASEMENT TO DRAIN SEWAGE 3 WIDE, 4 WIDE AND VARIABLE WIDTH
(C) EASEMENT TO DRAIN WATER 4 WIDE AND 7 WIDE

NOTE: ANTICIPATED LOT CLASSIFICATION IS E

DISCLAIMER/NOTES:

1. Contours are based on finished design levels and are subject to construction and Council certification and therefore should not be considered as final or as-built.
2. Location of utility services including but not limited to power, water, sewer and communications are subject to construction and Supply Authority certification and therefore should not be considered as final or as-built.
3. Survey information such as boundary dimensions and areas, easements etc are subject to final survey. Purchasers should refer to the Deposited Plan and 88B Instrument contained in the Contract for Sale of Land for further detailed information.
4. Geotechnical classification are provided for convenience. Purchasers should refer to referenced detail specialists reports.
5. This Preliminary Site Analysis Plan has been collated from various sources of design information and is provided for convenience to assist Purchasers in obtaining quotations/tenders for dwelling construction.
6. This document does not form part of the Contract of Sale of the Land.

STAGE
6

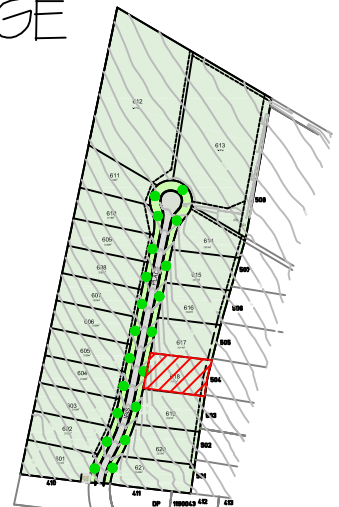

MM HYNDES BAILEY & Co.
REGISTERED SURVEYORS - TOWN PLANNING - CIVIL DESIGN
Surveying the Hunter since 1920







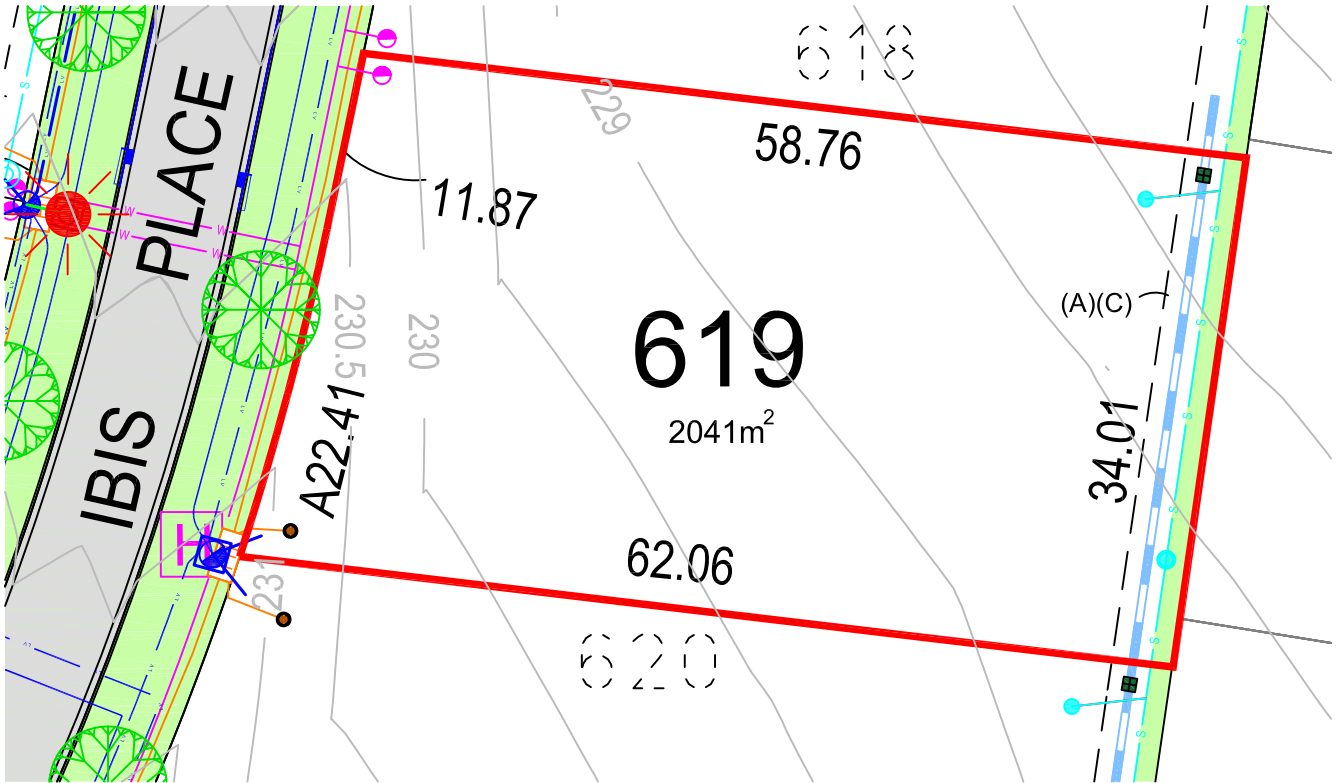

**KURRAJONG
FIELDS**
• SCONE •

KURRAJONG ESTATE - STAGE 6 LOT 619



(A) EASEMENT TO DRAIN SEWAGE 3 WIDE, 4 WIDE, 5 WIDE AND VARIABLE WIDTH
(C) EASEMENT TO DRAIN WATER 4 WIDE AND 7 WIDE

NOTE: ANTICIPATED LOT CLASSIFICATION IS E

-  LIGHT POLE
-  NBN / PIT
-  WATER  STREET TREE
-  SEWER
-  ELECTRICITY CABLE / PILLAR

STAGE
6

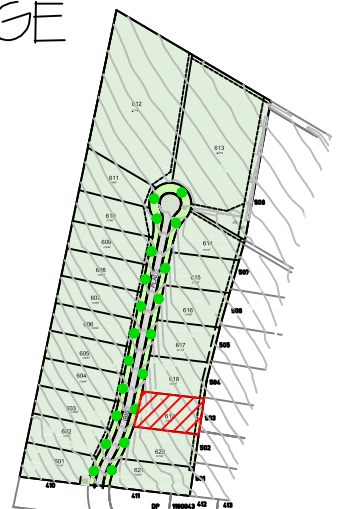

DISCLAIMER/NOTES:

1. Contours are based on finished design levels and are subject to construction and Council certification and therefore should not be considered as final or as-built.
2. Location of utility services including but not limited to power, water, sewer and communications are subject to construction and Supply Authority certification and therefore should not be considered as final or as-built.
3. Survey information such as boundary dimensions and areas, easements etc are subject to final survey. Purchasers should refer to the Deposited Plan and 88B Instrument contained in the Contract for Sale of Land for further detailed information.
4. Geotechnical classification are provided for convenience. Purchasers should refer to referenced detail specialists reports.
5. This Preliminary Site Analysis Plan has been collated from various sources of design information and is provided for convenience to assist Purchasers in obtaining quotations/tenders for dwelling construction.
6. This document does not form part of the Contract of Sale of the Land.

MM HYNDES BAILEY & Co.
REGISTERED SURVEYORS - TOWN PLANNING - CIVIL DESIGN
Surveying the Hunter since 1920



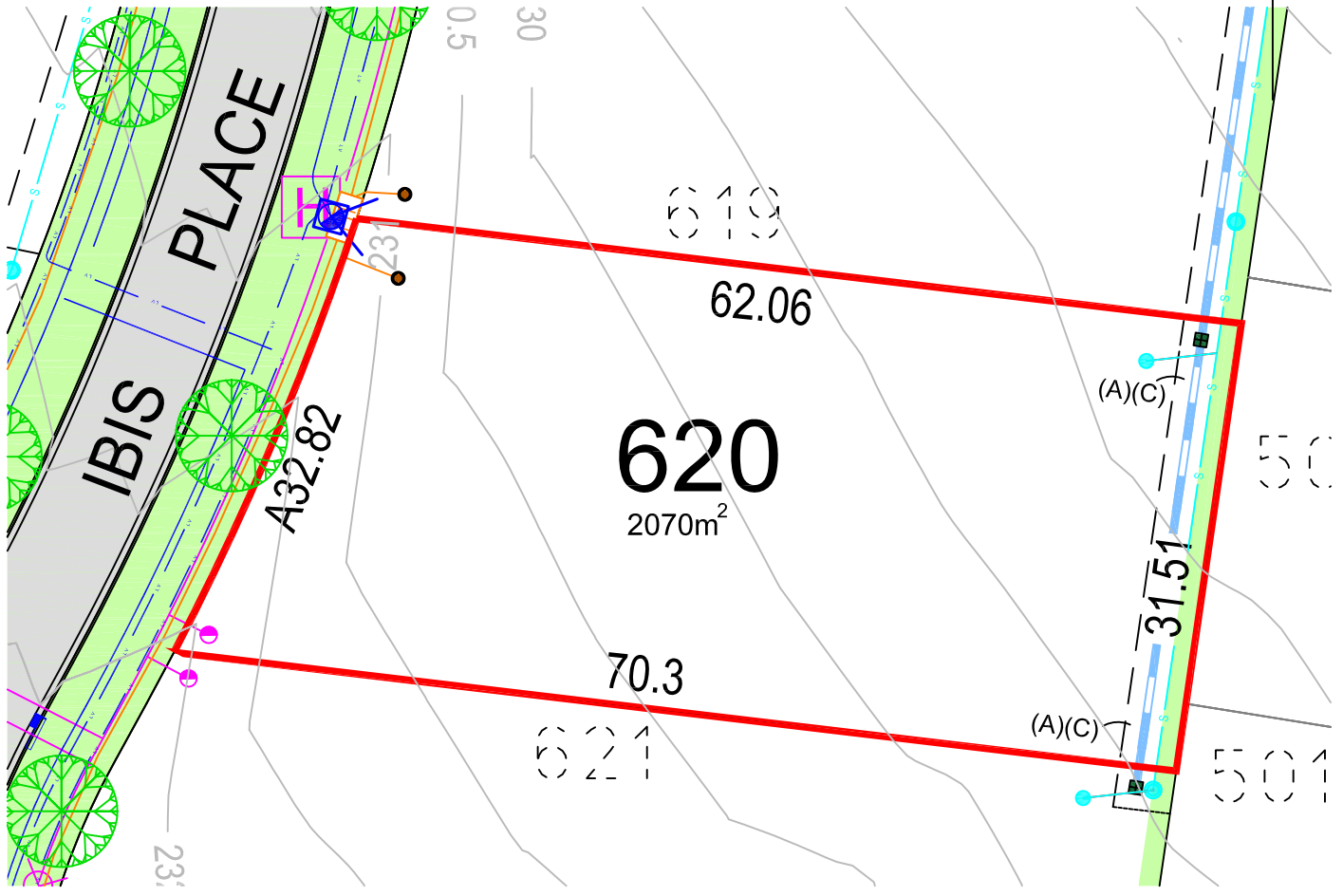

**KURRAJONG
FIELDS**
• S C O N F •

KURRAJONG ESTATE - STAGE 6 LOT 620

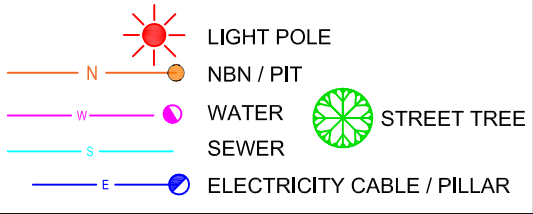

(A) EASEMENT TO DRAIN SEWAGE 3 WIDE, 4 WIDE AND VARIABLE WIDTH
(C) EASEMENT TO DRAIN WATER 4 WIDE AND 7 WIDE

NOTE: ANTICIPATED LOT CLASSIFICATION IS E



STAGE
6

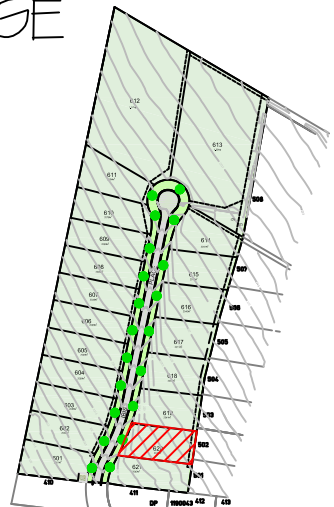

DISCLAIMER/NOTES:

1. Contours are based on finished design levels and are subject to construction and Council certification and therefore should not be considered as final or as-built.
2. Location of utility services including but not limited to power, water, sewer and communications are subject to construction and Supply Authority certification and therefore should not be considered as final or as-built.
3. Survey information such as boundary dimensions and areas, easements etc are subject to final survey. Purchasers should refer to the Deposited Plan and 88B Instrument contained in the Contract for Sale of Land for further detailed information.
4. Geotechnical classification are provided for convenience. Purchasers should refer to referenced detail specialists reports.
5. This Preliminary Site Analysis Plan has been collated from various sources of design information and is provided for convenience to assist Purchasers in obtaining quotations/tenders for dwelling construction.
6. This document does not form part of the Contract of Sale of the Land.

MM HYNDES BAILEY & Co.
REGISTERED SURVEYORS - TOWN PLANNING - CIVIL DESIGN
Surveying the Hunter since 1920



**KURRAJONG
FIELDS**
• S C O N F •

KURRAJONG ESTATE - STAGE 6 LOT 621

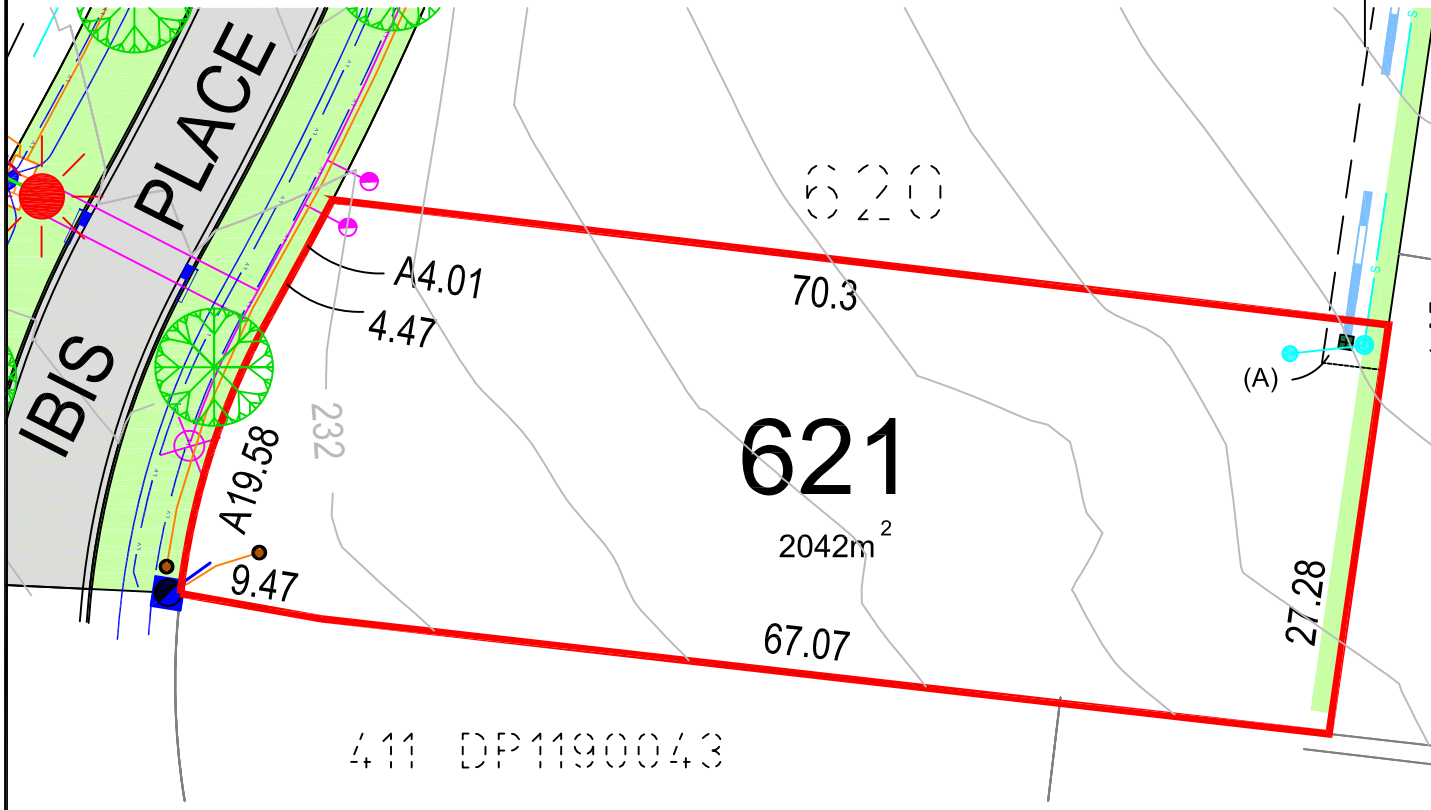

(A) EASEMENT TO DRAIN SEWAGE 3 WIDE, 4 WIDE, 5 WIDE AND VARIABLE WIDTH

NOTE: ANTICIPATED LOT CLASSIFICATION IS E

	LIGHT POLE
	NBN / PIT
	WATER
	SEWER
	ELECTRICITY CABLE / PILLAR
	STREET TREE

DISCLAIMER/NOTES:

1. Contours are based on finished design levels and are subject to construction and Council certification and therefore should not be considered as final or as-built.
2. Location of utility services including but not limited to power, water, sewer and communications are subject to construction and Supply Authority certification and therefore should not be considered as final or as-built.
3. Survey information such as boundary dimensions and areas, easements etc are subject to final survey. Purchasers should refer to the Deposited Plan and 88B Instrument contained in the Contract for Sale of Land for further detailed information.
4. Geotechnical classification are provided for convenience. Purchasers should refer to referenced detail specialists reports.
5. This Preliminary Site Analysis Plan has been collated from various sources of design information and is provided for convenience to assist Purchasers in obtaining quotations/tenders for dwelling construction.
6. This document does not form part of the Contract of Sale of the Land.

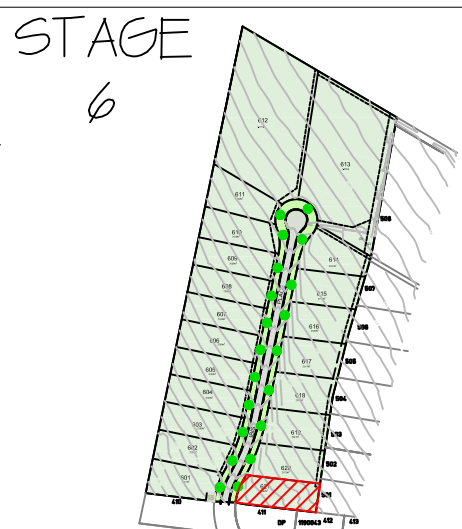

MM HYNDES BAILEY & Co.
REGISTERED SURVEYORS - TOWN PLANNING - CIVIL DESIGN
Surveying the Hunter since 1920



**KURRAJONG
FIELDS**
• SCONE •