

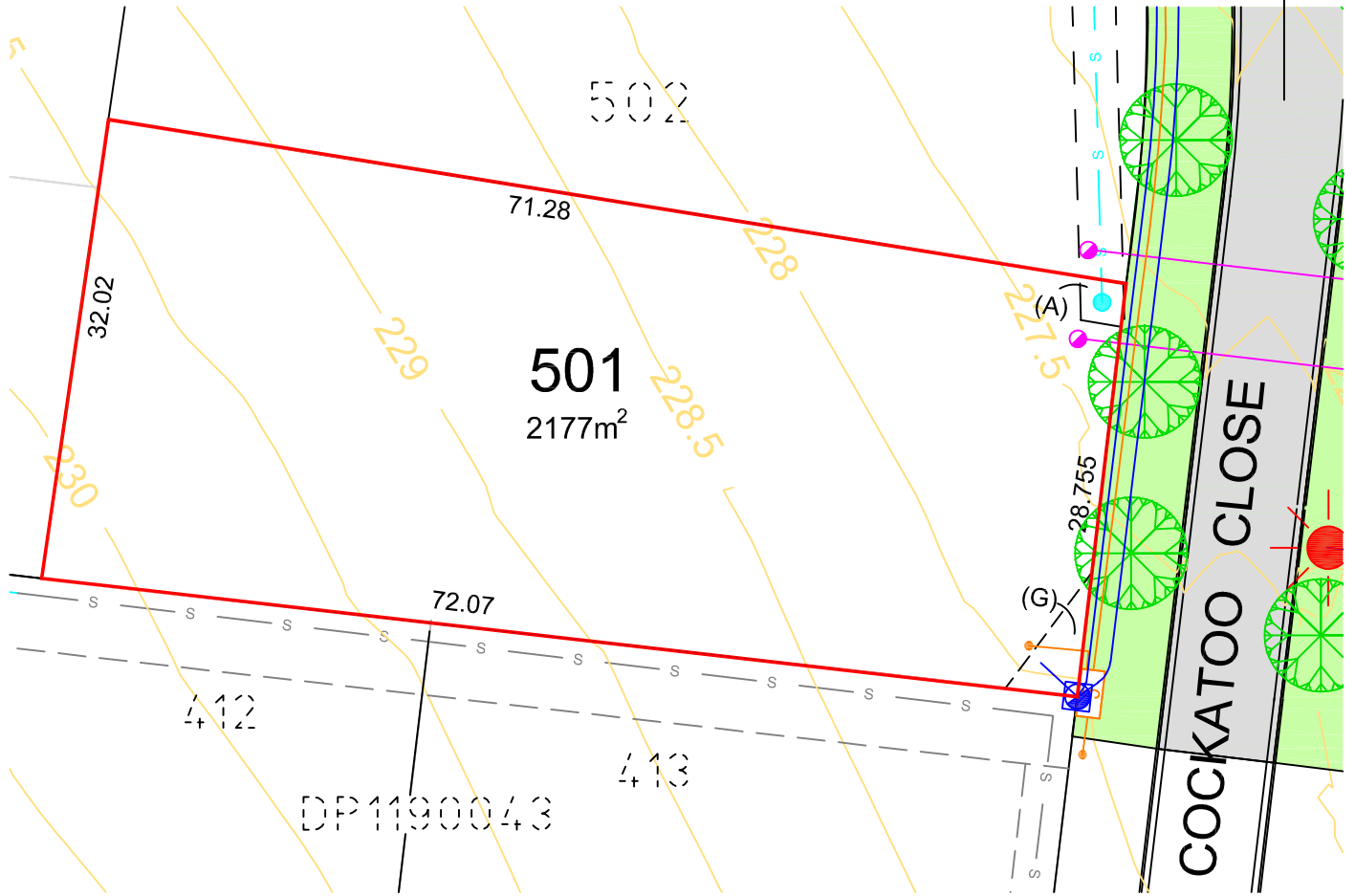





KURRAJONG ESTATE - STAGE 5 LOT 501



(A) EASEMENT TO DRAIN SEWAGE 3 WIDE, 4 WIDE, 5 WIDE AND VARIABLE WIDTH
(G) EASEMENT FOR FENCING, LANDSCAPING AND MAINTENANCE VARIABLE WIDTH

NOTE: ANTICIPATED LOT CLASSIFICATION IS E

-  LIGHT POLE
-  NBN / PIT
-  WATER
-  SEWER
-  ELECTRICITY CABLE / PILLAR

STAGE 5

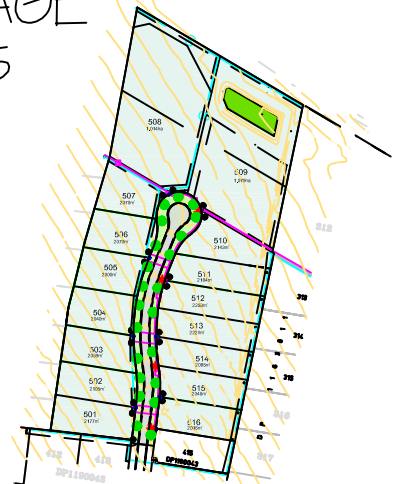

DISCLAIMER/NOTES:

1. Contours are based on finished design levels and are subject to construction and Council certification and therefore should not be considered as final or as-built.
2. Location of utility services including but not limited to power, water, sewer, communications and gas are subject to construction and Supply Authority certification and therefore should not be considered as final or as-built.
3. Survey information such as boundary dimensions and areas, easements etc are subject to final survey. Purchasers should refer to the Deposited Plan and 88B Instrument contained in the Contract for Sale of Land for further detailed information.
4. Bushfire and Geotechnical classification are provided for convenience. Purchasers should refer to referenced detail specialists reports.
5. This Preliminary Site Analysis Plan has been collated from various sources of design information and is provided for convenience to assist Purchasers in obtaining quotations/tenders for dwelling construction.
6. This document does not form part of the Contract of Sale of the Land.

MM HYNDES BAILEY & Co.
REGISTERED SURVEYORS - TOWN PLANNING - CIVIL DESIGN
Surveying the Hunter since 1920



**KURRAJONG
FIELDS**
• S C O N F •

KURRAJONG ESTATE - STAGE 5

LOT 502

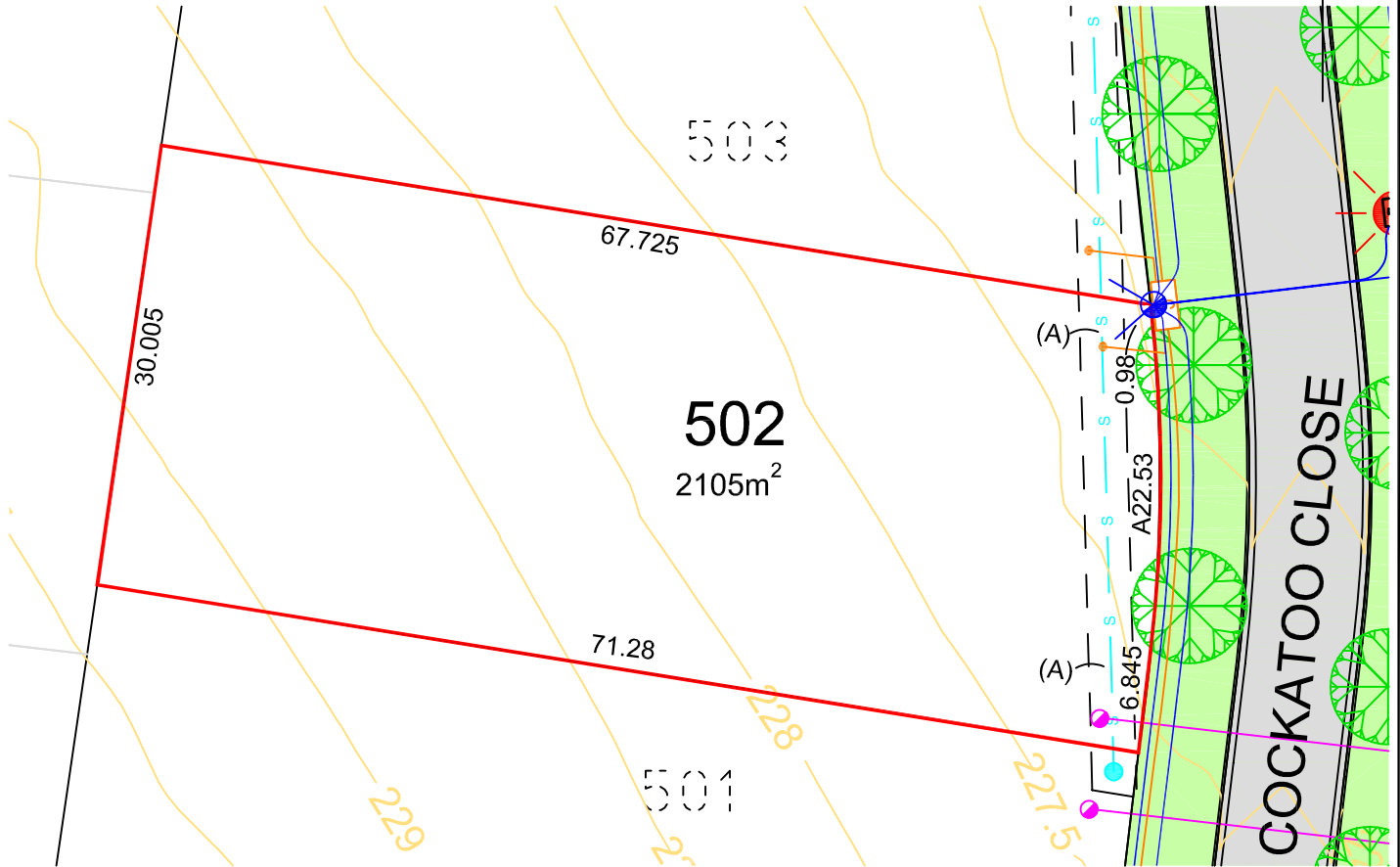

	LIGHT POLE
	NBN / PIT
	WATER
	SEWER
	ELECTRICITY CABLE / PILLAR

(A) EASEMENT TO DRAIN SEWAGE 3 WIDE, 4 WIDE, 5 WIDE AND VARIABLE WIDTH
NOTE: ANTICIPATED LOT CLASSIFICATION IS E

DISCLAIMER/NOTES:

1. Contours are based on finished design levels and are subject to construction and Council certification and therefore should not be considered as final or as-built.
2. Location of utility services including but not limited to power, water, sewer, communications and gas are subject to construction and Supply Authority certification and therefore should not be considered as final or as-built.
3. Survey information such as boundary dimensions and areas, easements etc are subject to final survey, Purchasers should refer to the Deposited Plan and 88B Instrument contained in the Contract for Sale of Land for further detailed information.
4. Bushfire and Geotechnical classification are provided for convenience. Purchasers should refer to referenced detail specialists reports.
5. This Preliminary Site Analysis Plan has been collated from various sources of design information and is provided for convenience to assist Purchasers in obtaining quotations/tenders for dwelling construction.
6. This document does not form part of the Contract of Sale of the Land.

STAGE 5

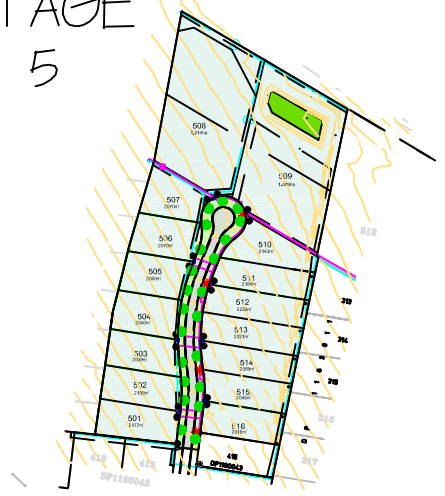

MM HYNDES BAILEY & Co.
 REGISTERED SURVEYORS - TOWN PLANNING - CIVIL DESIGN
Surveying the Hunter since 1920



**KURRAJONG
 FIELDS**
 . S C O N F .

KURRAJONG ESTATE - STAGE 5

LOT 503

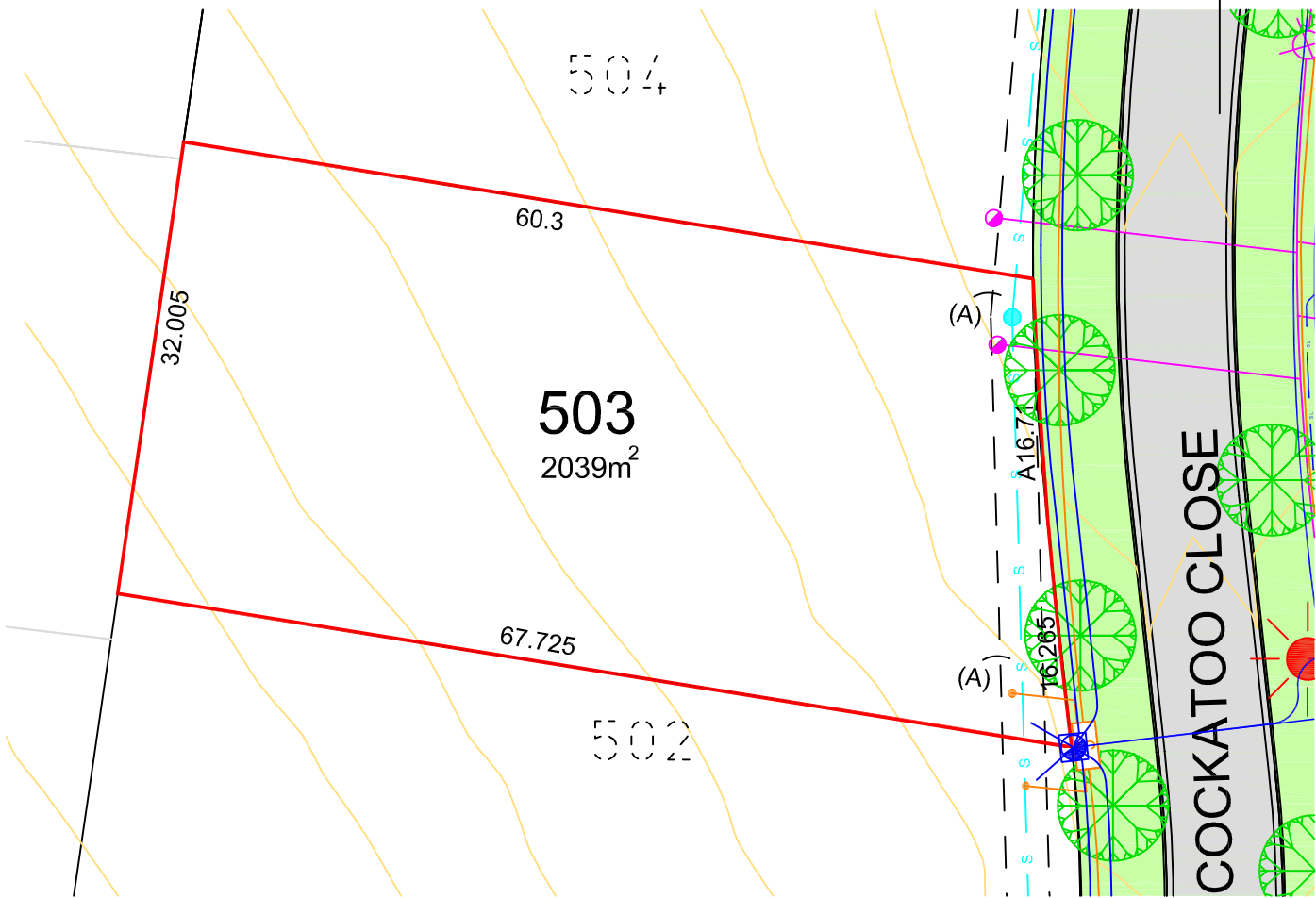

	LIGHT POLE
	NBN / PIT
	WATER
	SEWER
	ELECTRICITY CABLE / PILLAR

(A) EASEMENT TO DRAIN SEWAGE 3 WIDE, 4 WIDE, 5 WIDE AND VARIABLE WIDTH
NOTE: ANTICIPATED LOT CLASSIFICATION IS E

DISCLAIMER/NOTES:

1. Contours are based on finished design levels and are subject to construction and Council certification and therefore should not be considered as final or as-built.
2. Location of utility services including but not limited to power, water, sewer, communications and gas are subject to construction and Supply Authority certification and therefore should not be considered as final or as-built.
3. Survey information such as boundary dimensions and areas, easements etc are subject to final survey. Purchasers should refer to the Deposited Plan and 88B Instrument contained in the Contract for Sale of Land for further detailed information.
4. Bushfire and Geotechnical classification are provided for convenience. Purchasers should refer to referenced detail specialists reports.
5. This Preliminary Site Analysis Plan has been collated from various sources of design information and is provided for convenience to assist Purchasers in obtaining quotations/tenders for dwelling construction.
6. This document does not form part of the Contract of Sale of the Land.

STAGE 5

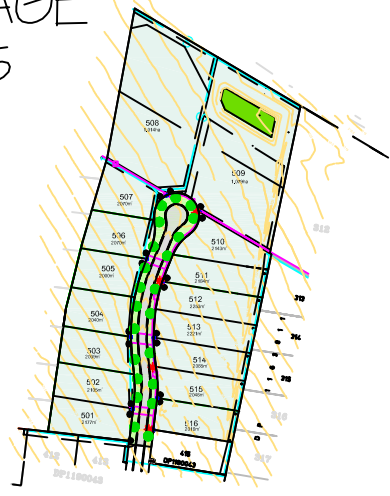

MM HYNDES BAILEY & Co.
 REGISTERED SURVEYORS - TOWN PLANNING - CIVIL DESIGN
Surveying the Hunter since 1920



**KURRAJONG
 FIELDS**
 . S C O N F .

KURRAJONG ESTATE - STAGE 5 LOT 504

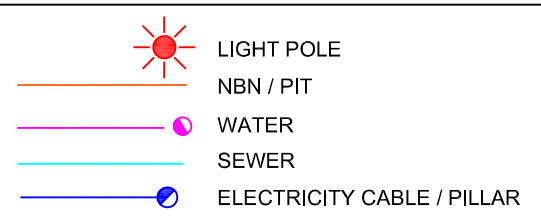
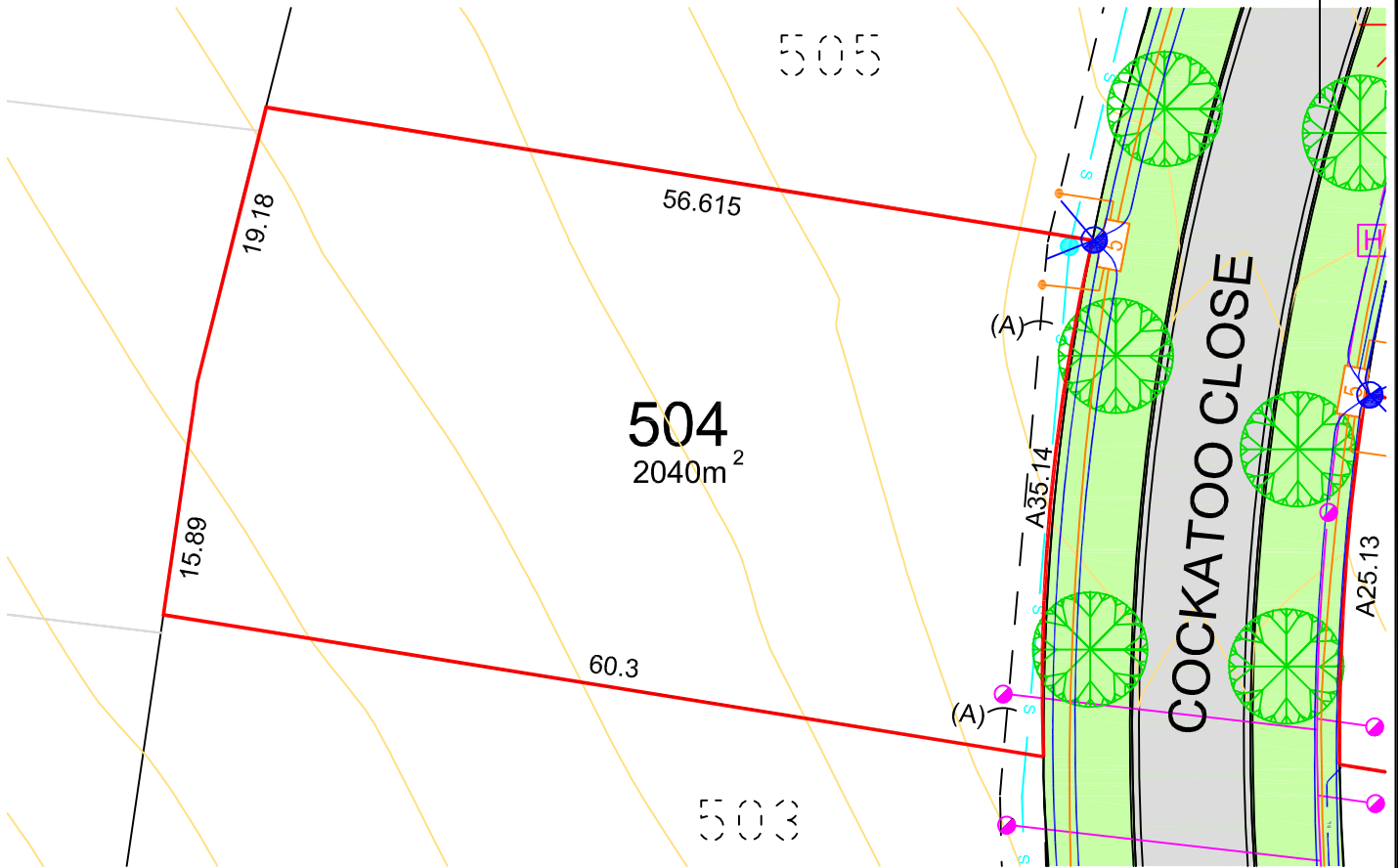

(A) EASEMENT TO DRAIN SEWAGE 3 WIDE, 4 WIDE, 5 WIDE AND VARIABLE WIDTH
NOTE: ANTICIPATED LOT CLASSIFICATION IS E

DISCLAIMER/NOTES:

1. Contours are based on finished design levels and are subject to construction and Council certification and therefore should not be considered as final or as-built.
2. Location of utility services including but not limited to power, water, sewer, communications and gas are subject to construction and Supply Authority certification and therefore should not be considered as final or as-built.
3. Survey information such as boundary dimensions and areas, easements etc are subject to final survey. Purchasers should refer to the Deposited Plan and 88B Instrument contained in the Contract for Sale of Land for further detailed information.
4. Bushfire and Geotechnical classification are provided for convenience. Purchasers should refer to referenced detail specialists reports.
5. This Preliminary Site Analysis Plan has been collated from various sources of design information and is provided for convenience to assist Purchasers in obtaining quotations/tenders for dwelling construction.
6. This document does not form part of the Contract of Sale of the Land.

STAGE 5

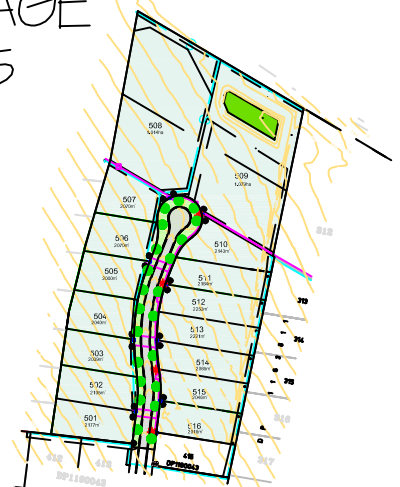

MM HYNDES BAILEY & Co.
 REGISTERED SURVEYORS - TOWN PLANNING - CIVIL DESIGN
Surveying the Hunter since 1920





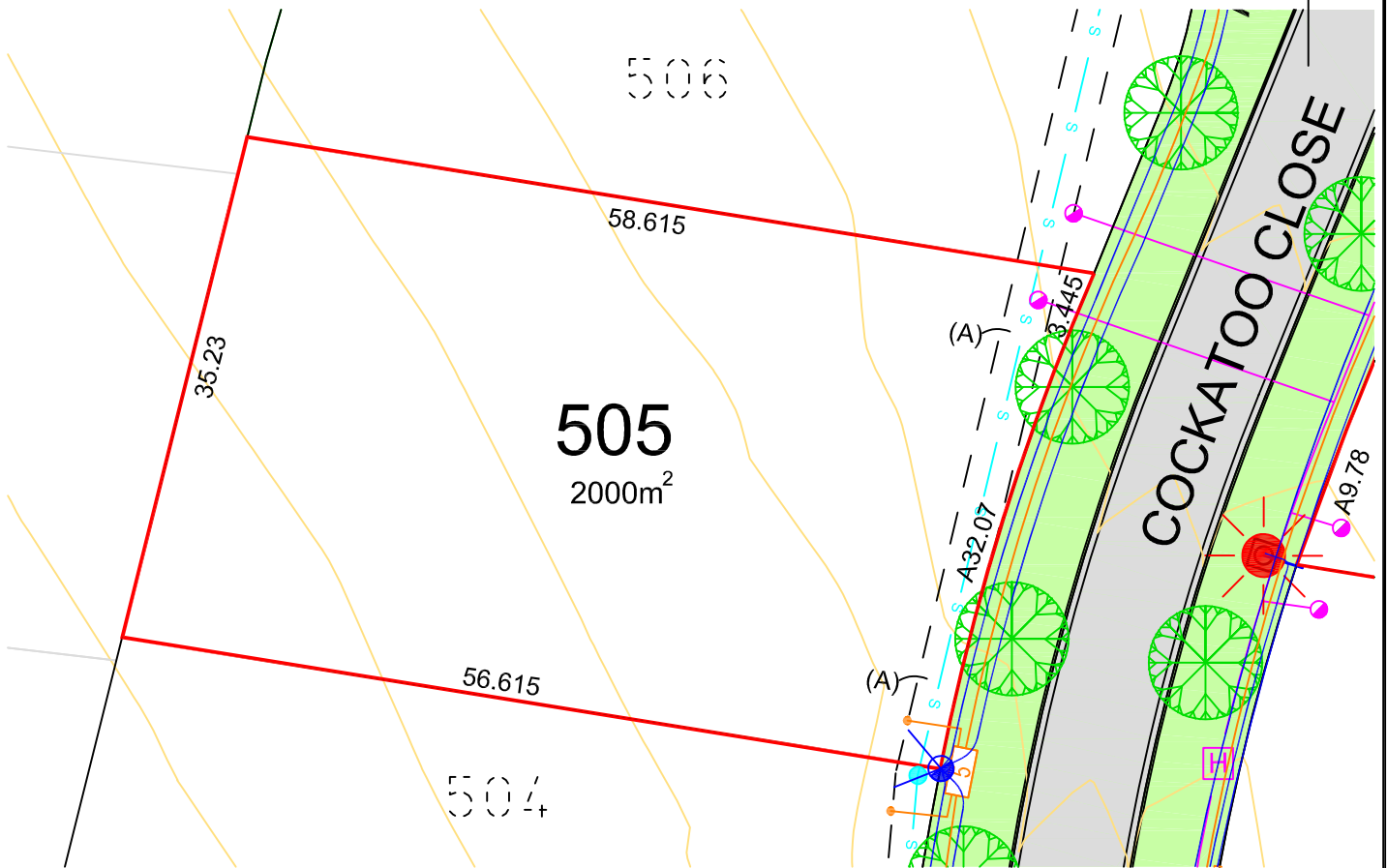

**KURRAJONG
 FIELDS**
 . S C O N E .

KURRAJONG ESTATE - STAGE 5

LOT 505



-  LIGHT POLE
-  NBN / PIT
-  WATER
-  SEWER
-  ELECTRICITY CABLE / PILLAR

(A) EASEMENT TO DRAIN SEWAGE 3 WIDE, 4 WIDE, 5 WIDE AND VARIABLE WIDTH
NOTE: ANTICIPATED LOT CLASSIFICATION IS E

DISCLAIMER/NOTES:

1. Contours are based on finished design levels and are subject to construction and Council certification and therefore should not be considered as final or as-built.
2. Location of utility services including but not limited to power, water, sewer, communications and gas are subject to construction and Supply Authority certification and therefore should not be considered as final or as-built.
3. Survey information such as boundary dimensions and areas, easements etc are subject to final survey. Purchasers should refer to the Deposited Plan and 88B Instrument contained in the Contract for Sale of Land for further detailed information.
4. Bushfire and Geotechnical classification are provided for convenience. Purchasers should refer to referenced detail specialists reports.
5. This Preliminary Site Analysis Plan has been collated from various sources of design information and is provided for convenience to assist Purchasers in obtaining quotations/tenders for dwelling construction.
6. This document does not form part of the Contract of Sale of the Land.

STAGE 5

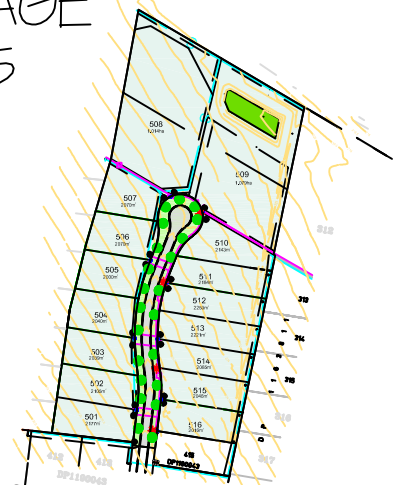

MM HYNDES BAILEY & Co.
 REGISTERED SURVEYORS - TOWN PLANNING - CIVIL DESIGN
Surveying the Hunter since 1920







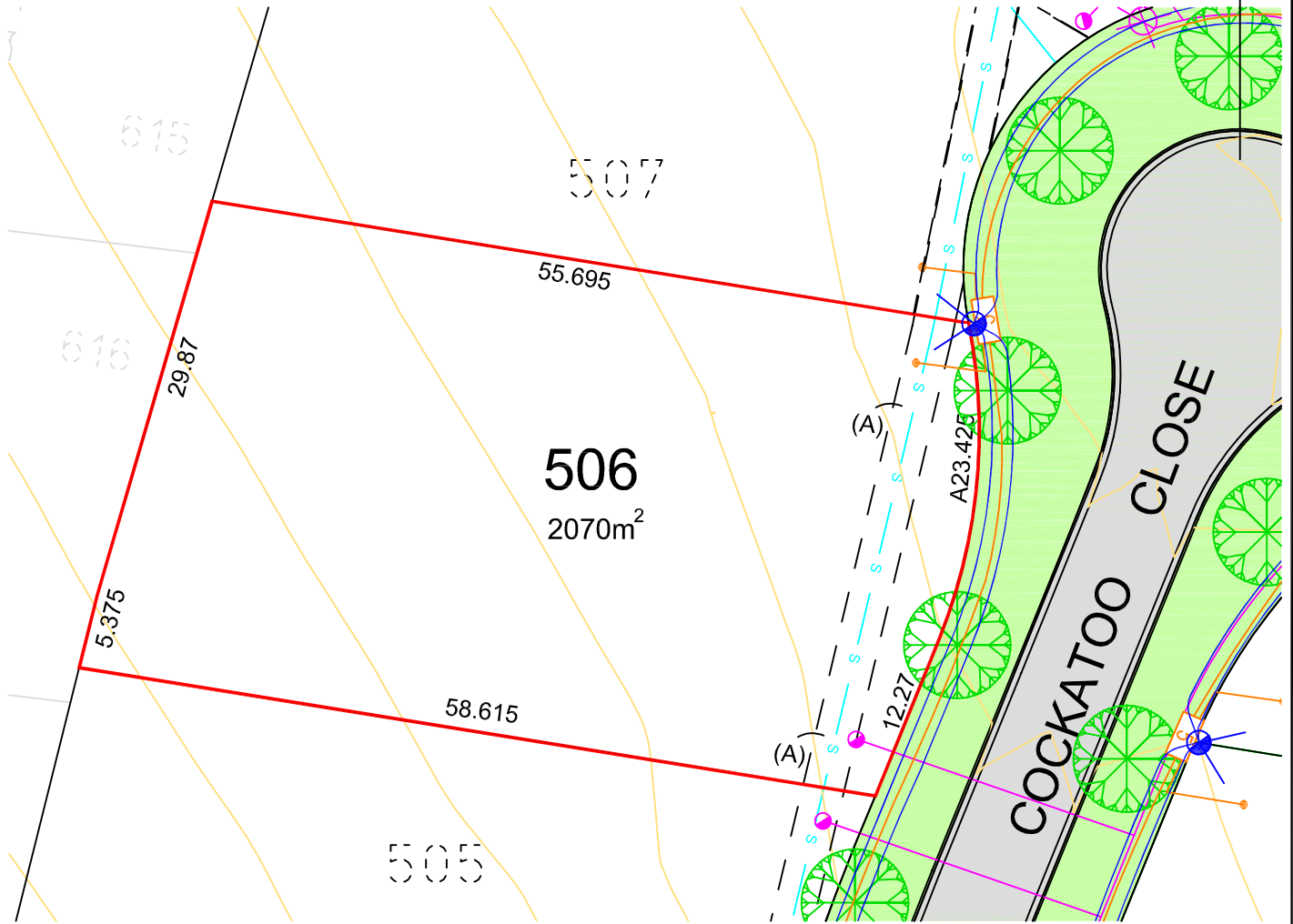

**KURRAJONG
 FIELDS**
 . S C O N F .

KURRAJONG ESTATE - STAGE 5

LOT 506



	LIGHT POLE
	NBN / PIT
	WATER
	SEWER
	ELECTRICITY CABLE / PILLAR

(A) EASEMENT TO DRAIN SEWAGE 3 WIDE, 4 WIDE, 5 WIDE AND VARIABLE WIDTH
NOTE: ANTICIPATED LOT CLASSIFICATION IS E

DISCLAIMER/NOTES:

1. Contours are based on finished design levels and are subject to construction and Council certification and therefore should not be considered as final or as-built.
2. Location of utility services including but not limited to power, water, sewer, communications and gas are subject to construction and Supply Authority certification and therefore should not be considered as final or as-built.
3. Survey information such as boundary dimensions and areas, easements etc are subject to final survey. Purchasers should refer to the Deposited Plan and 88B Instrument contained in the Contract for Sale of Land for further detailed information.
4. Bushfire and Geotechnical classification are provided for convenience. Purchasers should refer to referenced detail specialists reports.
5. This Preliminary Site Analysis Plan has been collated from various sources of design information and is provided for convenience to assist Purchasers in obtaining quotations/tenders for dwelling construction.
6. This document does not form part of the Contract of Sale of the Land.

STAGE 5

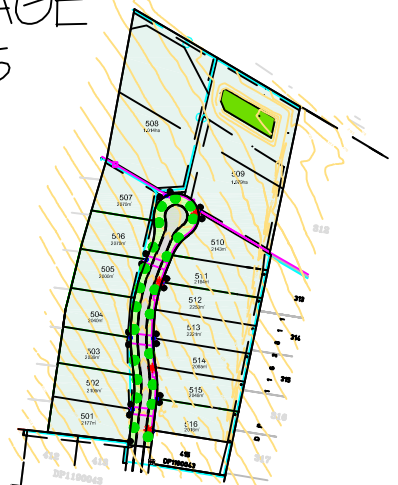







MM HYNDES BAILEY & Co.
 REGISTERED SURVEYORS - TOWN PLANNING - CIVIL DESIGN
Surveying the Hunter since 1920

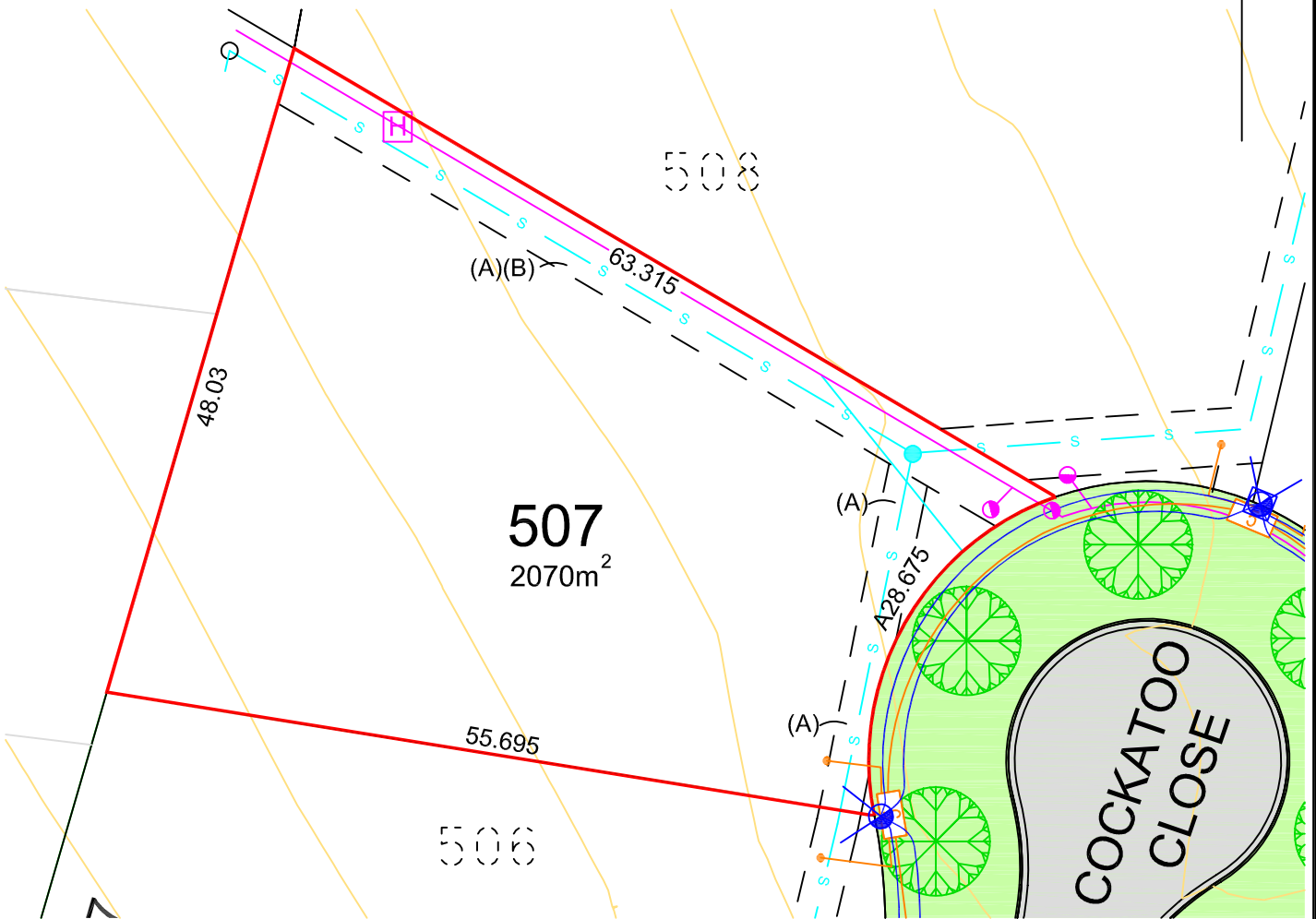

**KURRAJONG
 FIELDS**
 • S C O N F •

KURRAJONG ESTATE - STAGE 5 LOT 507



	LIGHT POLE
	NBN / PIT
	WATER
	SEWER
	ELECTRICITY CABLE / PILLAR

(A) EASEMENT TO DRAIN SEWAGE 3 WIDE, 4 WIDE, 5 WIDE AND VARIABLE WIDTH
 (B) EASEMENT FOR WATER SUPPLY 4 WIDE

NOTE: ANTICIPATED LOT CLASSIFICATION IS E

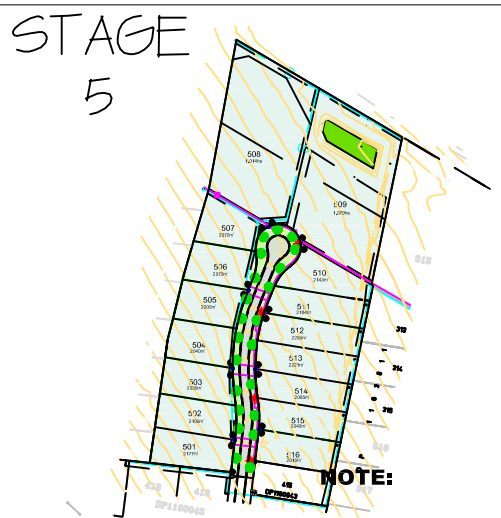

DISCLAIMER/NOTES:

1. Contours are based on finished design levels and are subject to construction and Council certification and therefore should not be considered as final or as-built.
2. Location of utility services including but not limited to power, water, sewer, communications and gas are subject to construction and Supply Authority certification and therefore should not be considered as final or as-built.
3. Survey information such as boundary dimensions and areas, easements etc are subject to final survey. Purchasers should refer to the Deposited Plan and 88B Instrument contained in the Contract for Sale of Land for further detailed information.
4. Bushfire and Geotechnical classification are provided for convenience. Purchasers should refer to referenced detail specialists reports.
5. This Preliminary Site Analysis Plan has been collated from various sources of design information and is provided for convenience to assist Purchasers in obtaining quotations/tenders for dwelling construction.
6. This document does not form part of the Contract of Sale of the Land.

MM HYNDES BAILEY & Co.
 REGISTERED SURVEYORS - TOWN PLANNING - CIVIL DESIGN
Surveying the Hunter since 1920



**KURRAJONG
 FIELDS**
 • S C O N F •

KURRAJONG ESTATE - STAGE 5

LOT 508

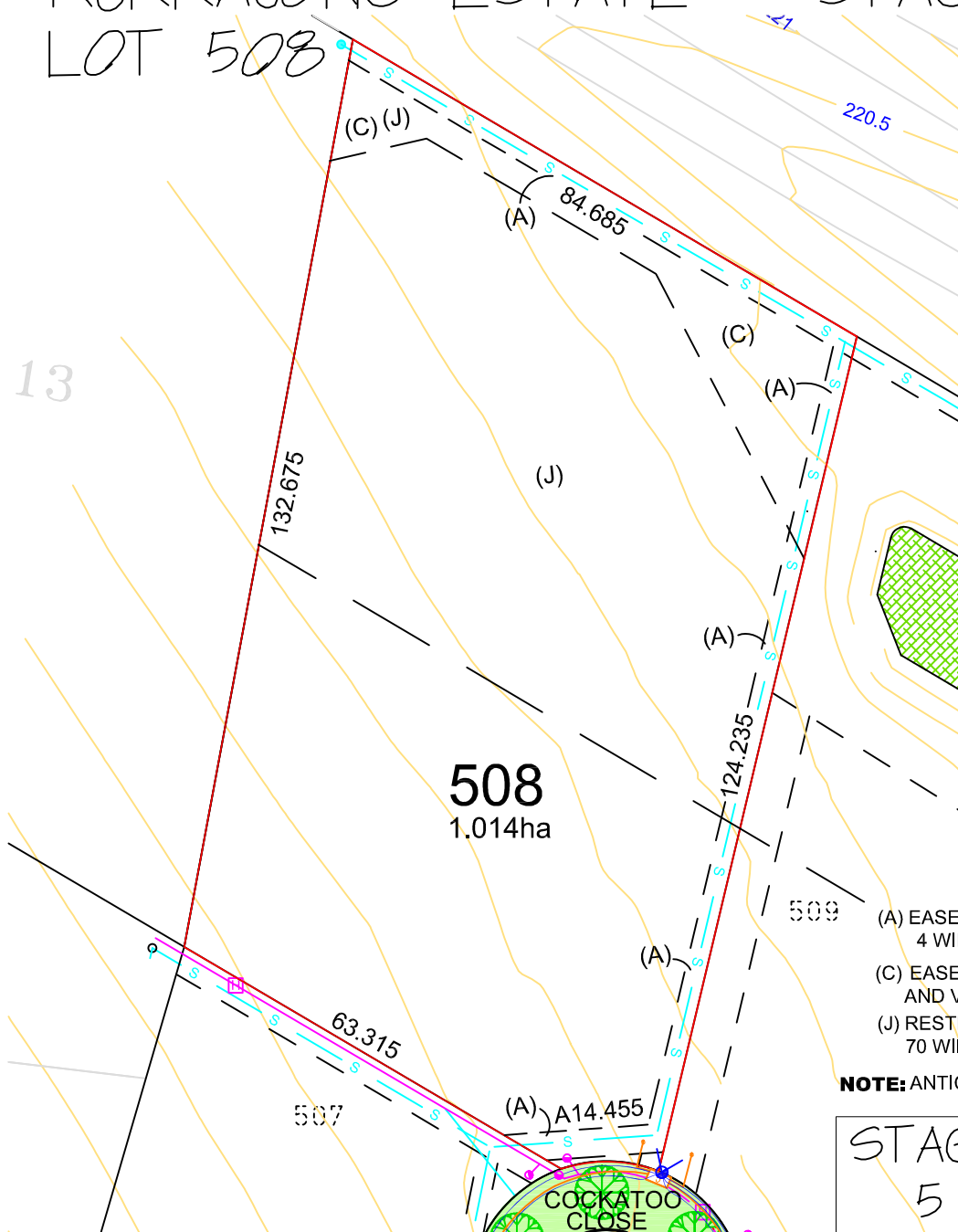
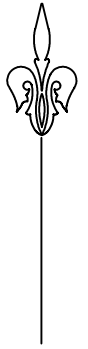

	LIGHT POLE
	NBN / PIT
	WATER
	SEWER
	ELECTRICITY CABLE / PILLAR

- (A) EASEMENT TO DRAIN SEWAGE 3 WIDE, 4 WIDE, 5 WIDE AND VARIABLE WIDTH
- (C) EASEMENT TO DRAIN WATER 7 WIDE AND VARIABLE WIDTH
- (J) RESTRICTION ON THE USE OF LAND 70 WIDE

NOTE: ANTICIPATED LOT CLASSIFICATION IS E

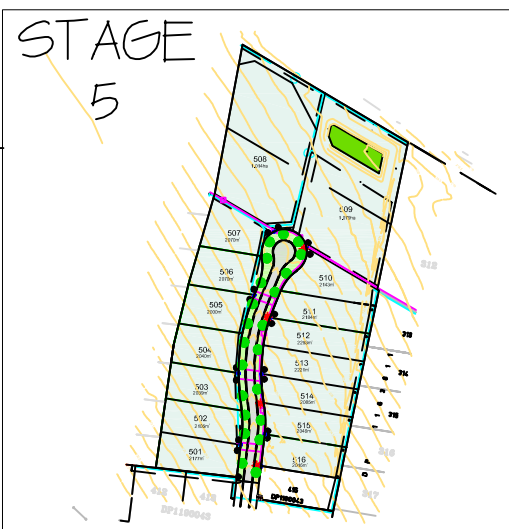

DISCLAIMER/NOTES:

1. Contours are based on finished design levels and are subject to construction and Council certification and therefore should not be considered as final or as-built.
2. Location of utility services including but not limited to power, water, sewer, communications and gas are subject to construction and Supply Authority certification and therefore should not be considered as final or as-built.
3. Survey information such as boundary dimensions and areas, easements etc are subject to final survey. Purchasers should refer to the Deposited Plan and 88B Instrument contained in the Contract for Sale of Land for further detailed information.
4. Bushfire and Geotechnical classification are provided for convenience. Purchasers should refer to referenced detail specialists reports.
5. This Preliminary Site Analysis Plan has been collated from various sources of design information and is provided for convenience to assist Purchasers in obtaining quotations/tenders for dwelling construction.
6. This document does not form part of the Contract of Sale of the Land.

MM HYNDES BAILEY & Co.
 REGISTERED SURVEYORS - TOWN PLANNING - CIVIL DESIGN
Surveying the Hunter since 1920



**KURRAJONG
 FIELDS**
 • S C O N F •

KURRAJONG ESTATE - STAGE 5

LOT 509

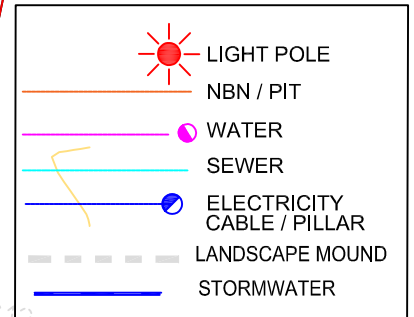
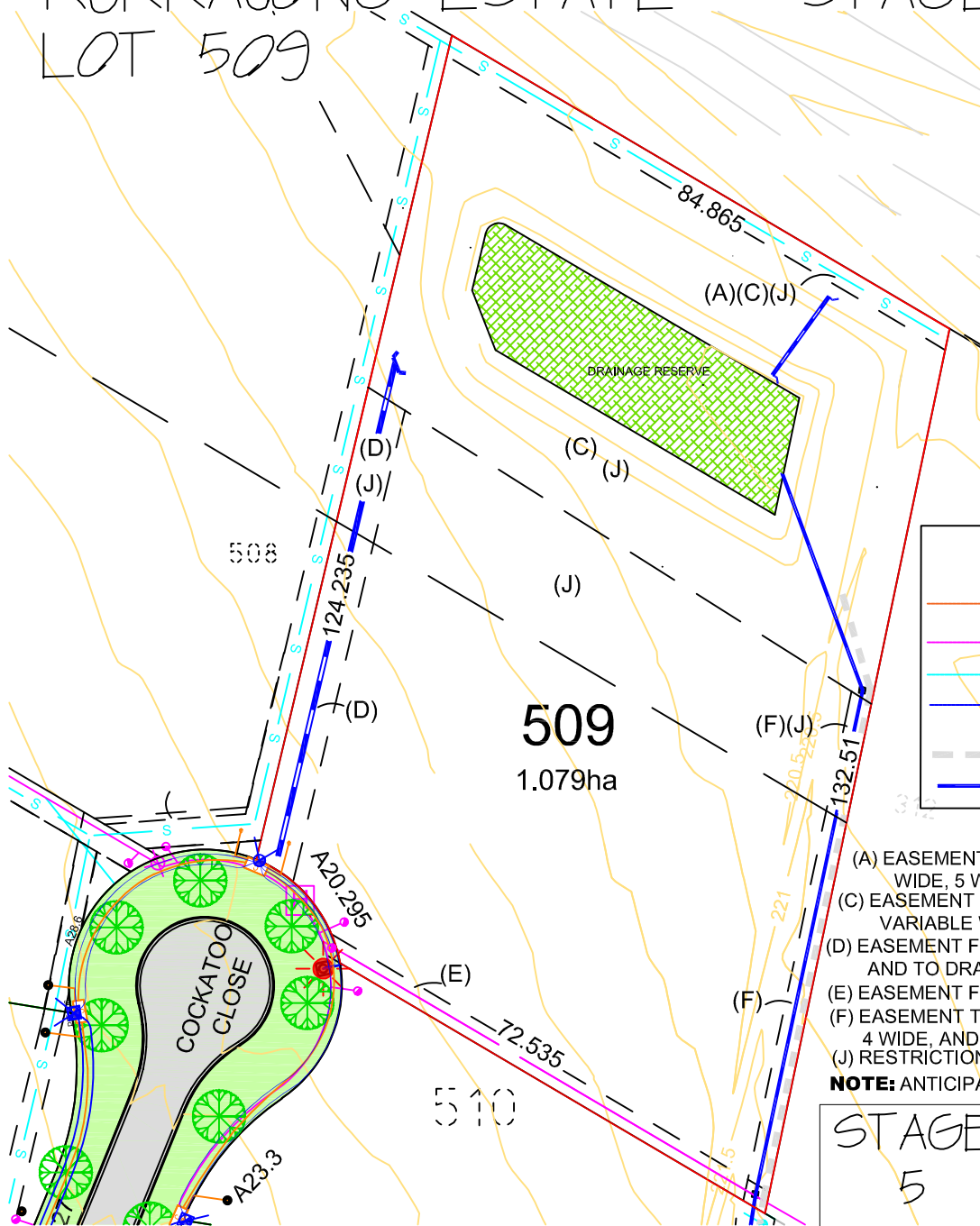
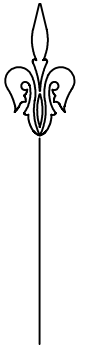

- (A) EASEMENT TO DRAIN SEWAGE 3 WIDE, 4 WIDE, 5 WIDE AND VARIABLE WIDTH
 - (C) EASEMENT TO DRAIN WATER 7 WIDE AND VARIABLE WIDTH
 - (D) EASEMENT FOR ACCESS AND MAINTENANCE AND TO DRAIN WATER 6 WIDE
 - (E) EASEMENT FOR WATER SUPPLY 3 WIDE
 - (F) EASEMENT TO DRAIN WATER 3.5 WIDE, 4 WIDE, AND VARIABLE WIDTH
 - (J) RESTRICTION ON THE USE OF LAND 70 WIDE
- NOTE:** ANTICIPATED LOT CLASSIFICATION IS E

DISCLAIMER/NOTES:

1. Contours are based on finished design levels and are subject to construction and Council certification and therefore should not be considered as final or as-built.
2. Location of utility services including but not limited to power, water, sewer, communications and gas are subject to construction and Supply Authority certification and therefore should not be considered as final or as-built.
3. Survey information such as boundary dimensions and areas, easements etc are subject to final survey. Purchasers should refer to the Deposited Plan and 88B Instrument contained in the Contract for Sale of Land for further detailed information.
4. Bushfire and Geotechnical classification are provided for convenience. Purchasers should refer to referenced detail specialists reports.
5. This Preliminary Site Analysis Plan has been collated from various sources of design information and is provided for convenience to assist Purchasers in obtaining quotations/tenders for dwelling construction.
6. This document does not form part of the Contract of Sale of the Land.

STAGE 5

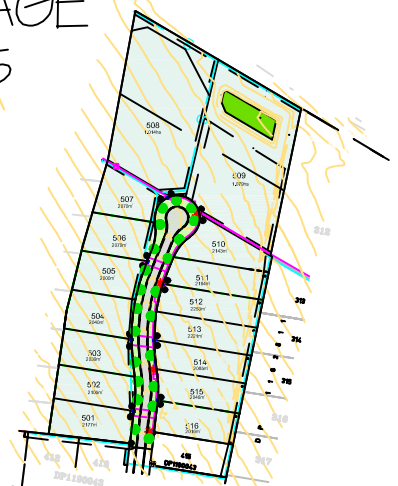

MM HYNDES BAILEY & Co.
 REGISTERED SURVEYORS - TOWN PLANNING - CIVIL DESIGN
Surveying the Hunter since 1920



**KURRAJONG
 FIELDS**
 • S C O N E •

KURRAJONG ESTATE - STAGE 5

LOT 510

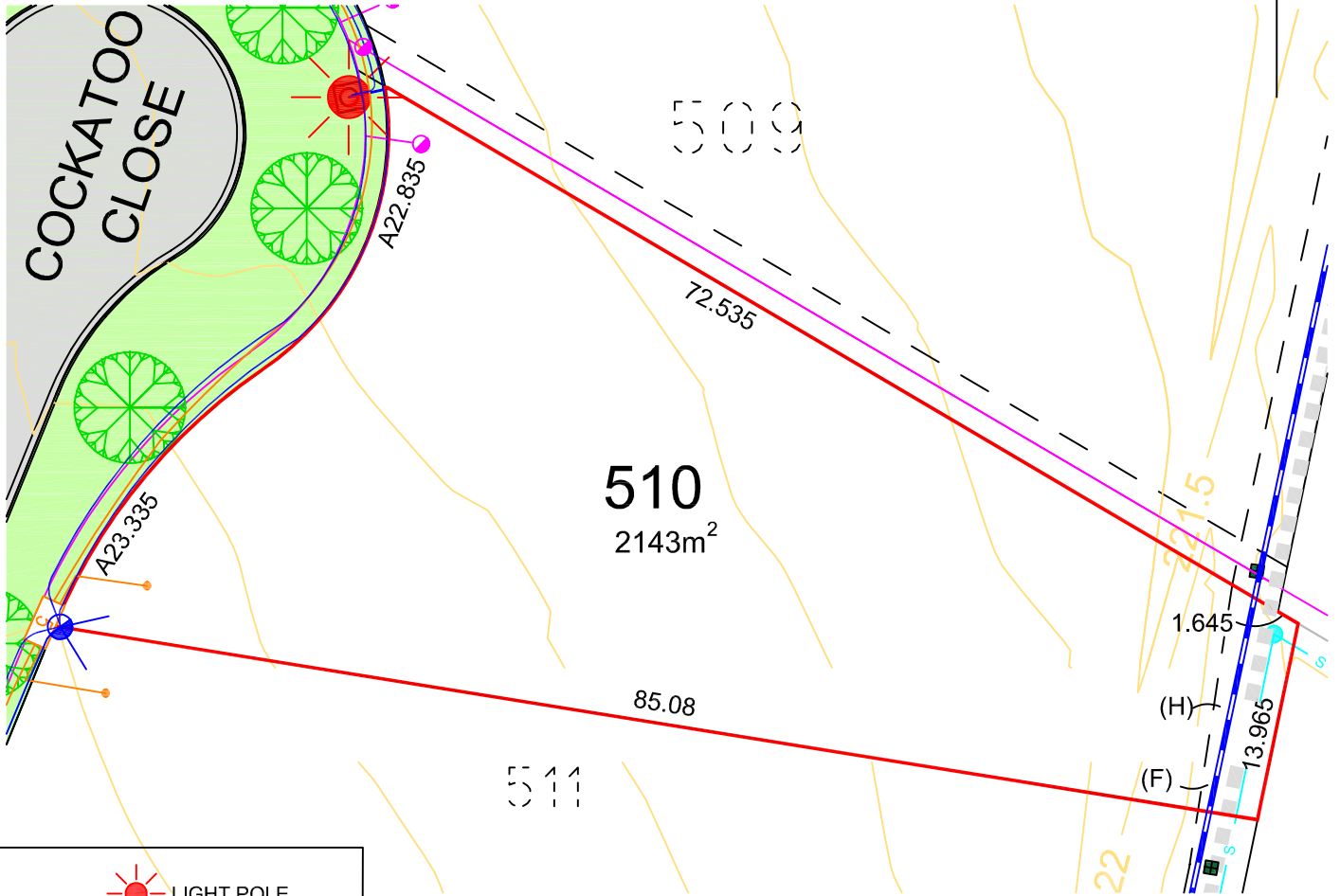

	LIGHT POLE
	NBN / PIT
	WATER
	SEWER
	ELECTRICITY CABLE / PILLAR
	LANDSCAPE MOUND
	STORMWATER

(F) EASEMENT TO DRAIN WATER 3.5 WIDE, 4 WIDE AND VARIABLE WIDTH
 (H) EASEMENT TO DRAIN SEWAGE 3 WIDE, 4 WIDE AND VARIABLE WIDTH (DP1190043)
NOTE: ANTICIPATED LOT CLASSIFICATION IS E

DISCLAIMER/NOTES:

1. Contours are based on finished design levels and are subject to construction and Council certification and therefore should not be considered as final or as-built.
2. Location of utility services including but not limited to power, water, sewer, communications and gas are subject to construction and Supply Authority certification and therefore should not be considered as final or as-built.
3. Survey information such as boundary dimensions and areas, easements etc are subject to final survey. Purchasers should refer to the Deposited Plan and 88B Instrument contained in the Contract for Sale of Land for further detailed information.
4. Bushfire and Geotechnical classification are provided for convenience. Purchasers should refer to referenced detail specialists reports.
5. This Preliminary Site Analysis Plan has been collated from various sources of design information and is provided for convenience to assist Purchasers in obtaining quotations/tenders for dwelling construction.
6. This document does not form part of the Contract of Sale of the Land.

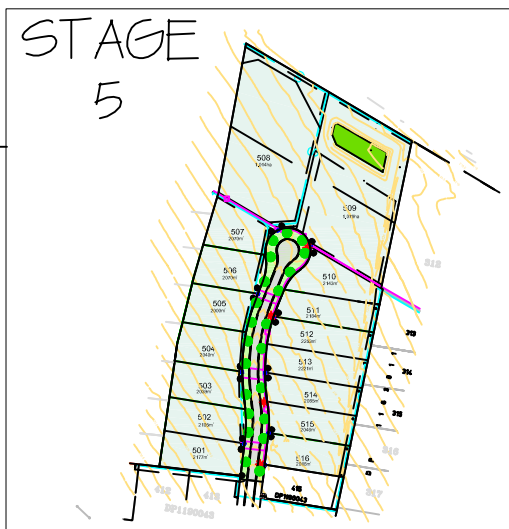

MM HYNDES BAILEY & Co.
 REGISTERED SURVEYORS - TOWN PLANNING - CIVIL DESIGN
Surveying the Hunter since 1920



**KURRAJONG
 FIELDS**
 . S C O N F .

KURRAJONG ESTATE - STAGE 5 LOT 511

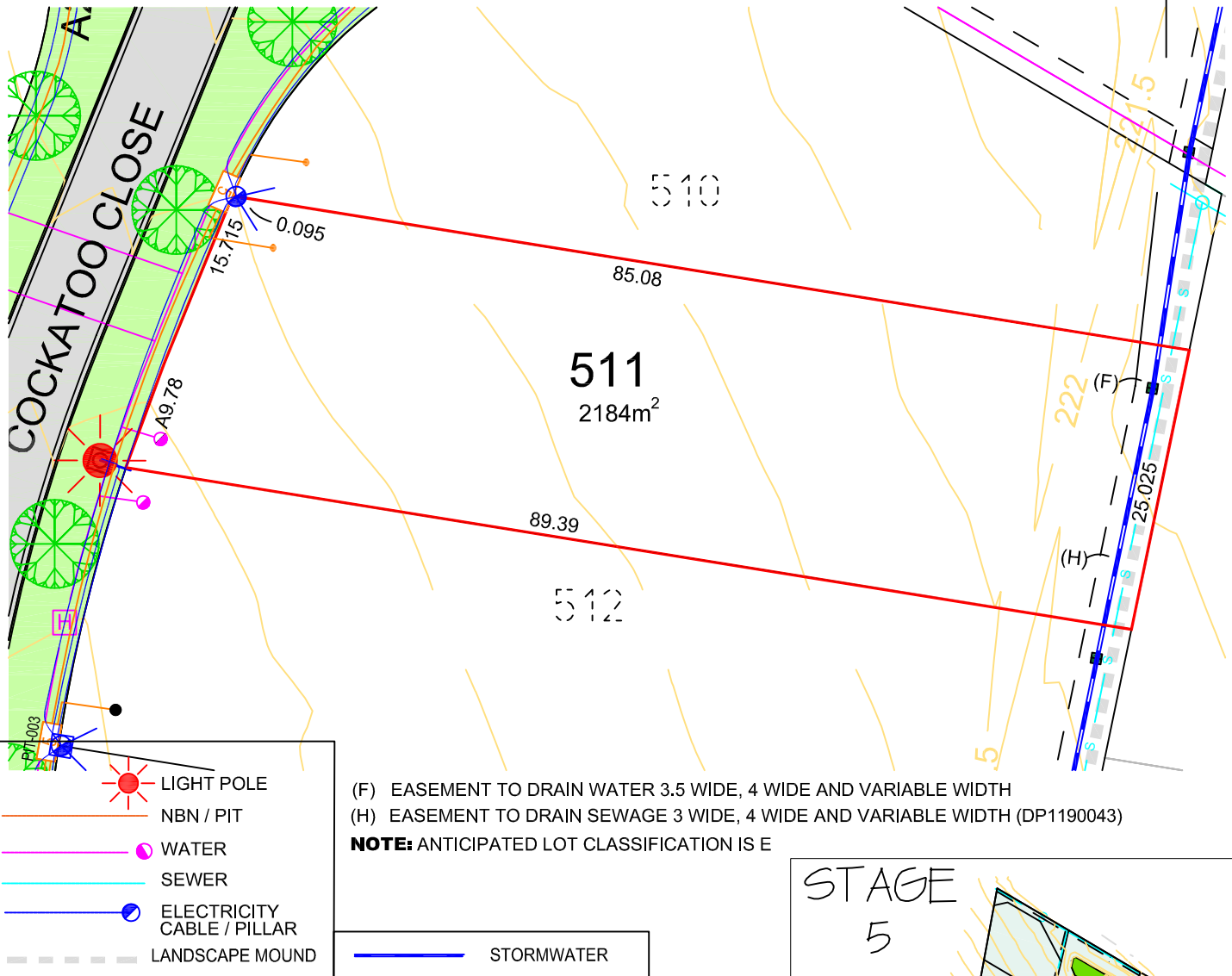

DISCLAIMER/NOTES:

- Contours are based on finished design levels and are subject to construction and Council certification and therefore should not be considered as final or as-built.
- Location of utility services including but not limited to power, water, sewer, communications and gas are subject to construction and Supply Authority certification and therefore should not be considered as final or as-built.
- Survey information such as boundary dimensions and areas, easements etc are subject to final survey. Purchasers should refer to the Deposited Plan and 88B Instrument contained in the Contract for Sale of Land for further detailed information.
- Bushfire and Geotechnical classification are provided for convenience. Purchasers should refer to referenced detail specialists reports.
- This Preliminary Site Analysis Plan has been collated from various sources of design information and is provided for convenience to assist Purchasers in obtaining quotations/tenders for dwelling construction.
- This document does not form part of the Contract of Sale of the Land.

STAGE 5

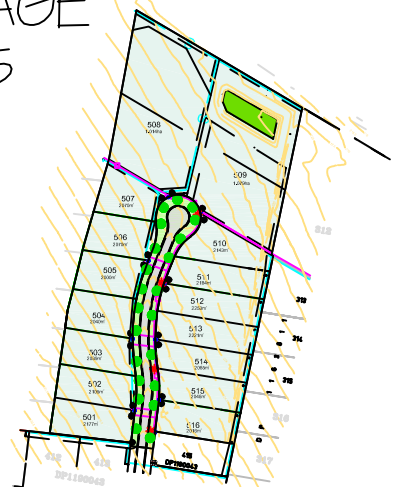

MM HYNDES BAILEY & Co.
REGISTERED SURVEYORS - TOWN PLANNING - CIVIL DESIGN
Surveying the Hunter since 1920



**KURRAJONG
FIELDS**
• S C O N F •

KURRAJONG ESTATE - STAGE 5

LOT 5/2

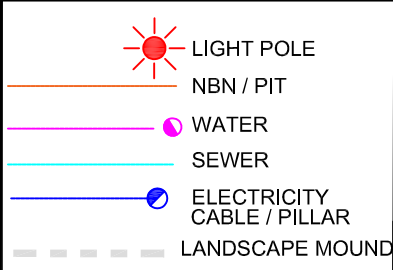
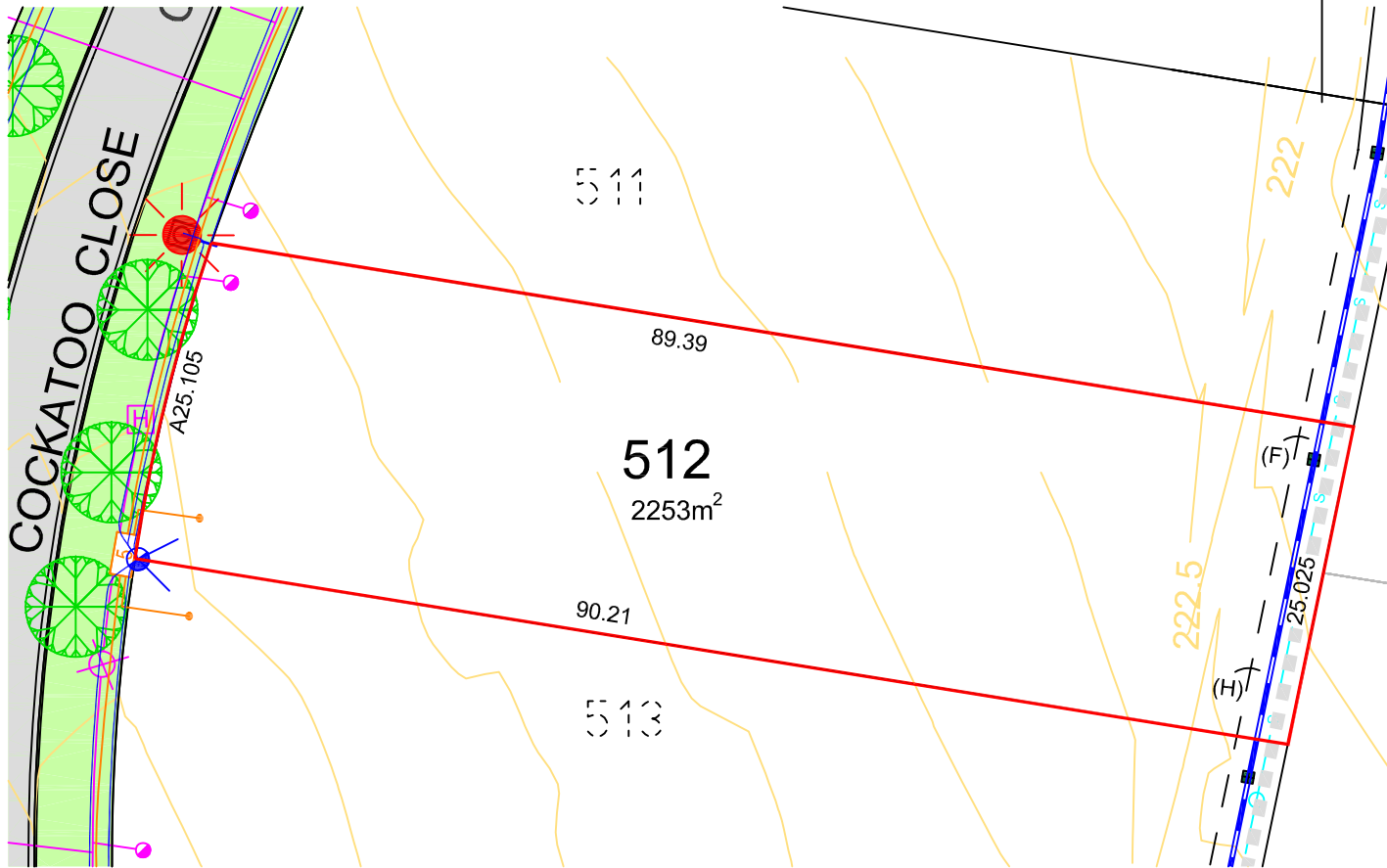

(F) EASEMENT TO DRAIN WATER 3.5 WIDE, 4 WIDE AND VARIABLE WIDTH
 (H) EASEMENT TO DRAIN SEWAGE 3 WIDE, 4 WIDE AND VARIABLE WIDTH (DP1190043)
NOTE: ANTICIPATED LOT CLASSIFICATION IS E

DISCLAIMER/NOTES:

1. Contours are based on finished design levels and are subject to construction and Council certification and therefore should not be considered as final or as-built.
2. Location of utility services including but not limited to power, water, sewer, communications and gas are subject to construction and Supply Authority certification and therefore should not be considered as final or as-built.
3. Survey information such as boundary dimensions and areas, easements etc are subject to final survey. Purchasers should refer to the Deposited Plan and 88B Instrument contained in the Contract for Sale of Land for further detailed information.
4. Bushfire and Geotechnical classification are provided for convenience. Purchasers should refer to referenced detail specialists reports.
5. This Preliminary Site Analysis Plan has been collated from various sources of design information and is provided for convenience to assist Purchasers in obtaining quotations/tenders for dwelling construction.
6. This document does not form part of the Contract of Sale of the Land.

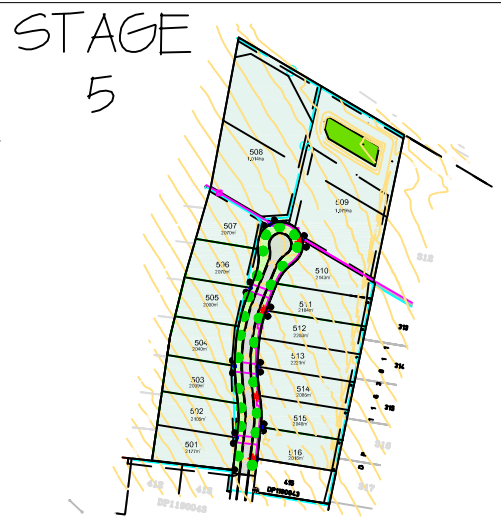

MM HYNDES BAILEY & Co.
 REGISTERED SURVEYORS - TOWN PLANNING - CIVIL DESIGN
Surveying the Hunter since 1920



**KURRAJONG
 FIELDS**
 • S C O N F •

KURRAJONG ESTATE - STAGE 5

LOT 513

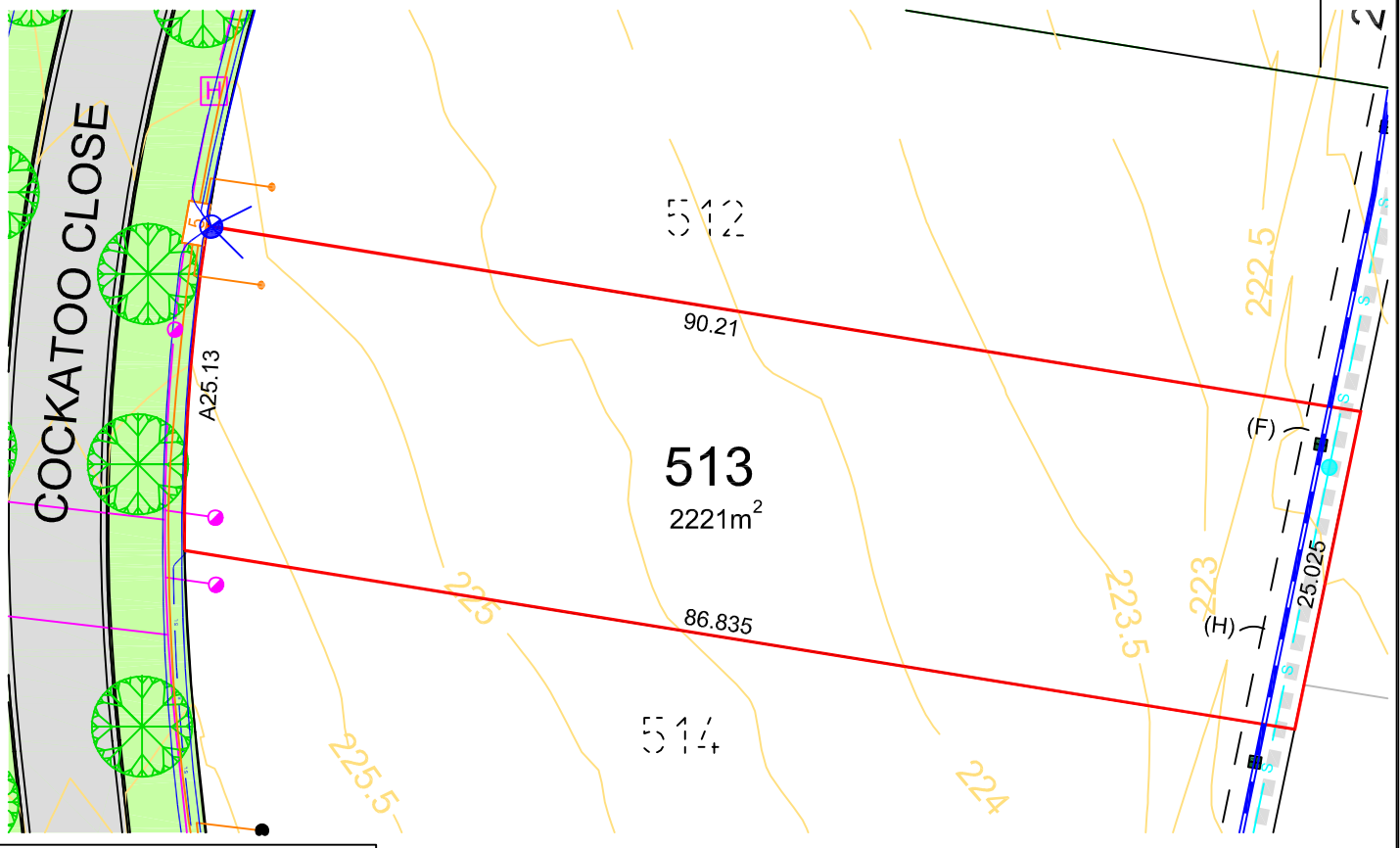

	LIGHT POLE
	NBN / PIT
	WATER
	SEWER
	ELECTRICITY CABLE / PILLAR
	LANDSCAPE MOUND
	STORMWATER

(F) EASEMENT TO DRAIN WATER 3.5 WIDE, 4 WIDE AND VARIABLE WIDTH
 (H) EASEMENT TO DRAIN SEWAGE 3 WIDE, 4 WIDE AND VARIABLE WIDTH (DP1190043)
NOTE: ANTICIPATED LOT CLASSIFICATION IS E

DISCLAIMER/NOTES:

1. Contours are based on finished design levels and are subject to construction and Council certification and therefore should not be considered as final or as-built.
2. Location of utility services including but not limited to power, water, sewer, communications and gas are subject to construction and Supply Authority certification and therefore should not be considered as final or as-built.
3. Survey information such as boundary dimensions and areas, easements etc are subject to final survey. Purchasers should refer to the Deposited Plan and 88B Instrument contained in the Contract for Sale of Land for further detailed information.
4. Bushfire and Geotechnical classification are provided for convenience. Purchasers should refer to referenced detail specialists reports.
5. This Preliminary Site Analysis Plan has been collated from various sources of design information and is provided for convenience to assist Purchasers in obtaining quotations/tenders for dwelling construction.
6. This document does not form part of the Contract of Sale of the Land.

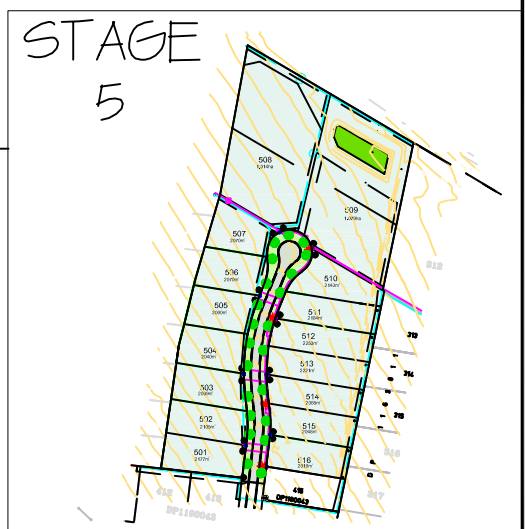

MM HYNDES BAILEY & Co.
 REGISTERED SURVEYORS - TOWN PLANNING - CIVIL DESIGN
Surveying the Hunter since 1920



**KURRAJONG
 FIELDS**
 • S C O N F •

KURRAJONG ESTATE - STAGE 5

LOT 514

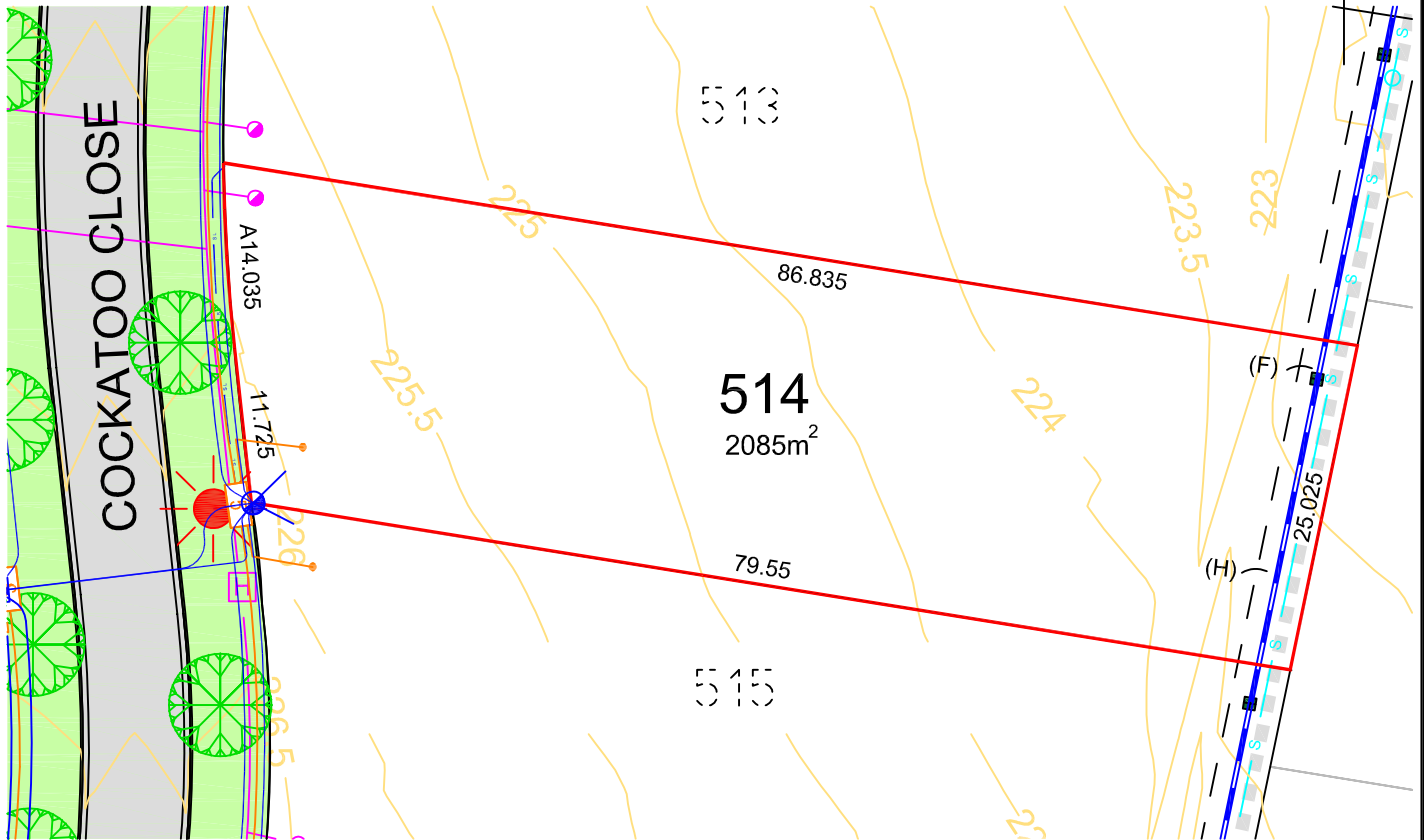

	LIGHT POLE
	NBN / PIT
	WATER
	SEWER
	ELECTRICITY CABLE / PILLAR
	LANDSCAPE MOUND

(F) EASEMENT TO DRAIN WATER 3.5 WIDE, 4 WIDE AND VARIABLE WIDTH
 (H) EASEMENT TO DRAIN SEWAGE 3 WIDE, 4 WIDE AND VARIABLE WIDTH (DP1190043)
NOTE: ANTICIPATED LOT CLASSIFICATION IS E

	STORMWATER
--	------------

DISCLAIMER/NOTES:

1. Contours are based on finished design levels and are subject to construction and Council certification and therefore should not be considered as final or as-built.
2. Location of utility services including but not limited to power, water, sewer, communications and gas are subject to construction and Supply Authority certification and therefore should not be considered as final or as-built.
3. Survey information such as boundary dimensions and areas, easements etc are subject to final survey. Purchasers should refer to the Deposited Plan and 88B Instrument contained in the Contract for Sale of Land for further detailed information.
4. Bushfire and Geotechnical classification are provided for convenience. Purchasers should refer to referenced detail specialists reports.
5. This Preliminary Site Analysis Plan has been collated from various sources of design information and is provided for convenience to assist Purchasers in obtaining quotations/tenders for dwelling construction.
6. This document does not form part of the Contract of Sale of the Land.

STAGE 5

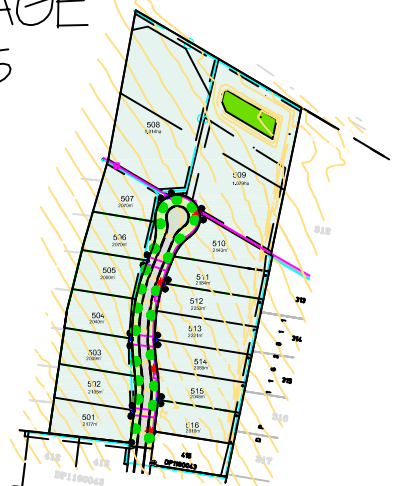

MM HYNDES BAILEY & Co.
 REGISTERED SURVEYORS - TOWN PLANNING - CIVIL DESIGN
Surveying the Hunter since 1920



**KURRAJONG
 FIELDS**
 • S C D M F •

KURRAJONG ESTATE - STAGE 5

LOT 5/5

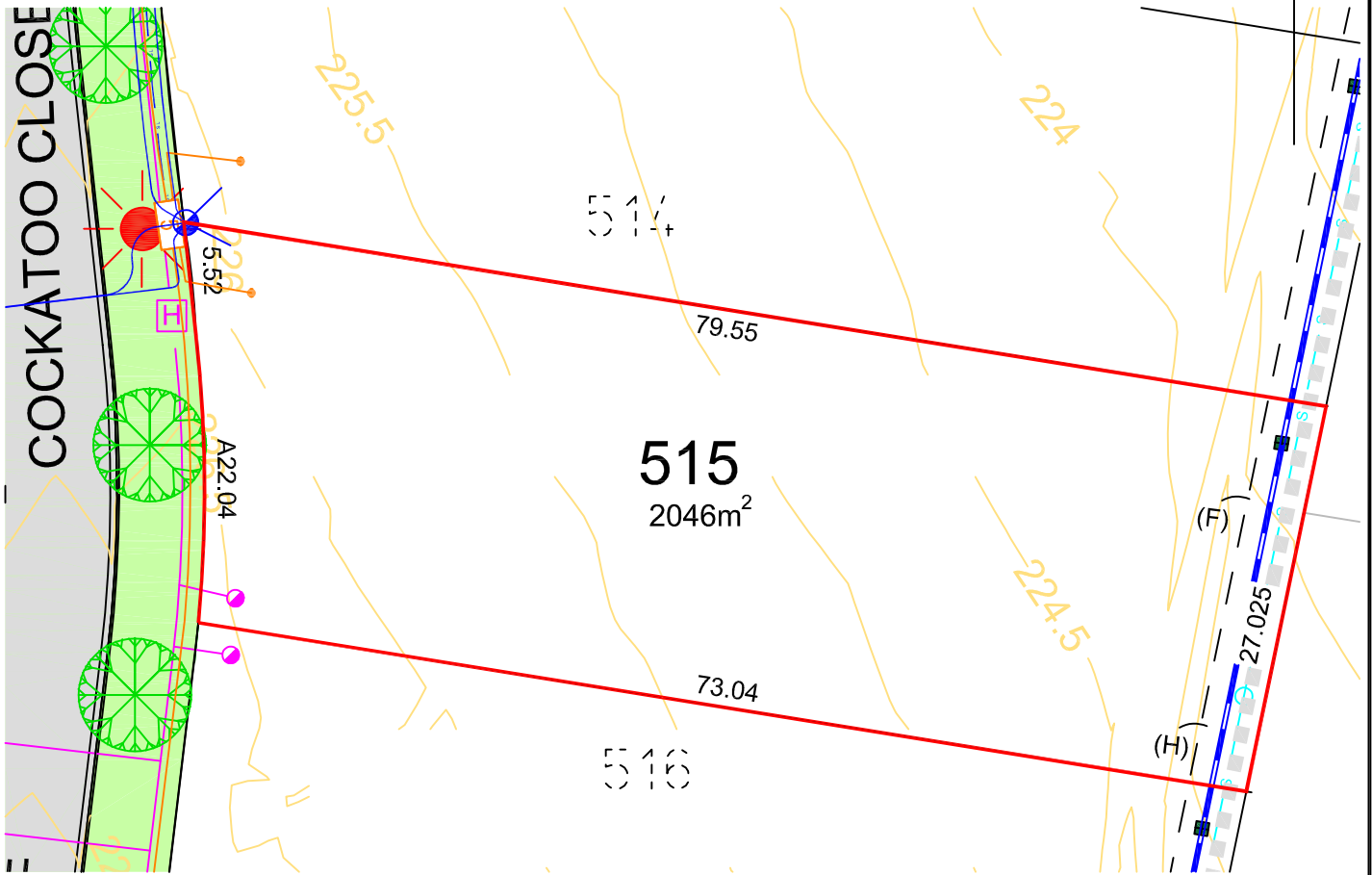

	LIGHT POLE
	NBN / PIT
	WATER
	SEWER
	ELECTRICITY CABLE / PILLAR
	LANDSCAPE MOUND
	STORMWATER

(F) EASEMENT TO DRAIN WATER 3.5 WIDE, 4 WIDE AND VARIABLE WIDTH
 (H) EASEMENT TO DRAIN SEWAGE 3 WIDE, 4 WIDE AND VARIABLE WIDTH (DP1190043)
NOTE: ANTICIPATED LOT CLASSIFICATION IS E

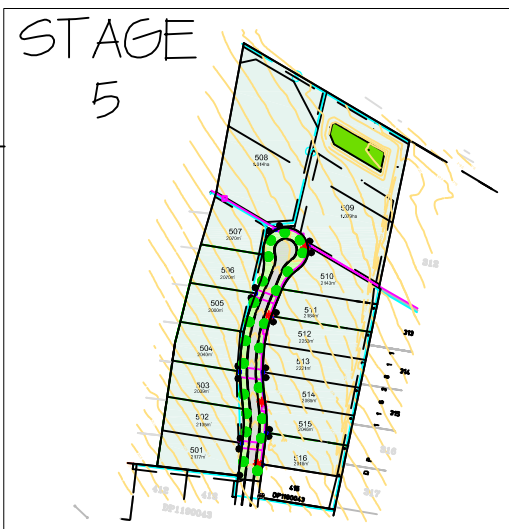

DISCLAIMER/NOTES:

1. Contours are based on finished design levels and are subject to construction and Council certification and therefore should not be considered as final or as-built.
2. Location of utility services including but not limited to power, water, sewer, communications and gas are subject to construction and Supply Authority certification and therefore should not be considered as final or as-built.
3. Survey information such as boundary dimensions and areas, easements etc are subject to final survey. Purchasers should refer to the Deposited Plan and 88B Instrument contained in the Contract for Sale of Land for further detailed information.
4. Bushfire and Geotechnical classification are provided for convenience. Purchasers should refer to referenced detail specialists reports.
5. This Preliminary Site Analysis Plan has been collated from various sources of design information and is provided for convenience to assist Purchasers in obtaining quotations/tenders for dwelling construction.
6. This document does not form part of the Contract of Sale of the Land.

MM HYNDES BAILEY & Co.
 REGISTERED SURVEYORS - TOWN PLANNING - CIVIL DESIGN
Surveying the Hunter since 1920



**KURRAJONG
 FIELDS**
 • S C O N E •

KURRAJONG ESTATE - STAGE 5

LOT 5/6

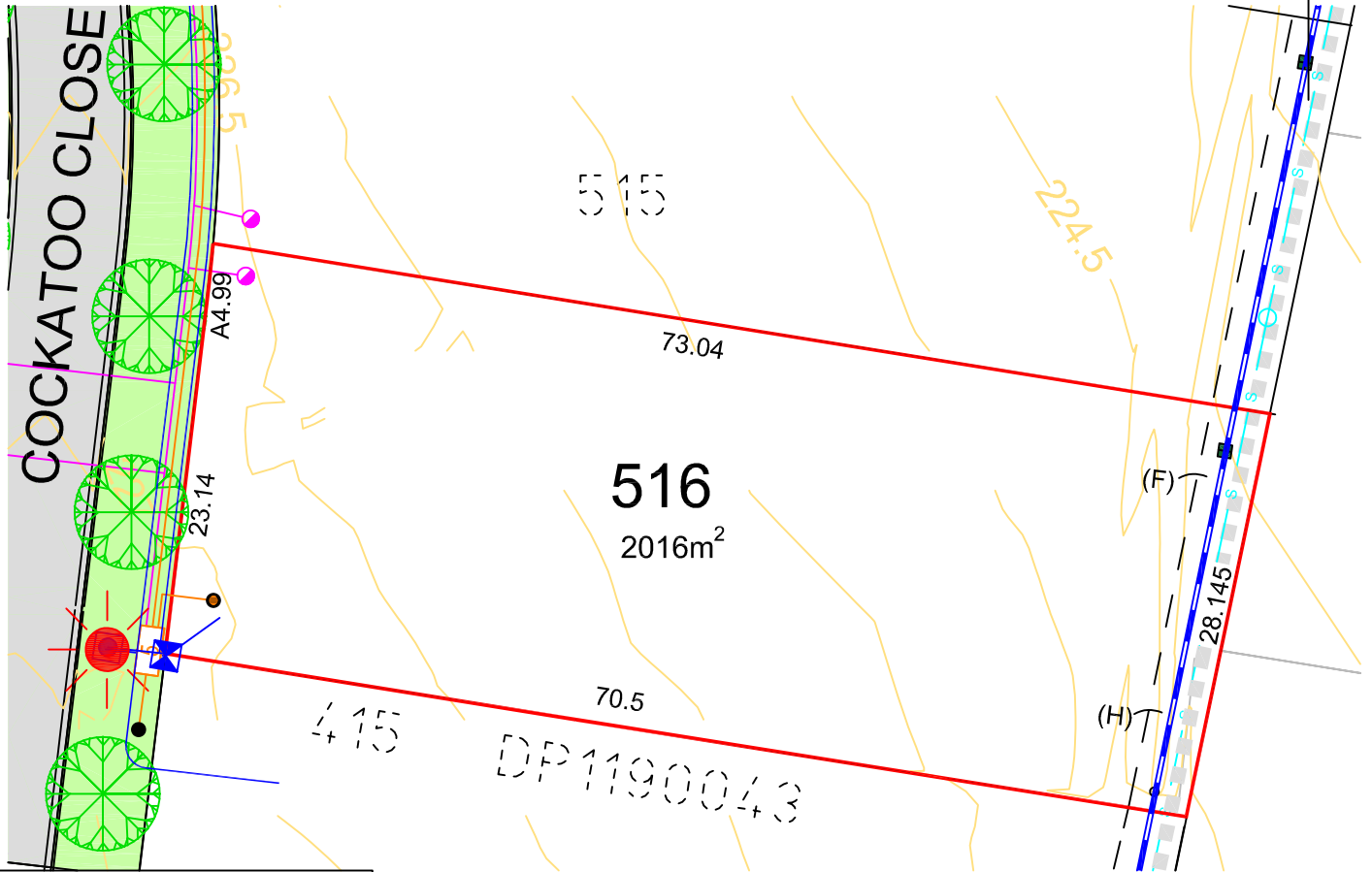

	LIGHT POLE
	NBN / PIT
	WATER
	SEWER
	ELECTRICITY CABLE / PILLAR
	LANDSCAPE MOUND
	STORMWATER

(F) EASEMENT TO DRAIN WATER 3.5 WIDE, 4 WIDE AND VARIABLE WIDTH
 (H) EASEMENT TO DRAIN SEWAGE 3 WIDE, 4 WIDE AND VARIABLE WIDTH (DP1190043)
NOTE: ANTICIPATED LOT CLASSIFICATION IS E

DISCLAIMER/NOTES:

1. Contours are based on finished design levels and are subject to construction and Council certification and therefore should not be considered as final or as-built.
2. Location of utility services including but not limited to power, water, sewer, communications and gas are subject to construction and Supply Authority certification and therefore should not be considered as final or as-built.
3. Survey information such as boundary dimensions and areas, easements etc are subject to final survey. Purchasers should refer to the Deposited Plan and 88B Instrument contained in the Contract for Sale of Land for further detailed information.
4. Bushfire and Geotechnical classification are provided for convenience. Purchasers should refer to referenced detail specialists reports.
5. This Preliminary Site Analysis Plan has been collated from various sources of design information and is provided for convenience to assist Purchasers in obtaining quotations/tenders for dwelling construction.
6. This document does not form part of the Contract of Sale of the Land.

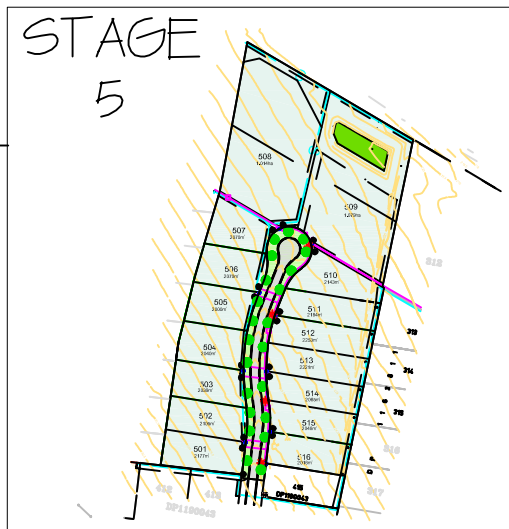

MM HYNDES BAILEY & Co.
 REGISTERED SURVEYORS - TOWN PLANNING - CIVIL DESIGN
Surveying the Hunter since 1920



**KURRAJONG
 FIELDS**
 • S C O N F •